

GUARD RAIL REQUIRED  
ON LEFT

STA E 304+25 TO E 305+85 LENGTH 160 FT  
 - E 306+26 To E 306+92 - 16 -  
 - E 306+51 To E 312+51 - 60 -  
 ON RIGHT  
 STA E 306+26 To E 306+92 - 16 -  
 - E 306+51 - E 312+51 - 60 -  
 TOTAL THIS SHEET 1392 -

| NO. | STATE | PROJ. | SECTION | SHEET | TOTAL SHEETS |
|-----|-------|-------|---------|-------|--------------|
| 3   | VT    | 27    | ROAD 21 | 21    | 75           |

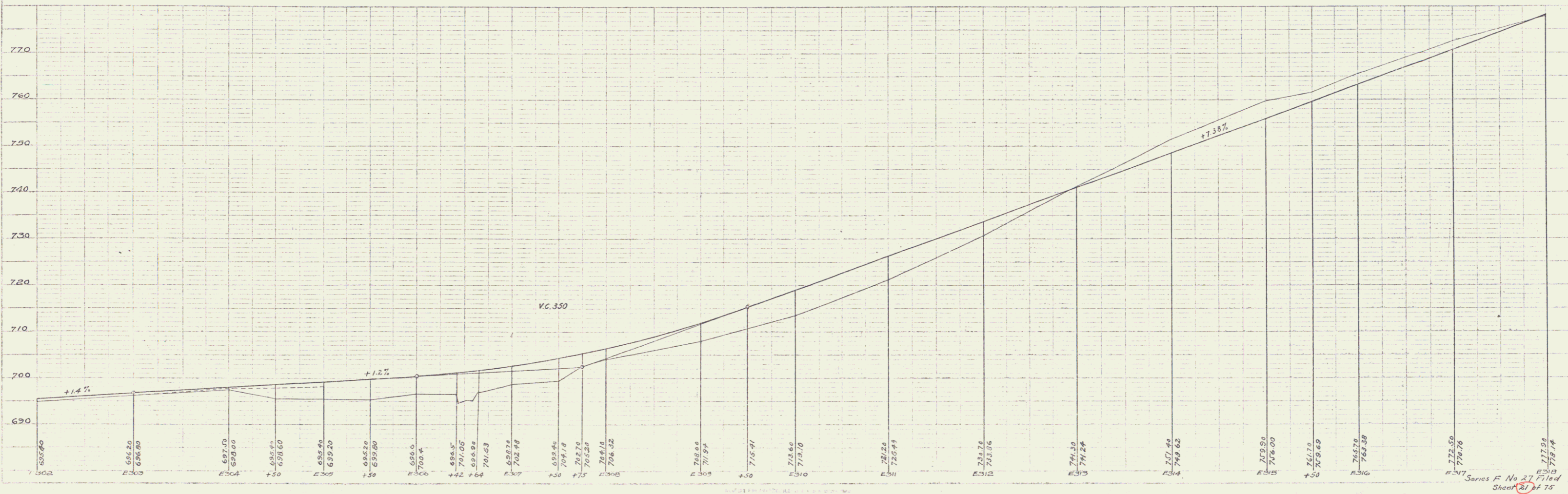
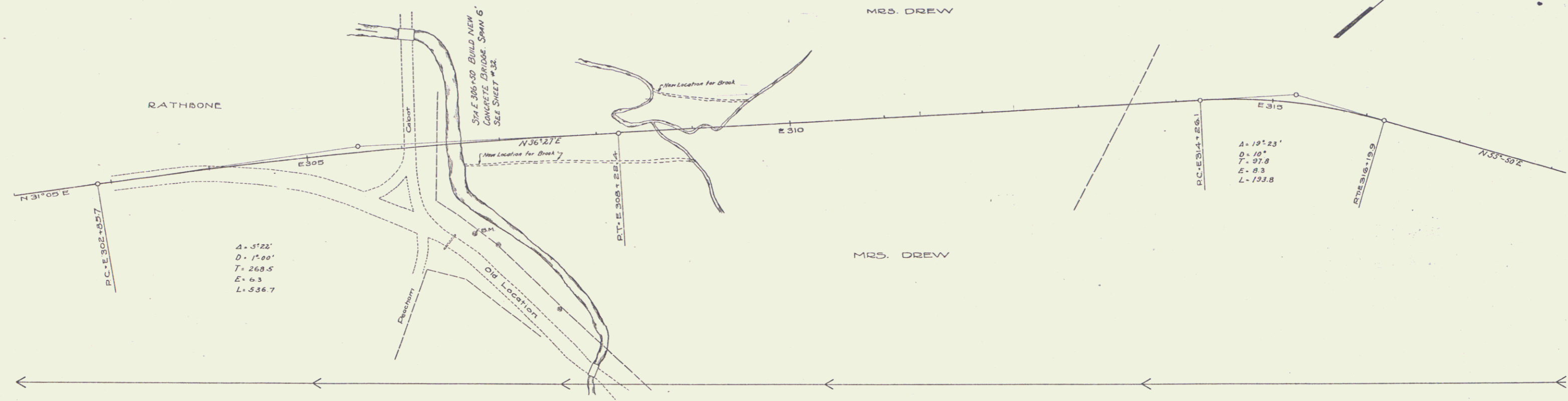

Series E No 27 Filed  
Sheet 21 of 75