

GUARD RAIL REQUIRED ON LEFT

Sta 286+00 to 286+72 Length 72ft
• 287+22 - 287+78 = 56'
• 289+39 - 290+23 = 24'
• 291+26 - 293+26 = 200'
• 296+47 - 298+71 = 24'
• 298+06 - 298+30 = 24'
• 300+22 - 300+46 = 24'
• 301+08 - 301+32 = 24'

GUARD RAIL REQUIRED ON RIGHT

Sta 287+34 to 287+78 Length 44ft
• 289+39 - 290+23 = 24'
• 292+58 - 292+82 = 24'
• 296+47 - 298+71 = 24'
• 298+06 - 298+30 = 24'
• 300+22 - 300+46 = 24'
• 301+08 - 301+32 = 24'

TOTAL THIS SHEET 616ft

CULVERT REPAIRS REQUIRED

Sta 290+11 Drop inlet for 12" Cor I.P.
1-2-4 concrete 1.3 cu yds

RELAYING PIPE CULVERTS

Sta 290+11 12" Cor Iron Pipe 2BR

STONE BASE REQUIRED

Sta 301+00 to 302+00 Length 100ft

NEW CULVERTS REQUIRED

Sta 287+66 16" Cor Iron Pipe 32ft
1-2-4 concrete 1.5 cu yds

Sta 292+70 16" Cor Iron Pipe 30ft
1-2-4 concrete 1.5 cu yds

Sta 298+53 2'x2' Reinforced concrete
1-2-4 concrete 4.1 cu yds
1-3-6 " 6.9 "
Reinforcing steel 64 lbs

Sta 299+18 12" Cor Iron Pipe 32ft
1-2-4 concrete 1.0 cu yds

Sta 300+34 16" Cor Iron Pipe 32ft
1-2-4 concrete 1.5 cu yds

Sta 301+20 12" Cor Iron Pipe 30ft
1-2-4 concrete 1.0 cu yds

REQ. ROAD DIST. NO.	STATE	YEAR	NO. SHEETS	TOTAL SHEETS
5	VT	27	15021	20 75

Woods

Sta 287+66 Replace old 18" Cor I.P. with 16" Cor I.P. Use 18" pipe from Sta 286+49

Sta 292+70 Replace old 18" Cor I.P. by 16" Cor I.P.

Sta 299+18 Replace old 18" Cor I.P. by 12" Cor I.P.

Sta 300+34 Replace old 18" Cor I.P. by 16" Cor I.P.

Sta 301+20 Replace old 18" Cor I.P. by 12" Cor I.P.

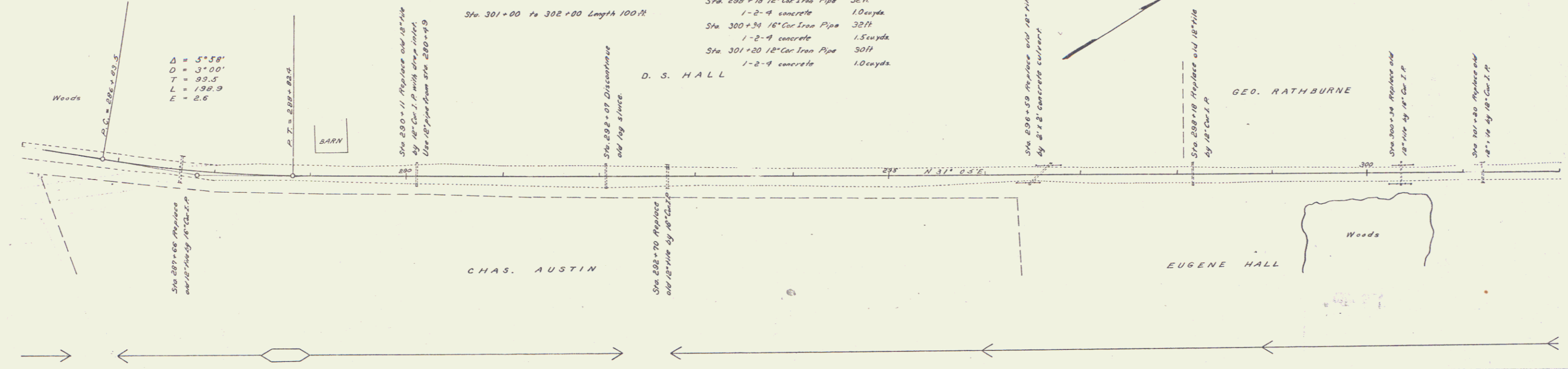

Change of grade at construction 7/20/23

Change of grade at const. 12/22

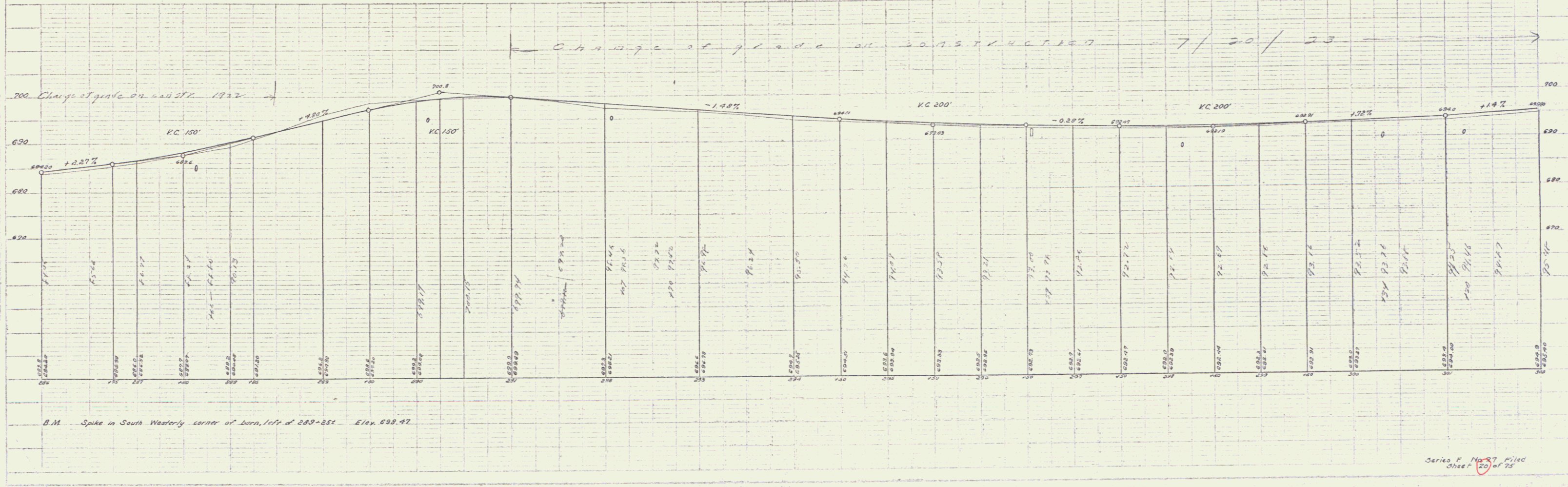

Series F No. 27 filed sheet 20 of 75