

GUARD RAIL REQUIRED
ON LEFT
 Sta 272+50 to 276+50 Length 400ft
 • 280+37 - 280+61 " 24"
 • 283+28 - 286+00 " 272"
ON RIGHT
 Sta 275+46 to 275+70 Length 24ft
 • 280+37 - 280+61 " 24"
 • 285+39 - 285+63 " 24"
TOTAL THIS SHEET 768ft

NEW CULVERTS REQUIRED
 Sta 280+99 16" Cor Iron Pipe 32ft
 1-2-4 concrete 1.5 cu yds
 Sta 285+51 2'x2' Concrete
 1-2-4 concrete 5.5 cu yds
 1-3-6 " 2.3 "

CULVERT REPAIRS REQUIRED
 Sta 275+58 Lengthen 18" Cor I.P. 8ft
 6ft added to one end, 2ft to the other
 1-2-4 concrete 1.5 cu yds.

STONE BASE REQUIRED
 Sta 271+00 to 281+00 Length 1000ft

FED. ROAD DIST. NO.	STATE	PROJECT NO.	SHEET NO.	TOTAL SHEETS
9	VT.	27	182021	19

DATE: 10/1/27
 DRAWN BY: R.E. CHURCHMAN
 CHECKED BY: A.C. LAMBERTON

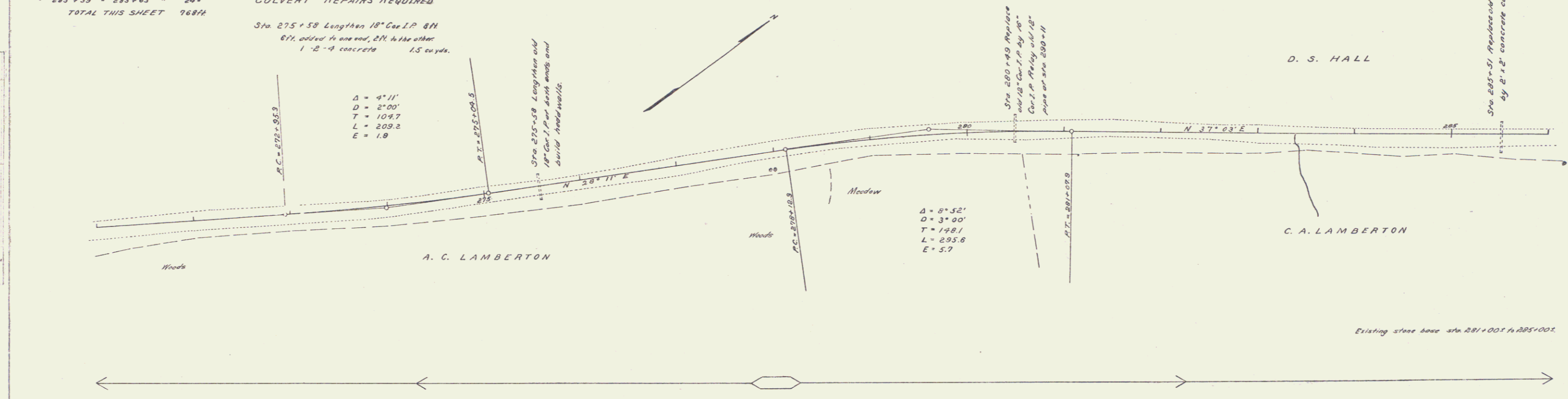

DATE: 10/1/27
 DRAWN BY: R.E. CHURCHMAN
 CHECKED BY: A.C. LAMBERTON

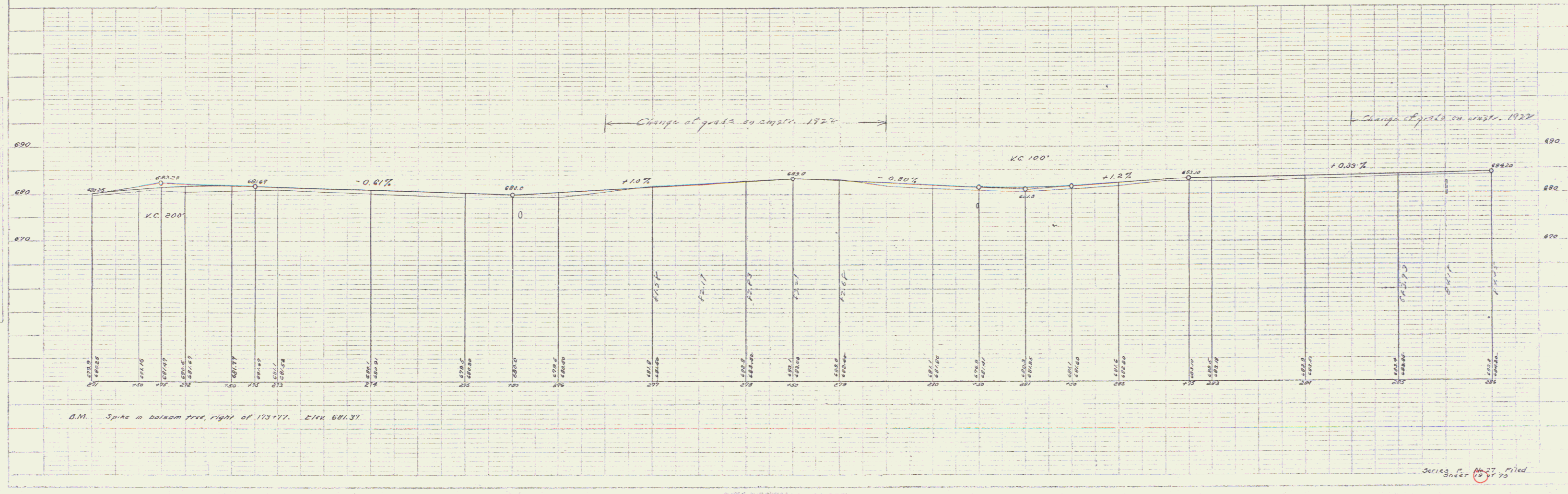

Series 10
 Sheet 182021 of 19