

GUARD RAIL REQUIRED ON LEFT

Sta 232+50 to 232+82 Length 32H
 + 232+86 - 233+02 = 16'
 + 237+31 - 237+55 = 24'
 + 241+45 - 241+69 = 24'

ON RIGHT

Sta 232+50 to 232+82 Length 32H
 + 232+86 - 233+02 = 16'
 + 237+31 - 237+55 = 24'
 + 241+45 - 241+69 = 24'

TOTAL THIS SHEET 192H

CULVERT REPAIRS REQUIRED

Sta 237+43 12" Cor Iron Pipe Repair
 1-2-9 concrete 10 cu yds.

Sta 241+57 Lengthen 18" Cor I.P. 9 ft
 1-2-9 concrete 10 cu yds.

RELAYING PIPE CULVERTS

Sta 237+43 12" Cor Iron Pipe 30ft

| NO. | DATE | BY | REVISION |
|-----|---------|------|----------|
| 1 | 1/27/27 | W.T. | Original |
| 2 | 1/27/27 | W.T. | Revised |
| 3 | 1/27/27 | W.T. | Revised |

DATE: 1/27/27
 DRAWN BY: W.T.
 CHECKED BY: A.P.C.
 PROJECT: R.R. IMPROVEMENTS
 SHEET NO. 16 OF 75

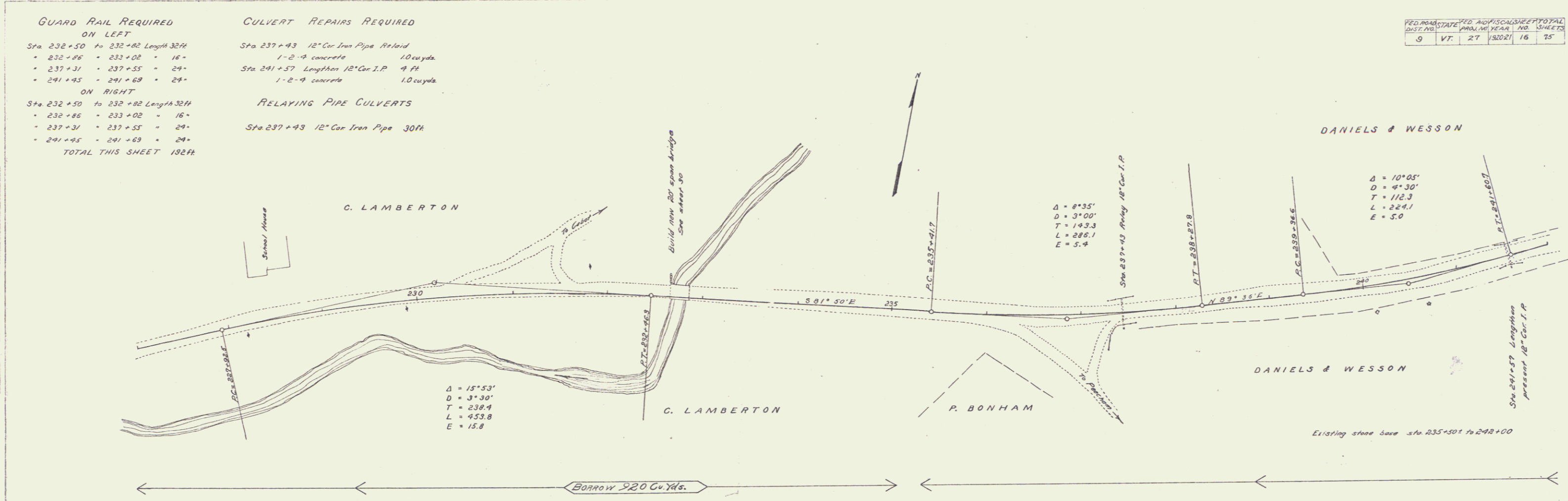

DATE: 1/27/27
 DRAWN BY: W.T.
 CHECKED BY: A.P.C.
 PROJECT: R.R. IMPROVEMENTS
 SHEET NO. 16 OF 75

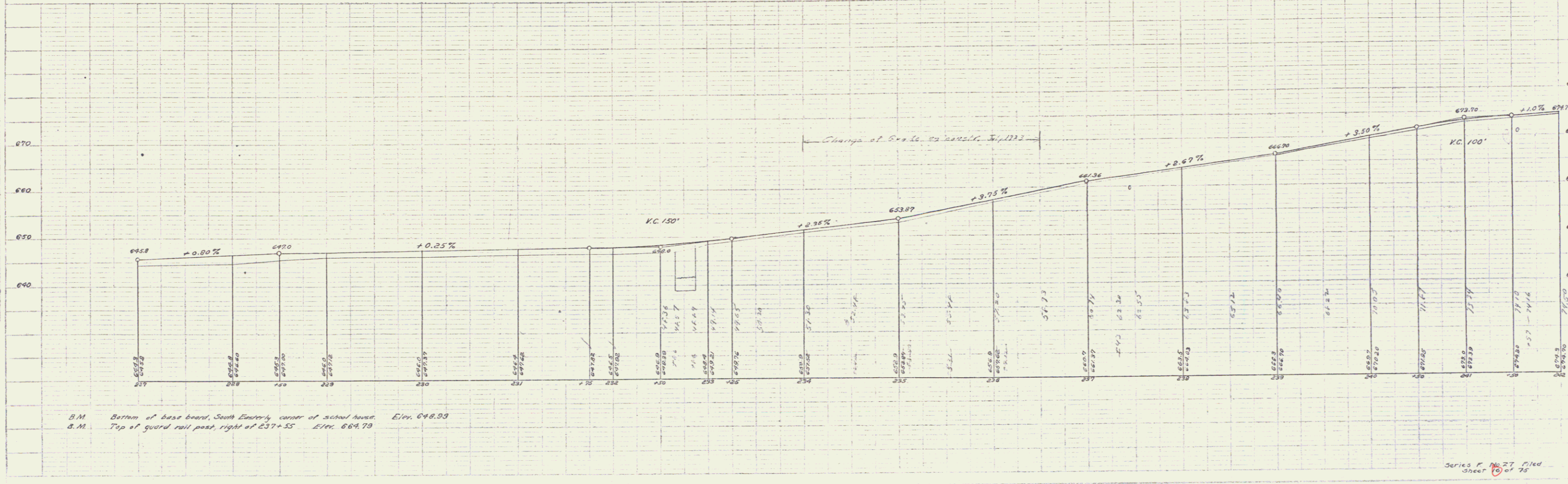

Series P No. 27 Filed 1/27/27