

GUARD RAIL REQUIRED ON LEFT

Sta 120+50 to 120+79 Length 29 ft
 • 127+02 = 127+18 = 16'
 • 127+27 = 127+43 = 16'
 • 129+37 = 130+21 = 24'
 • 133+24 = 133+48 = 24'

ON RIGHT

Sta 120+50 to 120+79 Length 29 ft
 • 127+02 = 127+18 = 16'
 • 127+27 = 127+43 = 16'
 • 129+37 = 130+21 = 24'
 • 132+28 = 135+00 = 272'

TOTAL THIS SHEET 956 ft

NEW CULVERTS REQUIRED

Sta 120+62 12" Cor Iron Pipe 28 ft
 1-2-9 concrete 10 cu yds
 Sta 133+36 16" Cor Iron Pipe 28 ft
 1-2-9 concrete 1.5 cu yds
 Sta 130+09 12" Cor Iron Pipe 28 ft
 1-2-9 concrete 1.3 cu yds

STONE BASE REQUIRED

Sta 127+30 to 135+00 Length 770 ft

DIST. NO.	STATE	FED. AID PROJ. NO.	FISCAL YEAR	SHEET NO.	TOTAL SHEETS
5	Vt.	27	1922	9	75

E. R. MULLER
 A. R. CROFT
 140000

POPPLE
 S. P. MULLER
 A. R. CROFT
 140000

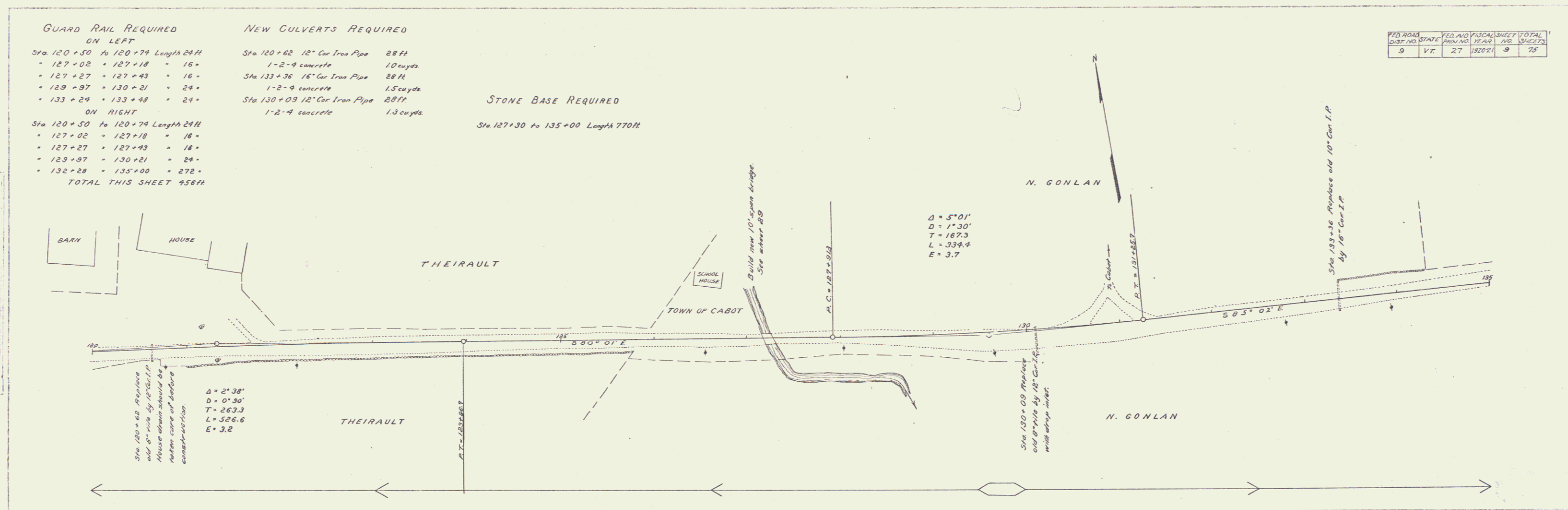

Series F, No. 27 filed
 Sept 10 of 25