

GUARD RAIL REQUIRED	NEW CULVERTS REQUIRED	STONE BASE REQUIRED
ON LEFT Sta 59+00 to 62+20 Length 290ft 63+63 - 63+87 = 24' 65+08 - 66+12 = 24' 70+08 - 71+12 = 24' 73+26 - 73+50 = 24'	Sta 60+62 2' x 2' Concrete 6.2 cu yds 1-2-4 concrete 8.0 Sta 63+73 16" Cor. I.P. 28 ft 1-2-4 concrete 1.0 cu yds Sta 66+00 12" Cor. I.P. 28 ft 1-2-4 concrete 1.0 cu yds Sta 71+00 12" Cor. I.P. 28 ft 1-2-4 concrete 1.0 cu yds Sta 73+38 12" Cor. I.P. 28 ft 1-2-4 concrete 1.0 cu yds	Sta 62+00 to 75+00 Length 1300ft
ON RIGHT Sta 59+00 to 62+12 Length 312ft 63+63 - 63+87 = 24' 65+08 - 67+24 = 136' 68+00 - 71+12 = 232' 73+26 - 73+50 = 24'	TOTAL THIS SHEET 1069ft Sta 60+62 Replace 2' x 2' stone base by 2' x 2' concrete Sta 63+73 Replace old plank culvert by 16" Cor. I.P. Sta 66+00 Replace old plank culvert by 12" Cor. I.P. Sta 68+00 Replace old plank culvert by 12" Cor. I.P. Sta 71+00 Replace old plank and tile culvert	

FED. ROAD DIST. NO.	STATE	FED. AID PROJ. NO.	YEAR	SHEET NO.	TOTAL SHEETS
9	VX	27	1922	5	75

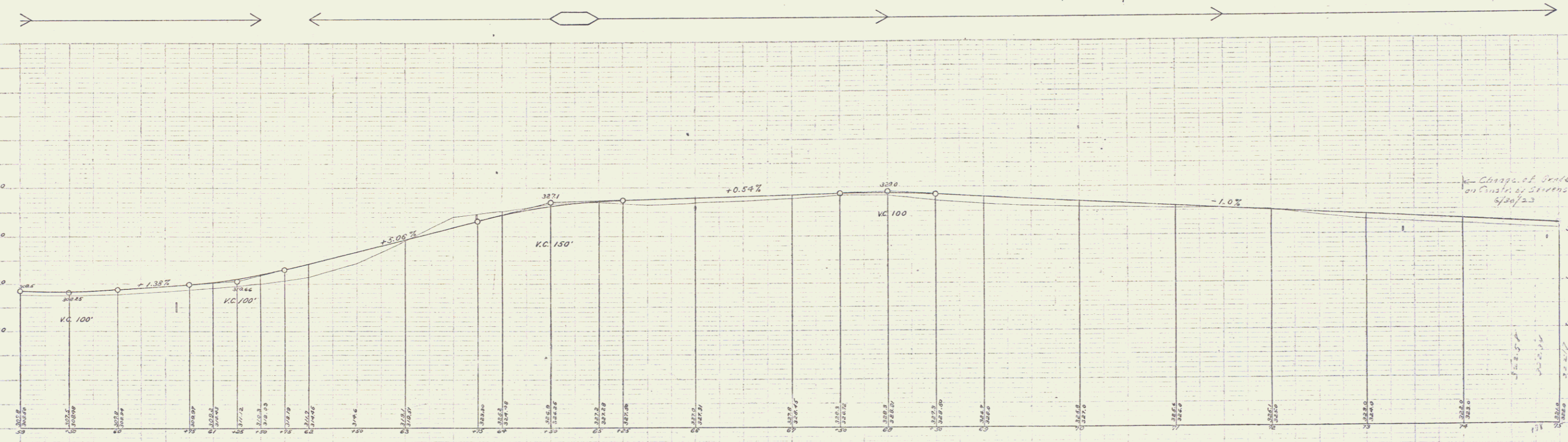
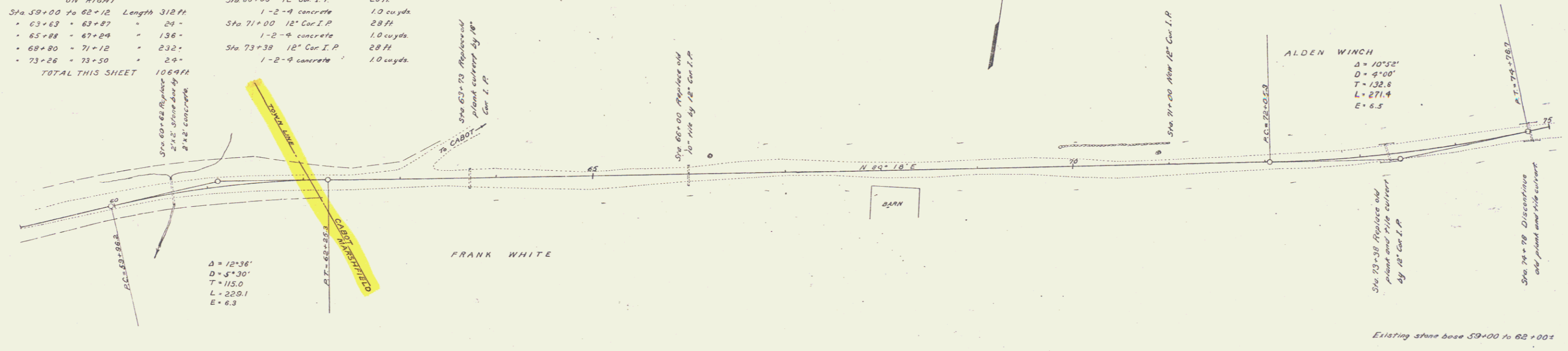

C. W. HENCKS  
 C. F. DODD  
 A. W. CROWN  
 A. E. CHRISTENSEN

C. W. HENCKS  
 A. W. CROWN  
 A. E. CHRISTENSEN

Series F, No. 27  
Sheet 5 of 75