

**WOOD GUARD RAIL REQUIRED**

CULV. STA.	LEFT	RIGHT
401+25	24'	
406+0		24'

**New Rein Concrete Pipe Culverts Required**

Station	Diem	Length	Conc. A	Conc. C	Steel	D/Grate
393+67	18"	60'	2.7cy	1.5cy	17"	1 (12" CONCRETE)
395+27	18"	60'	1.5cy	1.5cy	15"	
401+25	18"	90'	1.5cy	1.5cy	15"	
406+2	18"	90'	1.5cy	1.5cy	15"	

**CONCRETE CURB AND GUTTER REQUIRED**  
 STATIONS LEFT WITH CONC. STEEL  
 392+00-397+25 LI 2'-0" 335cy 345lbs.

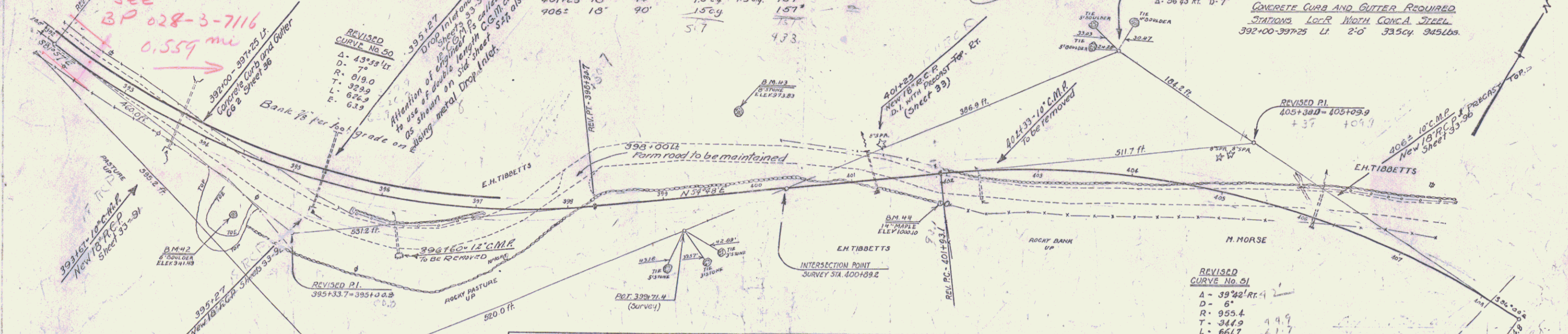

**CABLE GUARD RAIL REQUIRED**

STA - STA	LT	RT	LENGTH CONSTANT	PIV LENGTH
392+25-397+25	LT	RT	80	640'
393+25-397+25	LT	RT	256	296'
400+60-402+80	LT	RT	600	670'
402+80-402+80	RA	RT	70	90'
				1736

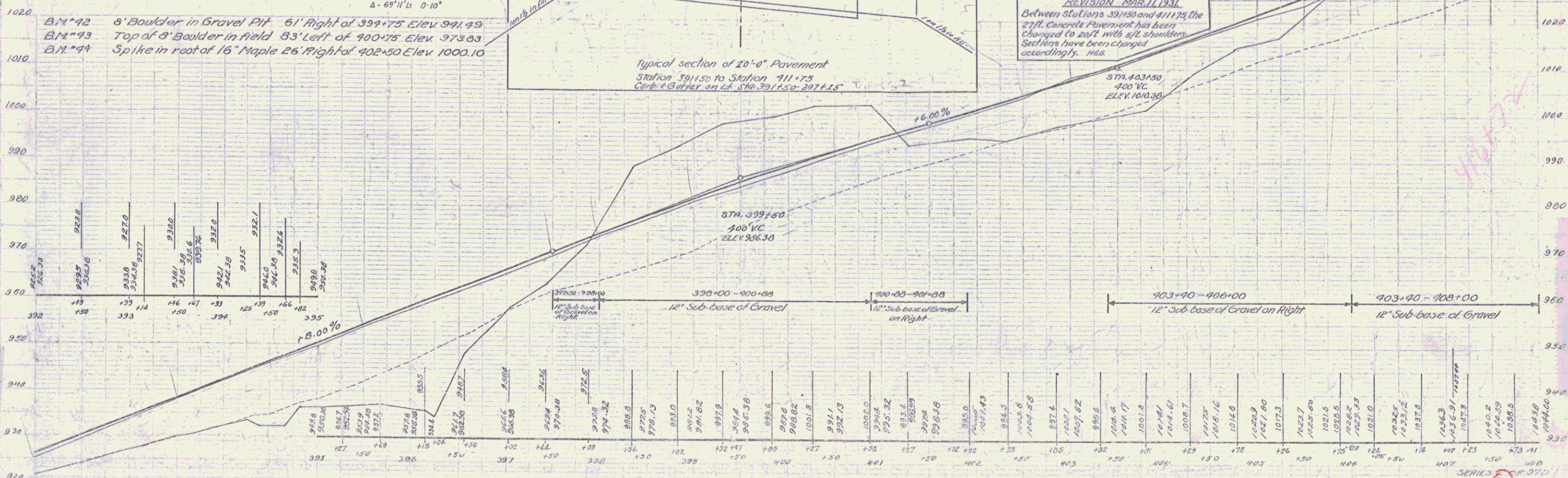
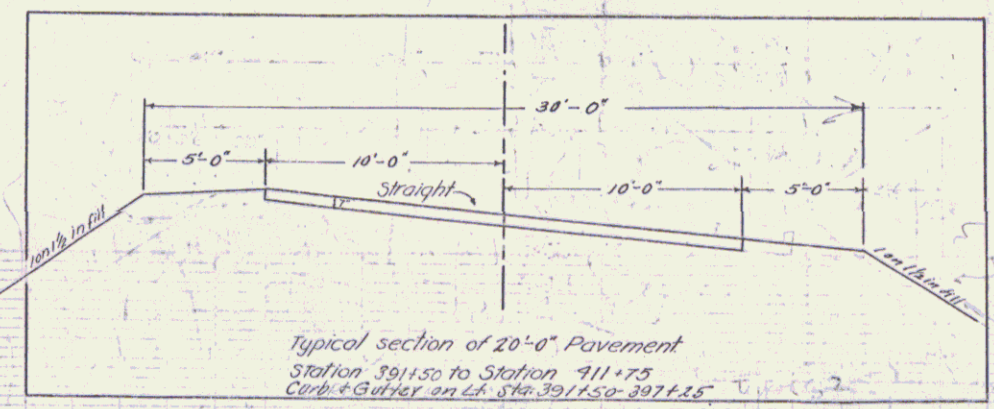

B.M. #42 6' Boulder in Gravel Pit 61' Right of 394+75 Elev 991.49  
 B.M. #43 Top of 8' Boulder in field 83' Left of 400+75 Elev 973.83  
 B.M. #44 Spike in roof of 16" Maple 26' Right of 402+50 Elev 1000.10

**REVISION MAR. 11, 1931**  
 Between Stations 391+50 and 411+75, the 27" Concrete Pavement has been changed to 20" with 6" shoulders. Sections have been changed accordingly. H.S.