

WOOD GUANO CHAIN REQUIRED

STA	LEFT	RIGHT
126+15	24'	24'
129+06	24'	-
129+38	24'	-

CABLE GUANO CHAIN REQUIRED

STA	STA	LO	LO	CONSTANT	PI	LENGTH
119+00	128+10	D	30	80'	584'	
127+97	131+00	E	30	20'	343'	

New Reinf. Concrete Pipe Culverts Required

Station	Length	Diam	Class A	Class C	Steel
120+33	92'	24"	2.9cy		59"
126+15	36'	18"	1.8cy		59"
129+06	40'	15"		30cy	33"

WOOD GUIDE POSTS REQUIRED

Station	Left	Right
130+00	1	-

FD ROAD STATE HIGHWAY 140 100 SHEETS TOTAL
 9 VI. D 1930 12 39

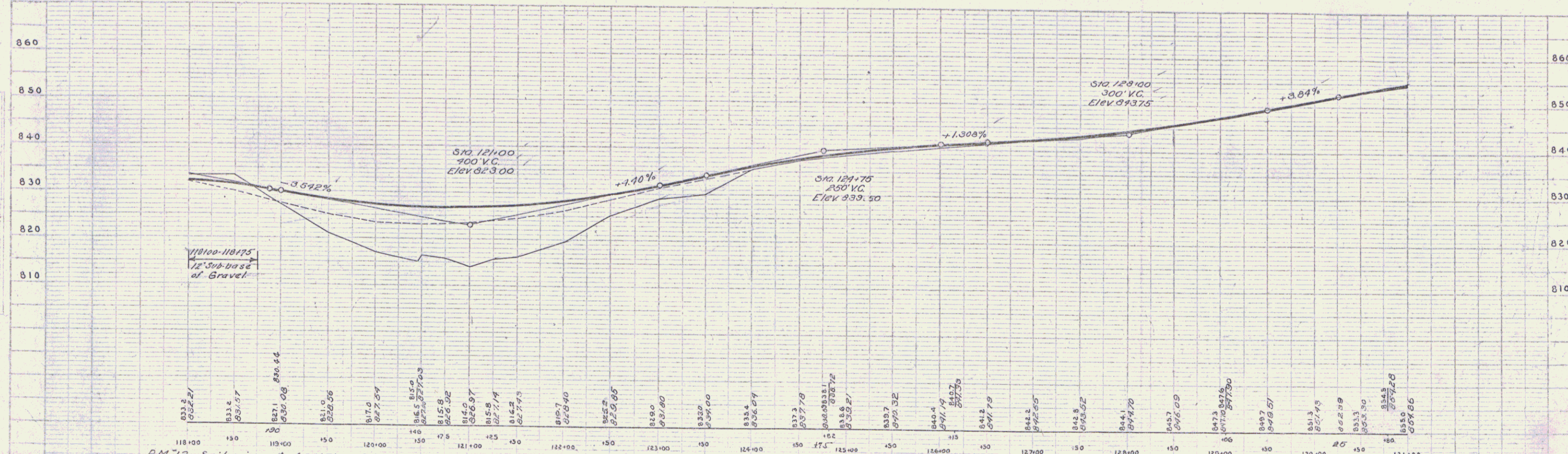
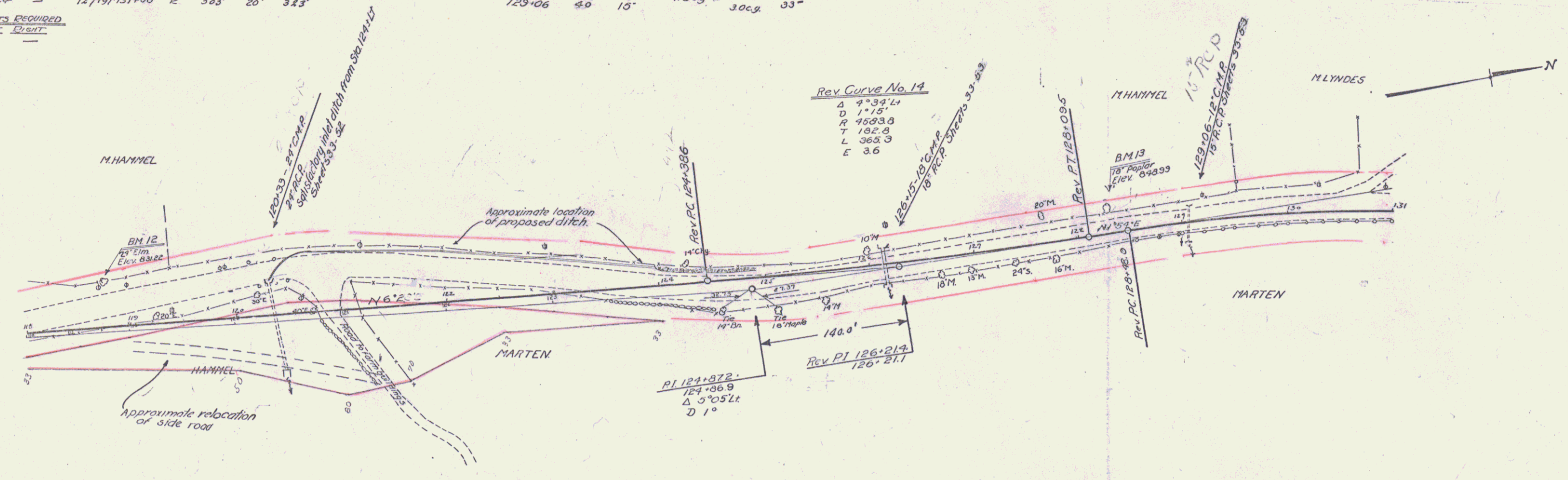

BM 12 Spike in root of 29' Elm 14' left 118+76 Elev. 831.22
 BM 13 Spike in root of 13' Poplar 19' left 128+32 Elev. 843.93

SERIES OF 270
 SHEET 2 OF 39