

WOOD GUARD RAIL REQUIRED

| CULV. STA. | LEFT | RIGHT |
|------------|------|-------|
| 7+73       | 24'  | -     |
| 13+10      | 24'  | -     |

CABLE GUARD RAIL REQUIRED

| STA. | STA. | Lo D | LENGTH | CONSTANT | RAIL LENGTH |
|------|------|------|--------|----------|-------------|
| 6+90 | 7+86 | R    | 36'    | 40'      | 136'        |

REINF. CONC PIPE CULV. Required

| Sta.  | D. in. | Length | Conc. A | Conc. C | Steel |
|-------|--------|--------|---------|---------|-------|
| 7+73  | 36"    | 2.4    | 56      | 31      | 54    |
| 12+25 | 48"    | 1.5    | 56      | 31      | 54    |
| 13+10 | 48"    | 1.5    | 56      | 31      | 54    |
| 12+75 | 48"    | 1.5    | 56      | 31      | 54    |

WOOD GUIDE POSTS REQUIRED

| STATION | LEFT | RIGHT |
|---------|------|-------|
| 12+25   | 1    | -     |
| 12+75   | 1    | -     |

97 D 1930 4 99

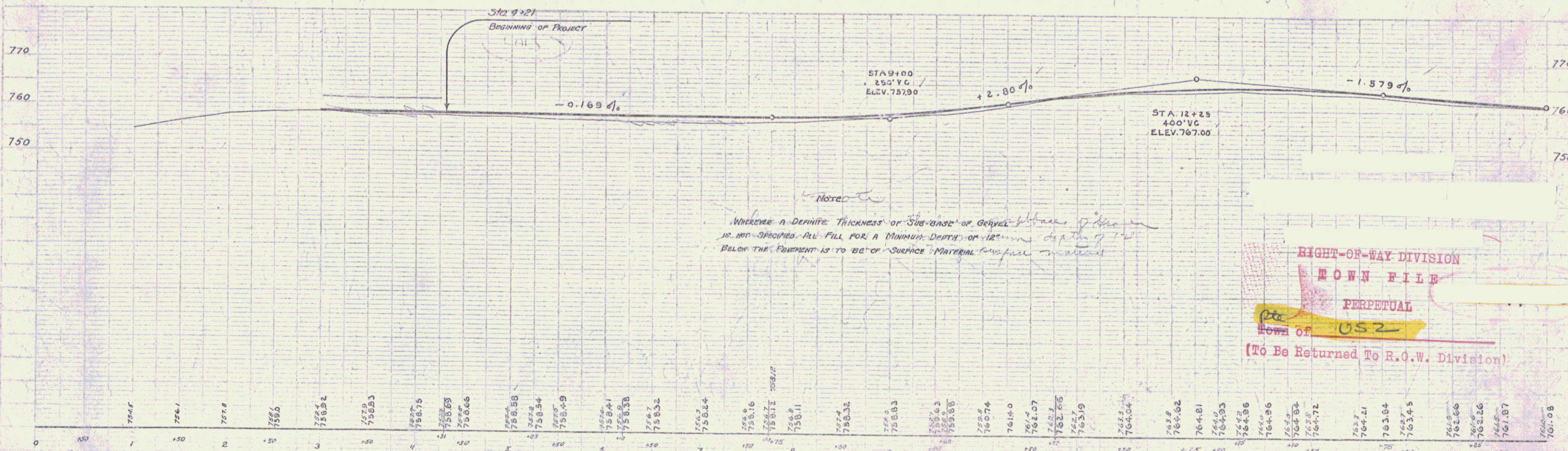
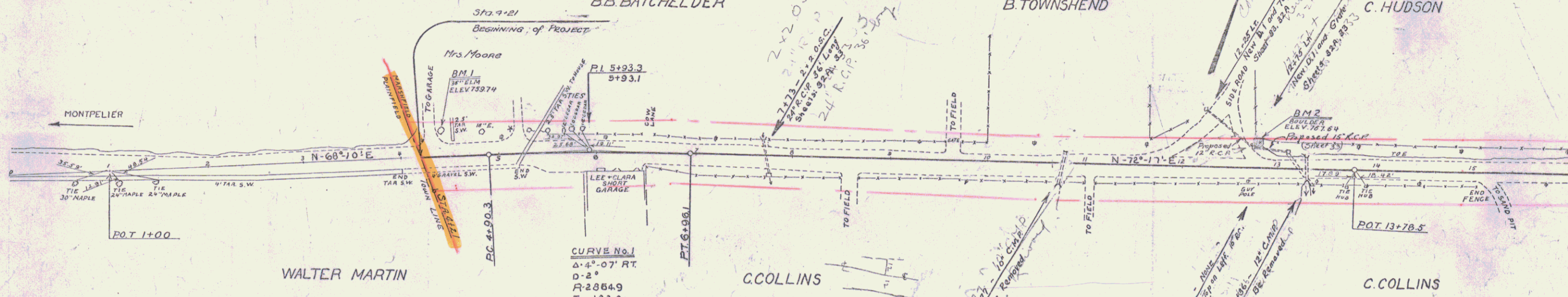

B.M. #1 Spike 36" Elm 235' Lt. 4+91 Elev. 759.74  
 B.M. #2 U.S.I. B.M. Top Boulder at Side Rd. 23.5' Lt. 12+76 Elev. 767.64

RIGHT-OF-WAY DIVISION  
 TOWN FILE  
 PERPETUAL  
 Town of OS2  
 (To Be Returned To R.O.W. Division)

STEARNS R. JENKINS

OS2