

**CABLE GUARD RAIL REQUIRED**

STA	LENGTH	LINEAR FEET
64+00 - 64+40	40	40
68+06 - 68+58	52	52
76+44 - 76+60	16	16

**WOOD GUARD RAIL REQUIRED**

STA	LEFT	RIGHT
76+55 - 76+70	15	15
64+06 - 64+40	34	34
68+06 - 68+58	52	52
76+44 - 76+60	16	16

**CONCRETE CLASS A (1-2-4) 25.0 cu yds. REINFORCING STEEL 2105.0 LBS.**

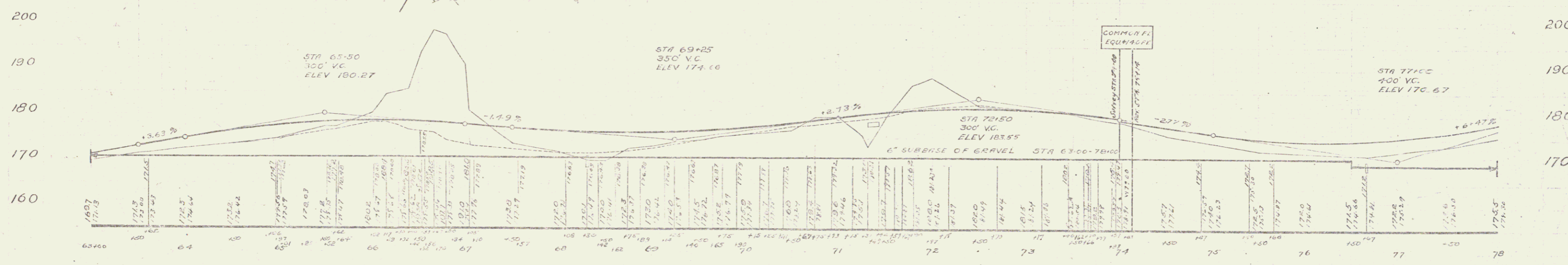
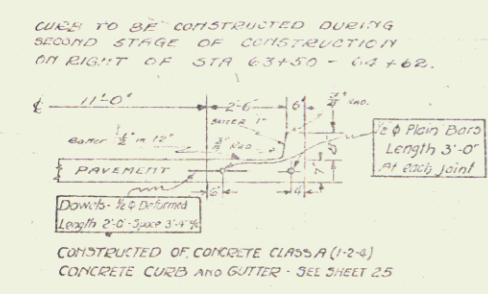

B.M. #6 PAINT SPOT ON CONCRETE STEP RIGHT OF STA 64+00.1 ELEV 178.44  
 B.M. #7 SPIKE IN ROOT OF 6" YELLOW BIRCH RIGHT OF STA 70+100.1 ELEV 177.36

*Void*