

FED. ROAD DIST. NO.	STATE	FED. AID PROJ. NO.	FISCAL YEAR	SHEET NO.	TOTAL SHEETS
9	VT	FR 78	1926	1	77

INDEX OF SHEETS

SHEET NO.	TITLE PAGE
1	263 TYPICAL CROSS-SECTION OF IMPROVEMENT
4	PLAN AND PROFILE STA. 22400 TO 33100
5	33100 - 46100
6	46100 - 63100
7	63100 - 76100
8	76100 - 90100
9	90100 - 105100
10	105100 - 121100
11	121100 - 136100
12	136100 - 149100
13	149100 - 163100
14	163100 - 179100
15	179100 - 195100
16	195100 - 208100
17	208100 - 216100
18	216100 - 233100
19	233100 - 246100
20	246100 - 259100
20A	PIPE CULVERTS 520
21	GUARD RAIL 522
22	DETAIL SHEET (conc. rail, timber grillage, conc. curb & gutter)

20A PIPE CULVERTS 520 } STANDARD STRUCTURE SHEETS
 21 GUARD RAIL 522 }
 22 DETAIL SHEET (conc. rail, timber grillage, conc. curb & gutter)
 22 CROSS SECTIONS

STATE OF VERMONT
 STATE HIGHWAY DEPARTMENT

PLAN AND PROFILE OF PROPOSED
 STATE HIGHWAY
 FLOOD RELIEF PROJECT

TOWNS OF BERLIN-BARRE-EAST MONTPELIER

MONTPELIER-ST. JOHNSBURY ROAD

Pin # 99R116

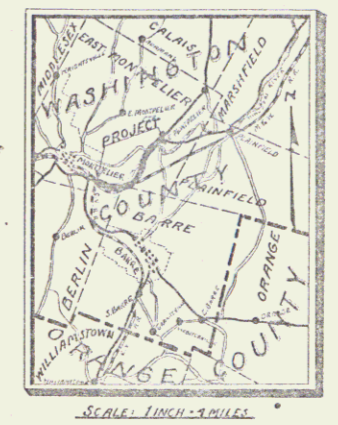

FROM THE END OF PROJECT 97 B EASTERLY 4.399 MILES
 TO ITS INTERSECTION WITH THE EAST MONTPELIER-HARDWICK ROAD

LENGTH OF PROJECT 232300 FT. = 4399 MILES

RIGHT-OF-WAY DIVISION
 TOWN FILE
 PERPETUAL
 Town of US2
 (To Be Returned To R.O.W. Division)

See F028-3(1)
 East Mont F025-3(2) 0.00-1.51

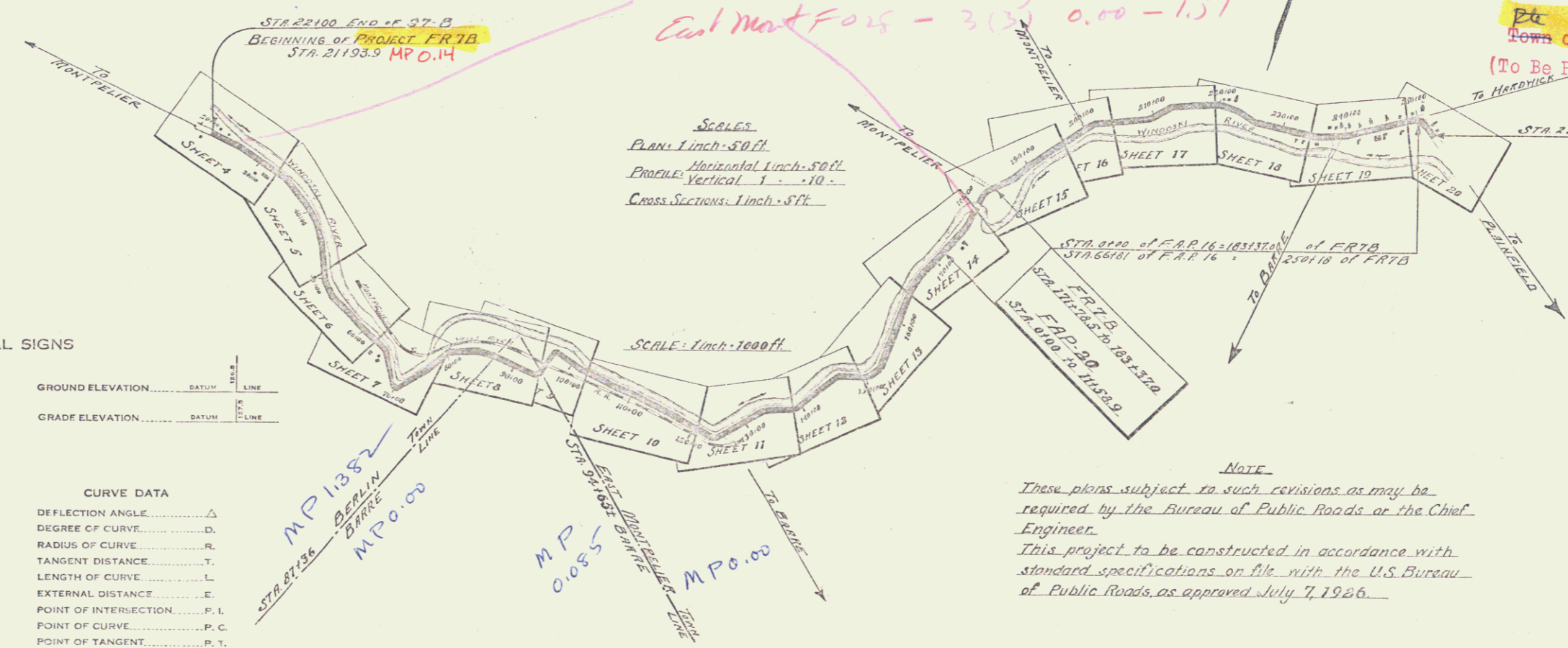

CONVENTIONAL SIGNS

COUNTY LINE	GROUND ELEVATION	BATHYM LINE
TOWN LINE	GRADE ELEVATION	DATUM LINE
FENCE LINE		
STONE WALL		
UNFENCED PROPERTY		
GUARD RAIL		
TRAVELED WAY		
RAILROAD		
RETAINING WALL		
CENTER LINE		
SURVEY LINE		
CULVERT		
DROP INLET		
TROLLEY POLE		
POWER POLE		
TELEPHONE POLE		
TREES		
HEDGE		

CURVE DATA

DEFLECTION ANGLE Δ
DEGREE OF CURVE D
RADIUS OF CURVE R
TANGENT DISTANCE T
LENGTH OF CURVE L
EXTERNAL DISTANCE E
POINT OF INTERSECTION P. I.
POINT OF CURVE P. C.
POINT OF TANGENT P. T.
POINT ON TANGENT P. O. T.

APPROVED: *[Signature]*
 CHIEF ENGINEER
 SUBMITTED BY: *[Signature]*
 COMMISSIONER OF HIGHWAYS

RECOMMENDED: *[Signature]*
 DISTRICT ENGINEER BUREAU OF PUBLIC ROADS
 RECOMMENDED FOR APPROVAL: *[Signature]*
 CHIEF ENGINEER BUREAU OF PUBLIC ROADS
 APPROVED: *[Signature]*
 DIRECTOR BUREAU OF PUBLIC ROADS

NOTE
 These plans subject to such revisions as may be required by the Bureau of Public Roads or the Chief Engineer.
 This project to be constructed in accordance with standard specifications on file with the U.S. Bureau of Public Roads, as approved July 7, 1926.

SERIES F.R. NO. 78 FILED
 SHEET 1 OF 77

SHEET #6 MISSING
 STA 4100 TO 6300