

INDEX OF SHEETS

SHEET NO. 1	TITLE PAGE
" 2	TYPICAL CROSS-SECTION OF IMPROVEMENT
" 3	DETAILS OF CONSTRUCTION
" 4-10	PLAN AND PROFILE SHEETS - STA 400+00.0 - 495+21.5
" 11	STD STRUCTURE SHEET 3-20 PIPE CULVERTS
" 12	" " " 3-21 BOX CULVERTS
" 13	" " " 5-22 GUARD RAIL ETC
" 14	" " " 5C-1 CULVERTS 5 FT SPAN AND OVER
" 15-32	CROSS SECTION SHEETS - STA 400+00.0 - 495+21.5

FED. ROAD DIST. NO.	STATE	ROLL NO.	PAGE NO.	TOTAL SHEETS
9	VT.	1078	1	32

STATE OF VERMONT
STATE HIGHWAY DEPARTMENT

PLAN AND PROFILE OF PROPOSED
STATE HIGHWAY

FEDERAL AID PROJECT

TOWN OF MIDDLESEX AND CITY OF MONTPELIER

BURLINGTON - MONTPELIER ROAD

FROM THE END OF PROJECT 107-A

EAST 1.793 MILES

LENGTH OF PROJECT 9471.8 FT. 1.793 MILES

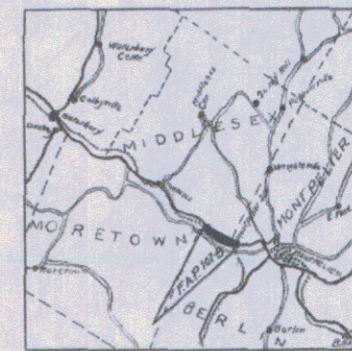

SCALE 1/4" = 1 MILE

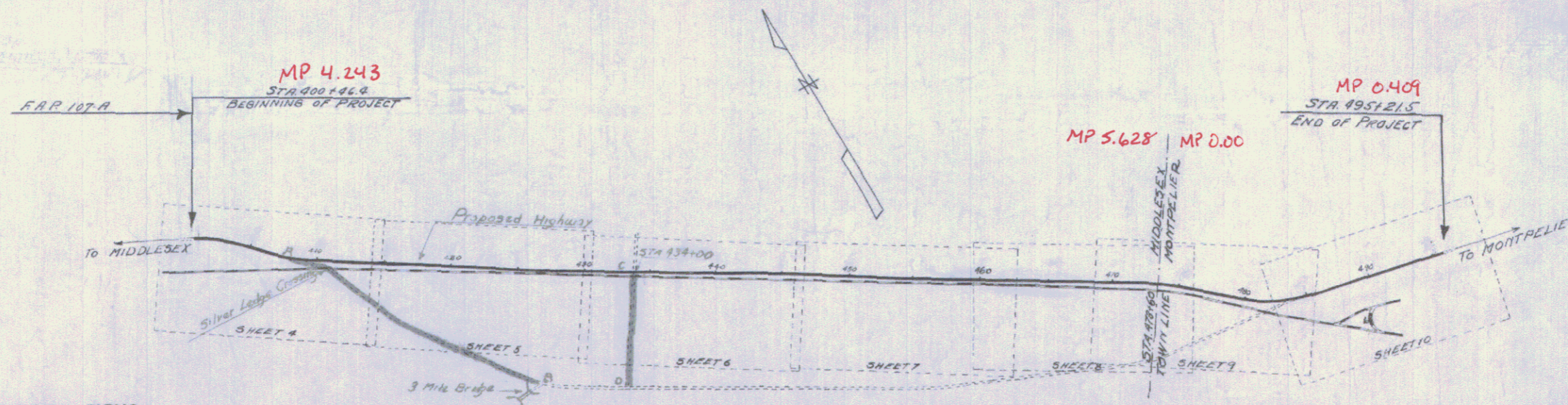

CONVENTIONAL SIGNS

- COUNTY LINE
- TOWN LINE
- FENCE LINE
- STONE WALL
- UNFENCED PROPERTY
- GUARD RAIL
- TRAVELED WAY
- RAILROAD
- RETAINING WALL
- CENTER LINE
- SURVEY LINE
- CULVERT
- DROP INLET
- TROLLEY POLE
- POWER POLE
- TELEPHONE POLE
- TREES
- HEDGE

- GROUND ELEVATION
- GRADE ELEVATION

- CURVE DATA
- DEFLECTION ANGLE
 - DEGREE OF CURVE
 - RADIUS OF CURVE
 - TANGENT DISTANCE
 - LENGTH OF CURVE
 - EXTERNAL DISTANCE
 - POINT OF INTERSECTION
 - POINT OF CURVE
 - POINT OF TANGENT
 - POINT ON TANGENT

SCALE
TITLE PAGE 1" = 500'
PLAN & PROFILE (HORIZ.) 1" = 50'
VERT. 1" = 10'
CROSS SECTIONS 1" = 5'

This Project to be constructed in accordance with Standard Road and Bridge Specifications for 1930.

These plans are subject to such revisions as may be required by the Bureau of Public Roads or the Commissioner of Highways.

APPROVED: APRIL 12 1930

H. E. Sargent
COMMISSIONER OF HIGHWAYS

SUBMITTED BY ORDER OF THE STATE HIGHWAY BOARD

U.S. #2

587

Pin # 99R107

RECOMMENDED

DISTRICT ENGINEER BUREAU OF PUBLIC ROADS

RECOMMENDED FOR APPROVAL

CHIEF ENGINEER BUREAU OF PUBLIC ROADS

APPROVED

DIRECTOR - BUREAU OF PUBLIC ROADS

SERIES F NO. 1078 FILED
SHEET 1 OF 32