

WOOD GUARD RAIL REQUIRED
 Stations Left Right
 302+38-302+62 24 ft 24 ft

CABLE GUARD RAIL REQUIRED
 Stations Left Right
 308+37-300+13 56 ft 56 ft

New Drain Conc. Pipe Culverts Required
 Station Size Length Conc. C/A Steel
 302+50 24 32 28 cu. yds. 54*

REPAIRS ON CULVERTS REQUIRED
 Station Size Length Conc. C/A Steel
 308+72 6x6 1.4 cu yd. 510*

10

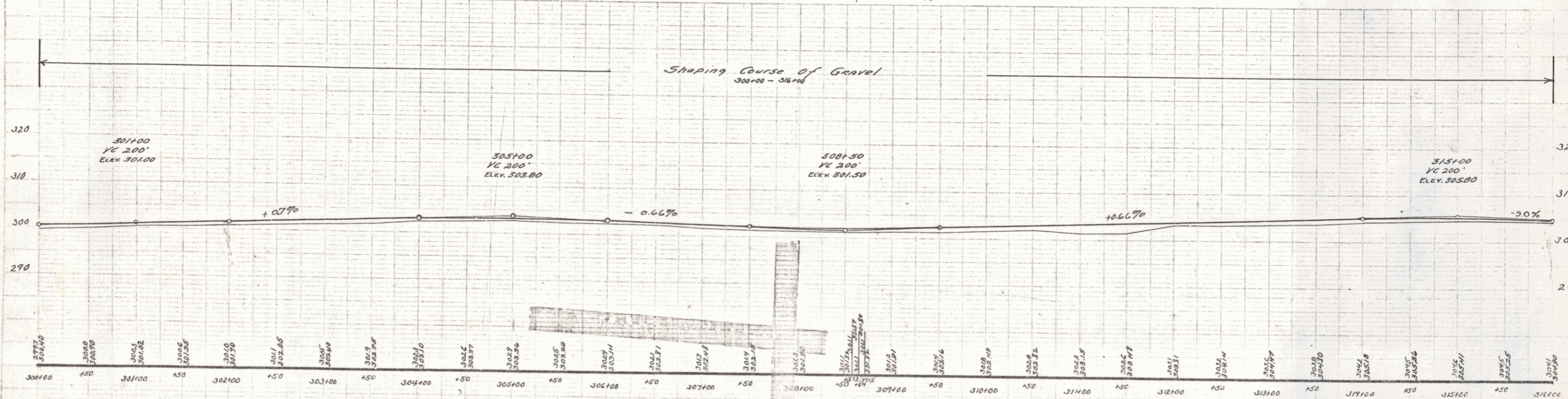
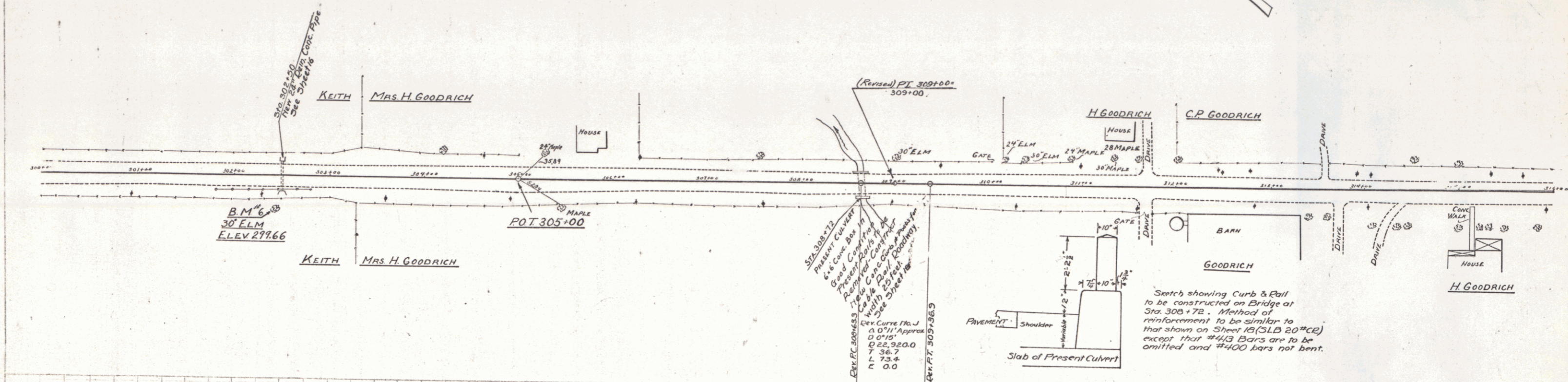

B.M. #6 RT of STA 302+40 30" ELM ELEV 299.66

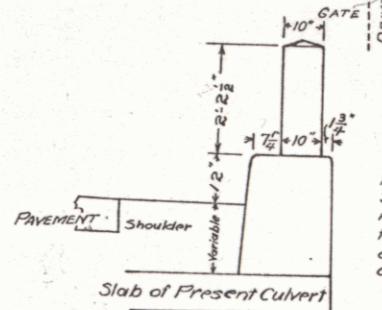

Sketch showing Curb & Rail to be constructed on Bridge at Sta. 308+72. Method of reinforcement to be similar to that shown on Sheet 10 (SLB 20"CE) except that #4's Bars are to be omitted and #4's bars not bent.

SERIES F No. 60C
 SHEET 10 OF 50

37