

WOOD GUARD RAIL REQUIRED
 217+00 - 217+33 24ft
 217+04 - 217+20 24ft

OLEW REIN CONC PIPE CULVERTS REQUIRED
 Station Dia. L.C. C. L. C. L. C. L. C. L.
 217+23 18" 40ft 30cy 33"

60 C - 103 B

Town: Williston-Richmond

Route: US2

Project: FH600

Williston MP 398-5.897
 Richmond MP 0.00-0.60±

RIGHT-OF-WAY DIVISION
 TOWN FILE

PERPETUAL
 Town of US2
 (To Be Returned To R.O.W. Division)

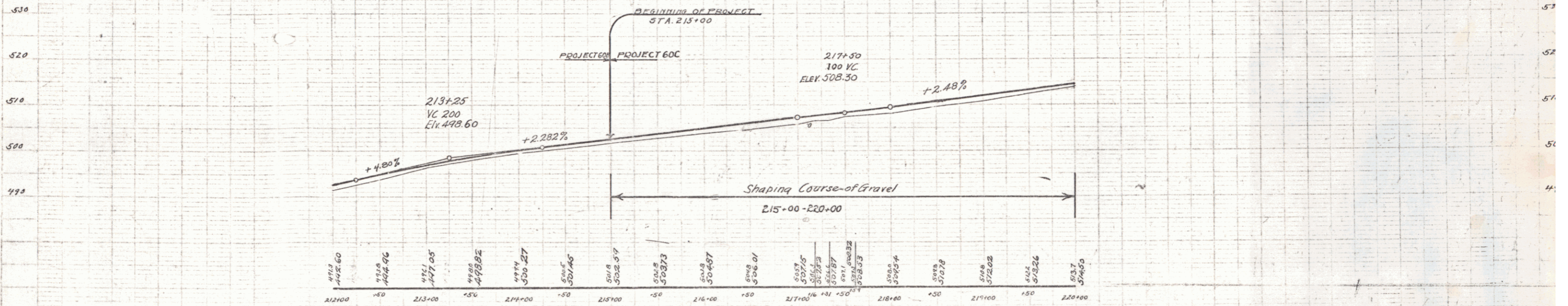
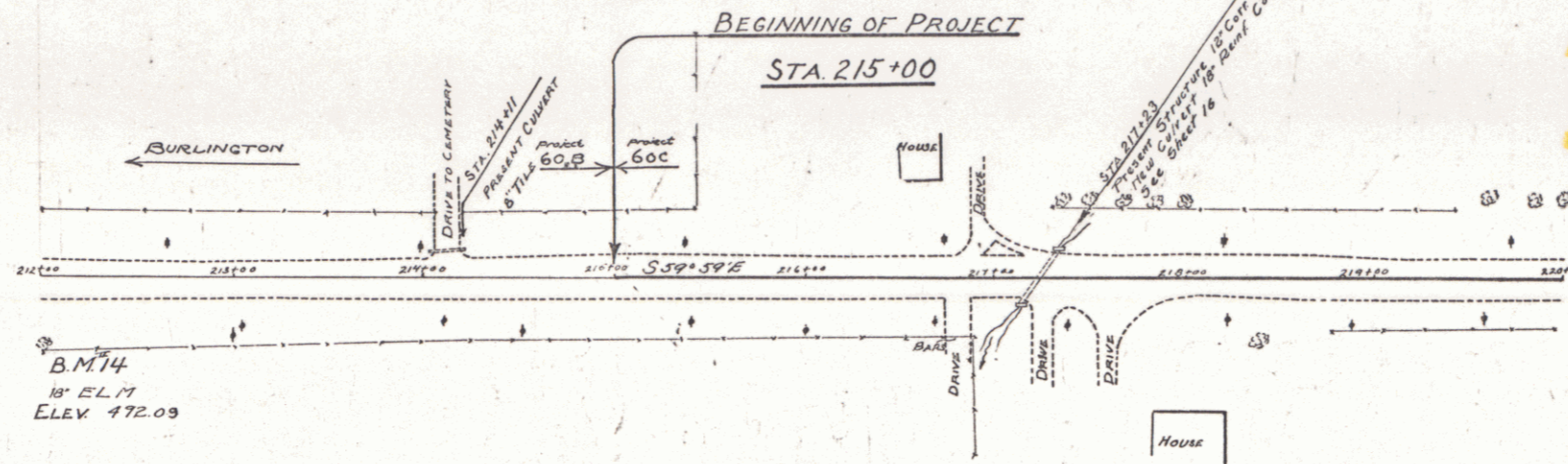

Williston 60 C &

B.M. No 14 18' E.L.M. 150' E. OF SMALL BRIDGE AT WILLISTON, 32 FT. E. OF STA. 212+00 - ELEV. 492.03

SERIES F 170 60C
 SHEET 4 OF 50

DIST. # 5 PLANS