

GUARD RAIL REQUIRED.  
 ON LEFT  
 Sta. 5+88 to Sta. 6+12 Length 24 ft.  
 ON RIGHT  
 " 5+88 to Sta. 6+12 Length 24 ft.  
 Total This Sheet 48 ft.

NEW CULVERTS REQUIRED.  
 Sta. 6+00 2'x2' Concrete. 53 Cu Yds.  
 1-2' " " 79 " "  
 1-2'-5" Steel 128 lbs.

PERMANENT	TOTAL	ADJUSTED	REVISIONS	SHEET	TOTAL
0	1	0	0	1	1
0	1	0	0	1	1

M.E. Walker 5/22  
S.H. Field 5/23

M.E. Walker 5/22  
S.H. Field 5/23

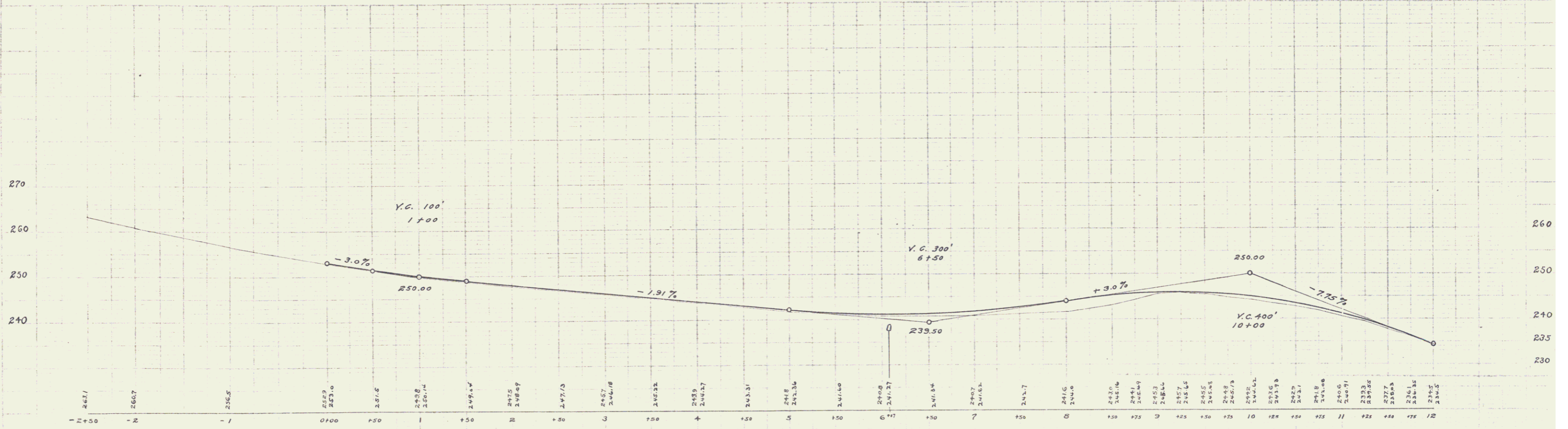
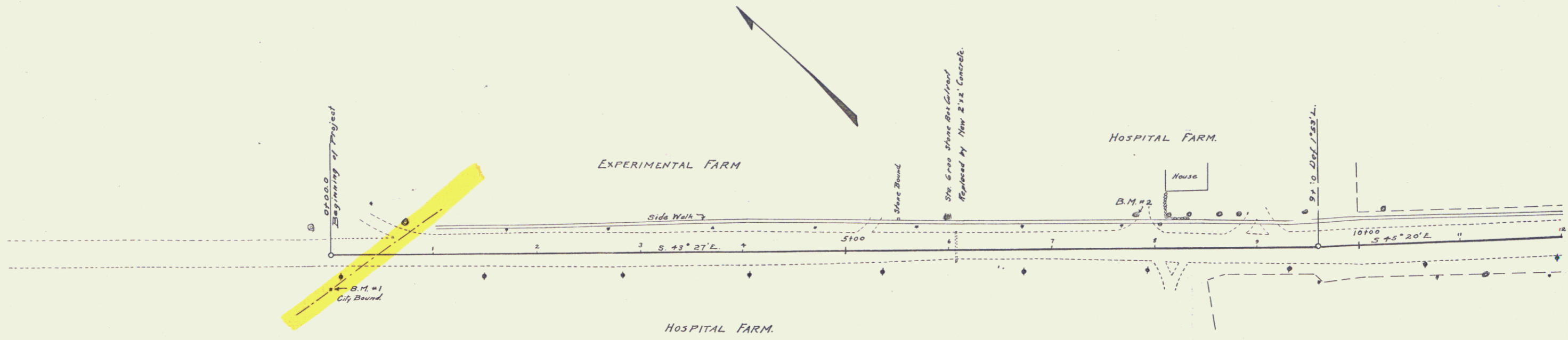

B.M. No. 1. City Bound Right of 0+00, Elev. 255.04  
 B.M. No. 2. Spike in Lim Left of 7+70, Elev. 241.88

Series R No. 60A  
 Sheet 23 of 23