

CABLE GUARD RAIL REQUIRED
ON RIGHT
STA 250+75 TO STA 252+00 — LENGTH 125 FT

WOOD GUARD RAIL
ON LEFT
STA 250+96 TO STA 251+00
LENGTH 24 LINEAR FEET

STA 251+08 — 18" REINFORCED CONCRETE PILE — LENGTH 10 FT
CONCRETE — CLASS A
REINFORCED STEEL

7 11 1954

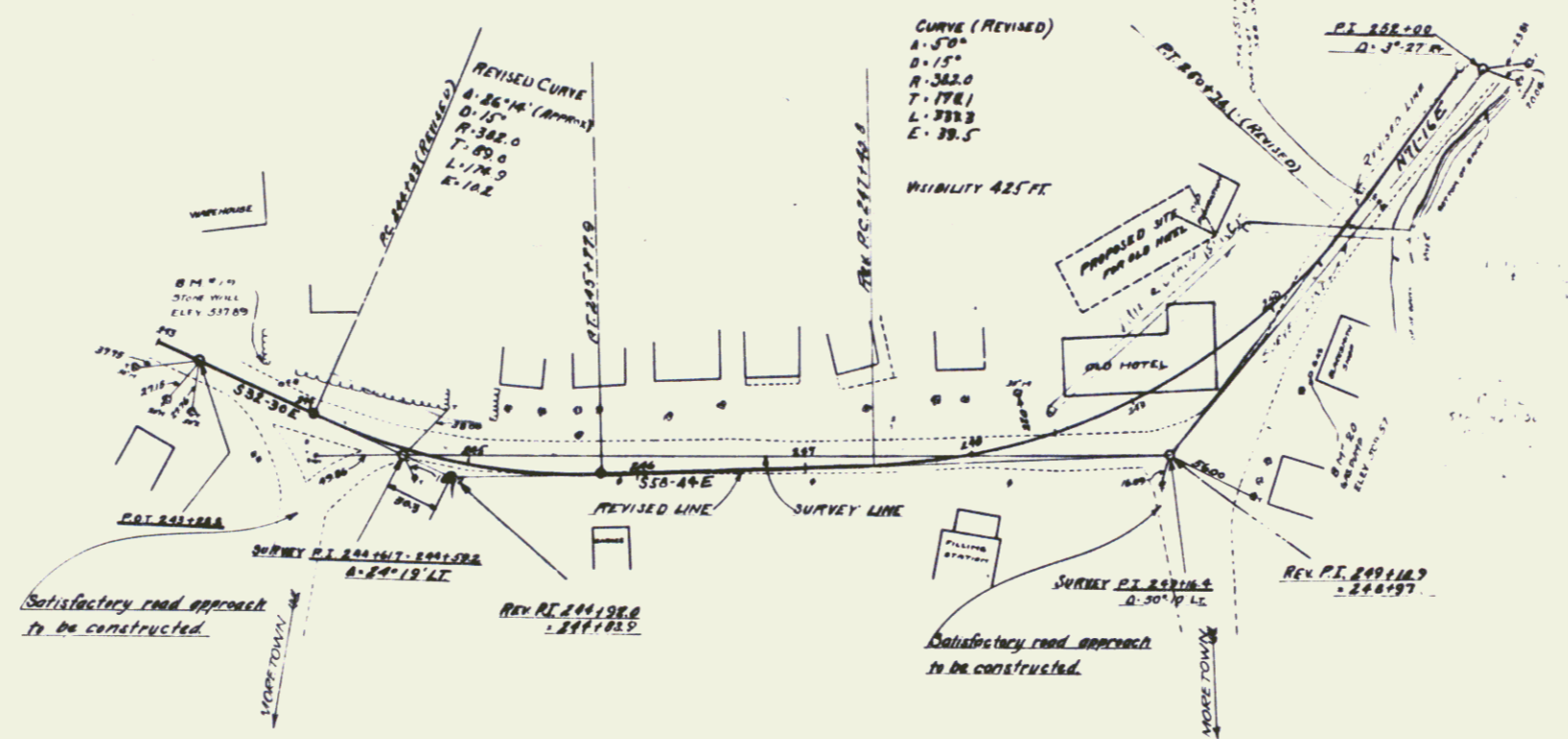

NOTE
Up to STA 243+00, ELEV. OF CLM 17-536.18
From STA 243+00 TO STA 243+00
Equation of Elevation = 1.06 at Sta 243+00

540
530
520
510
500
490

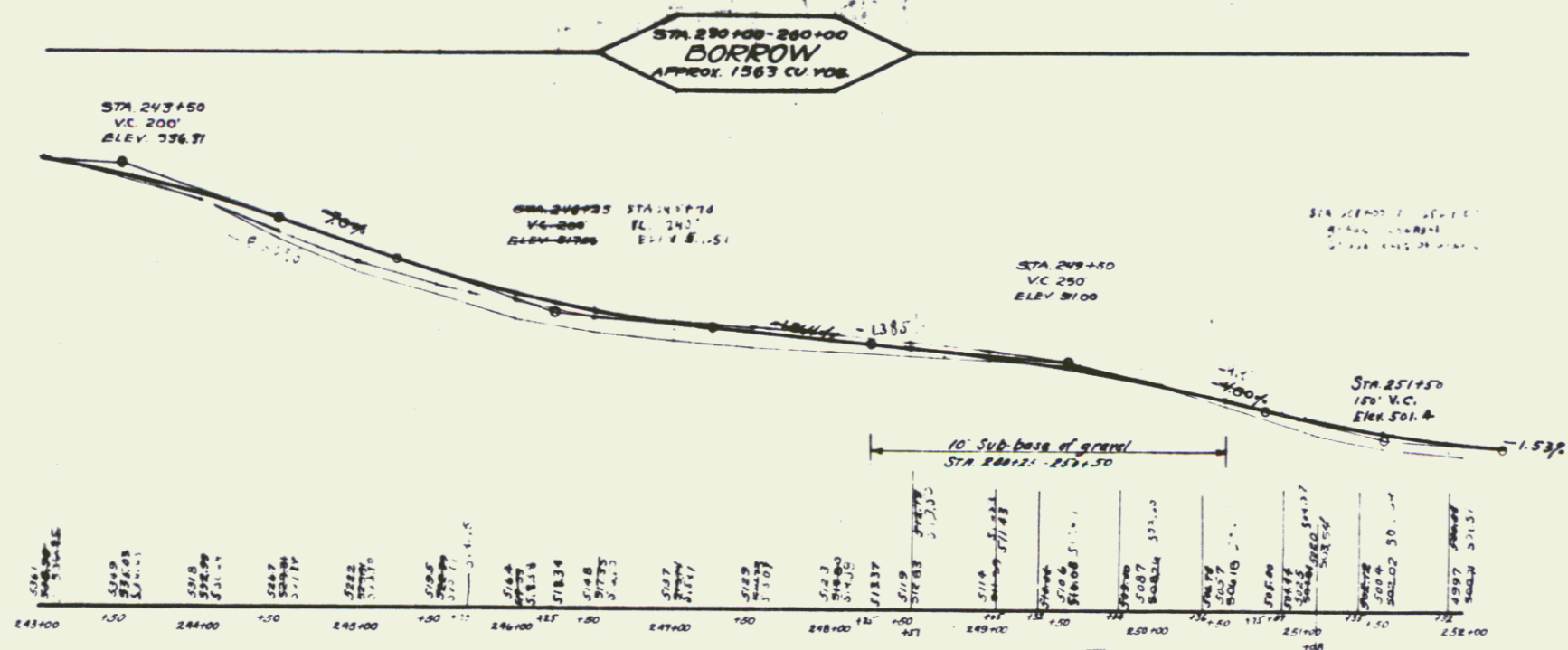

8' 11" 19 53 STONE WALL LEFT OF STA 243+00 ELEV 523.87
8' 11" 20 53 STONE WALL LEFT OF STA 243+00 ELEV 523.87