

- NEW GUARD RAIL REQUIRED -
 Wood Guard Rail
 STA 224+75 TO STA 225+67 - LENGTH 92 FT
 Cable Guard Rail
 STA 224+75 TO STA 224+83 - LENGTH 8 FT
 STA 226+40 TO STA 225+00 - LENGTH 140 FT
 STA 225+00 TO STA 224+00 - LENGTH 100 FT
 TOTAL FOR SHEET = 300 FT

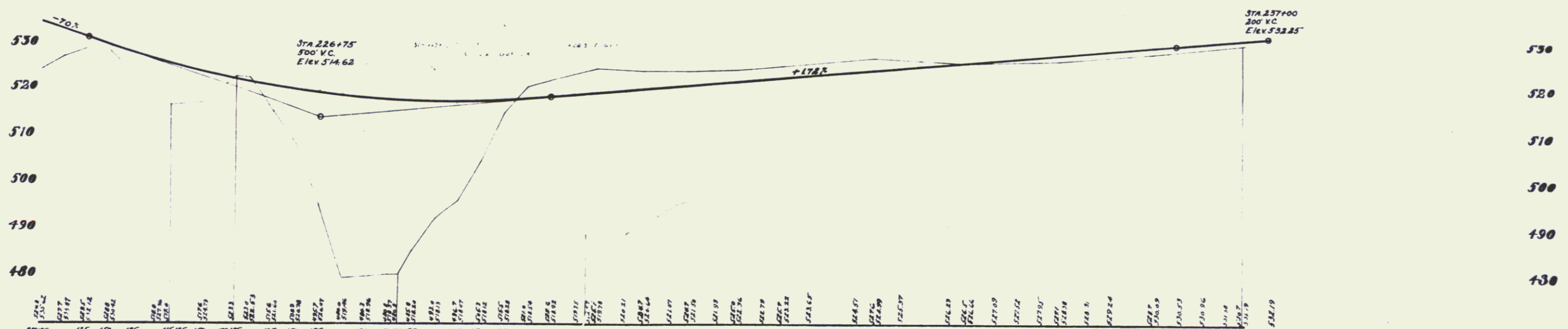

NOTE:
 For Elev of B.M. 18 carried forward from B.M. 17, use elev of 536.18
 For Elev of B.M. 19 and on, carried forward from B.M. 17, use elev of 537.98

SERIES NEW STATE LANDS ADJUS
 SERIES FORWARDED
 SHEET 15 OF 16

12