

INDEX OF SHEETS

SHEET NO. 1 TITLE PAGE

- 2 AND 2A TYPICAL CROSS-SECTION OF IMPROVEMENT (ONE COURSE CEMENT CONCRETE PAVEMENT)
- 3 DETAILS OF CONSTRUCTION
- 4-25 PLAN AND PROFILE SHEETS
- 26 STANDARD STRUCTURE SHEET-S-20-PIPE CULVERTS
- 27 STANDARD STRUCTURE SHEET-S-21-BOX CULVERTS
- 28 STANDARD STRUCTURE SHEET-S-22-GUARD RAIL, ETC.
- 28A CONCRETE CURBING
- 29 STANDARD APPROACH SLAB WITH DROP INLET-S.A.-8
- 30 APPROACH SLAB FOR BRIDGE, STA. 437+18-STA. 438+20
- 31-65 CROSS SECTIONS

STATE OF VERMONT
STATE HIGHWAY DEPARTMENT

PLAN AND PROFILE OF PROPOSED
STATE HIGHWAY

FEDERAL AID PROJECT

Rte US2

TOWNS OF COLCHESTER-MILTON-SO. HERO

3-LAND ROAD

FROM "OLD CHIMNEY CORNER," WEST 6.751 MILES Pin# 99R-093

FED. ROAD DIST. NO.	STATE	PROJ. NO.	FISCAL YEAR
9	VT.	F.A.P. 29	1930

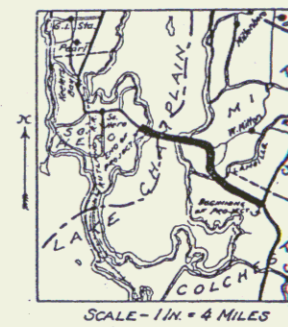

(To be returned to H. H. O. M. Division)
US 2
TOWN OF
SHERBURN
HIGHWAY DEPARTMENT
MILTON DIVISION

PROJECT NO.	GOV'T PARTICIPATION		NON-GOV'T PARTICIPATION		BRIDGE FEET
	FEET	MILES	FEET	MILES	
F.A.P. 106A	20,147.1	3.8154	~	~	~
F.A.P. 36 (Reopened)	7,570.0	1.433	~	~	~
F.A.P. 29 (Reopened)	6,040.4	1.144	350.0	0.068	42.0
S.F.A. 128A	~	~	1,491.5	0.282	~
TOTALS	33,757.5	6.3924	1,841.5	0.350	42.0
CONTRACT	EXCL. BR. OVER 20' SPAN	3,5607.0 FT.	6.743 MI.		
	INCL. BR. OVER 20' SPAN	3,5649.0 FT.	6.751 MI.		

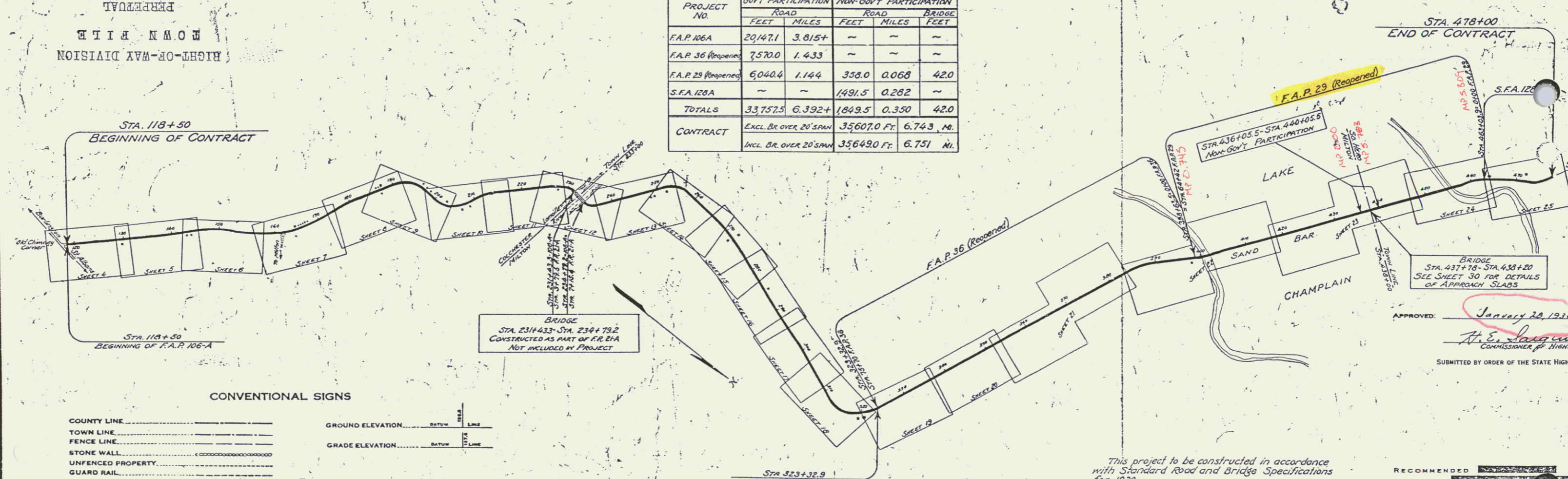

- CONVENTIONAL SIGNS**
- COUNTY LINE
 - TOWN LINE
 - FENCE LINE
 - STONE WALL
 - UNFENCED PROPERTY
 - GUARD RAIL
 - TRAVELED WAY
 - RAILROAD
 - RETAINING WALL
 - CENTER LINE
 - SURVEY LINE
 - CULVERT
 - DROP INLET
 - TROLLEY POLE
 - POWER POLE
 - TELEPHONE POLE
 - TREES
- CURVE DATA**
- DEFLECTION ANGLE.....Δ
 - DEGREE OF CURVE.....D
 - RADIUS OF CURVE.....R
 - TANGENT DISTANCE.....T
 - LENGTH OF CURVE.....L
 - EXTERNAL DISTANCE.....E
 - POINT OF INTERSECTION.....P. I.
 - POINT OF CURVE.....P. C.
 - POINT OF TANGENT.....P. T.

~ SCALES ~
Layout - 1 in = 1000 ft
Plan - 1 in = 50 ft
Profile - Vert - 1 in = 40 ft
Sections - 1 in = 5 ft

This project to be constructed in accordance with Standard Road and Bridge Specifications for 1930.

These plans are subject to such revisions as may be required by the Bureau of Public Roads or the Chief Engineer.

APPROVED: *January 26, 1930*
H. E. Langdon
COMMISSIONER OF HIGHWAYS

project F.A.P. 29
F.A.P. 106A-F.A.P. 36 (R)-F.A.P. 29 (R)-S.1

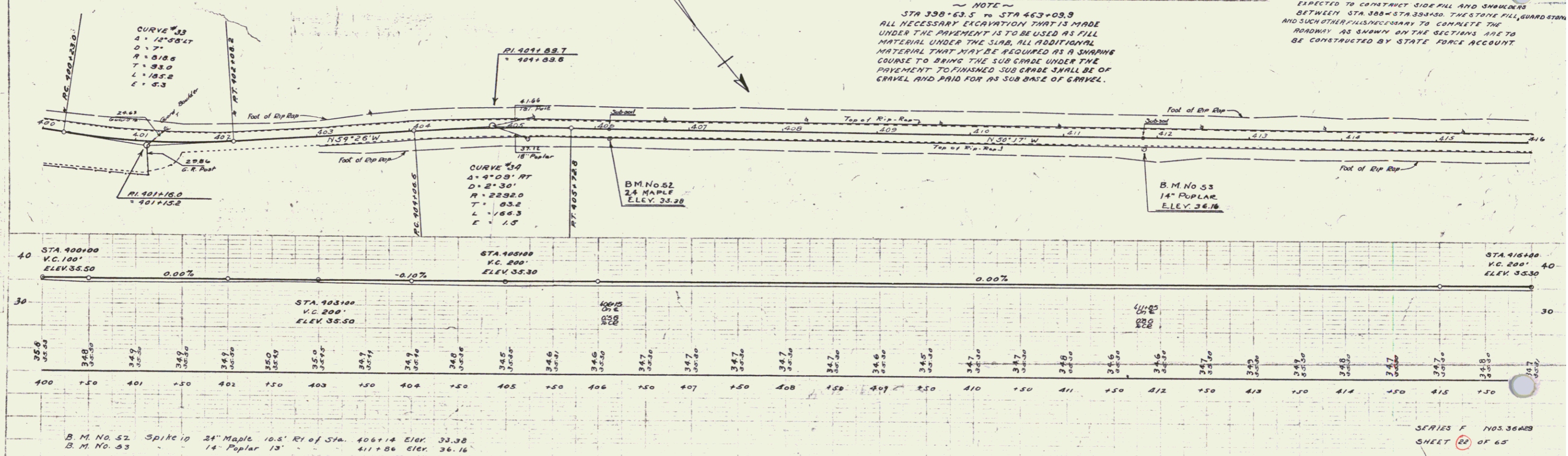
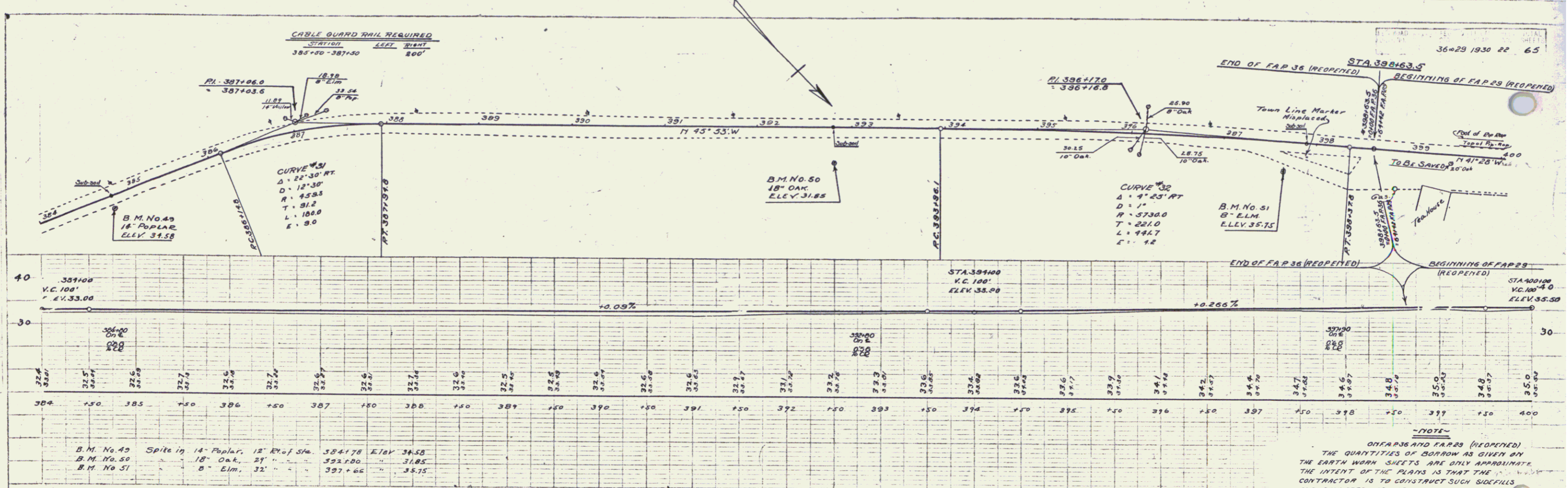

NOTE
STA 398+63.5 to STA 463+09.9
ALL NECESSARY EXCAVATION THAT IS MADE UNDER THE PAVEMENT IS TO BE USED AS FILL MATERIAL UNDER THE SLAB. ALL ADDITIONAL MATERIAL THAT MAY BE REQUIRED AS A SHARPING COURSE TO BRING THE SUB GRADE UNDER THE PAVEMENT TO FINISHED SUB GRADE SHALL BE OF GRAVEL AND PAID FOR AS SUB BASE OF GRAVEL.

NOTE
ON PAPER AND PAPER (REQUIRED)
THE QUANTITIES OF BORROW AS GIVEN BY THE EARTH WORK SHEETS ARE ONLY APPROXIMATE. THE INTENT OF THE PLANS IS THAT THE CONTRACTOR IS TO CONSTRUCT SUCH SIDEFILLS AND SHOULDERS AS ARE NECESSARY TO HOLD FORMS AND PAVELLETS. THE CONTRACTOR IS EXPECTED TO CONSTRUCT SIDE FILL AND SHOULDERS BETWEEN STA 388+STA 393+50. THE STONE FILL GUARD RAIL AND SUCH OTHER FILLS NECESSARY TO COMPLETE THE ROADWAY AS SHOWN ON THE SECTIONS ARE TO BE CONSTRUCTED BY STATE FORCE ACCOUNT.

B.M. No. 52 Spike in 24" Maple 10.5' RI of Sta. 406+14 Elev. 35.38
B.M. No. 53 14" Poplar 13' 411+86 Elev. 36.16

106

2

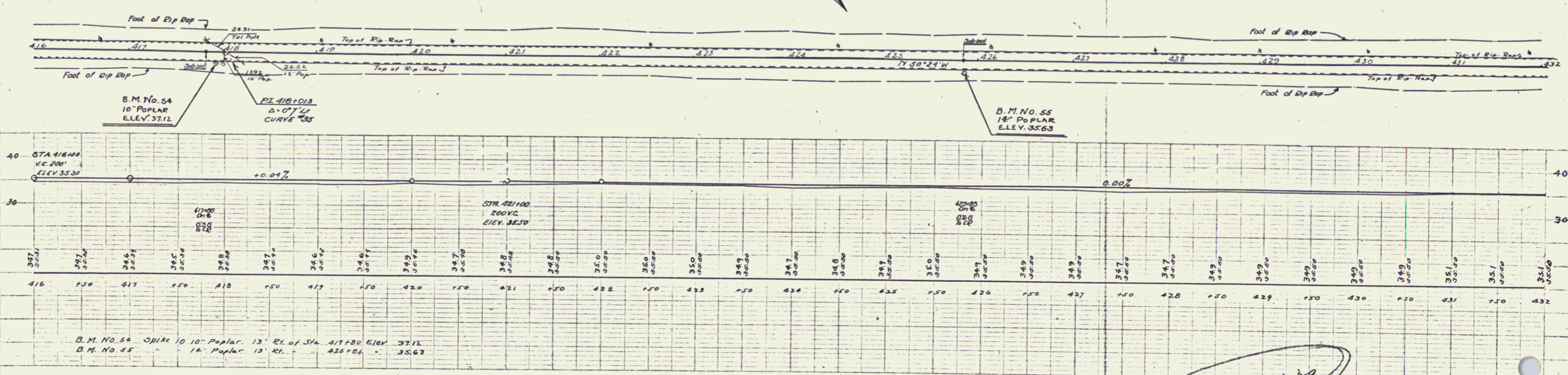

B.M. No. 54 Spike 10' Poplar 13' RI. of Sta. 417.80 ELEV. 37.12
 B.M. No. 55 " " " 18' " " 426.04 " 35.63

CABLE GUARD RAIL WITH CONCRETE POSTS REQUIRED
 STATION LEFT RIGHT
 435+00 TO 437+75 10' HIGH
 437+75 TO 440+00 10' HIGH
 POSTS TO BE GRouted INTO STONE FILL THIS ITEM TO BE CONSTRUCTED BY STATE FORCE ACCOUNT

NON-GOVT PARTICIPATION
 BRIDGE FLOOR TO BE THOROUGHLY CLEANED BEFORE APPLYING BITUMINOUS CONCRETE WEARING SURFACE (ITEM 24)

BALLAST WALLS ON BRIDGE ARE TO BE CUT DOWN, SO THAT WALLS MAY ACT AS SEATS FOR APPROACH SLABS. SEE SHEET 24 FOR DETAILS.

BRIDGE STA 437+75 - STA 438+00
 BITUMINOUS CONCRETE WEARING SURFACE (ITEM 24) TO BE PLACED ON BRIDGE FLOOR BY STATE FORCE ACCOUNT

BRIDGE STA 437+75 - STA 438+00
 SEE SHEET 30 FOR DETAILS OF APPROACH SLAB.

MILTON J.O. HERO

ELEV. 35.70 = USGM 103-20

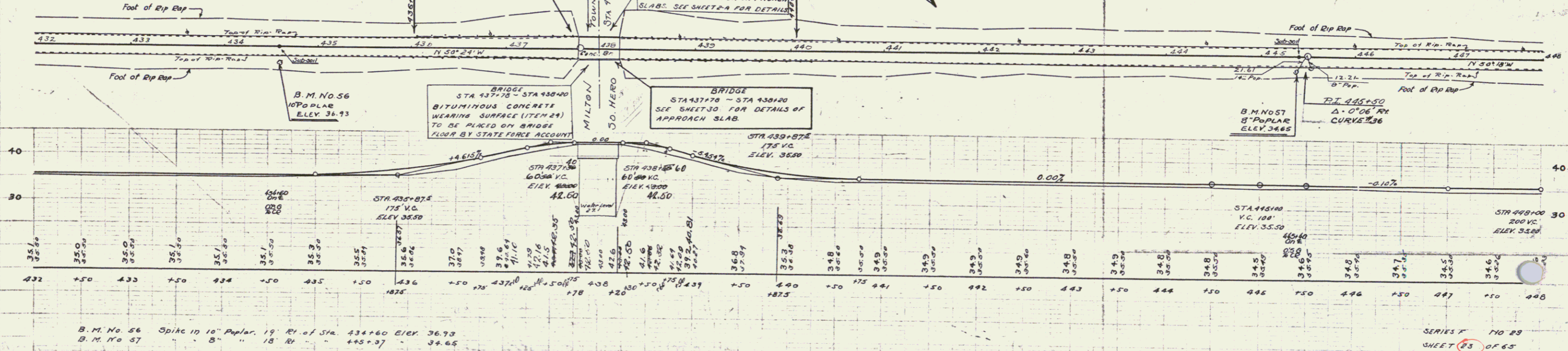

B.M. No. 56 Spike 10' Poplar 19' RI. of Sta. 434+60 ELEV. 36.73
 B.M. No. 57 " " " 8' " " 445+37 " 34.65

3

CABLE GUARD RAIL REQUIRED
 STATION LEFT RIGHT
 461+51.3 - 463+43.9 150' 32'
 463+03.9 - 464+00 36'

STATE VT. 29-J-1930 29-65
 578
 128A

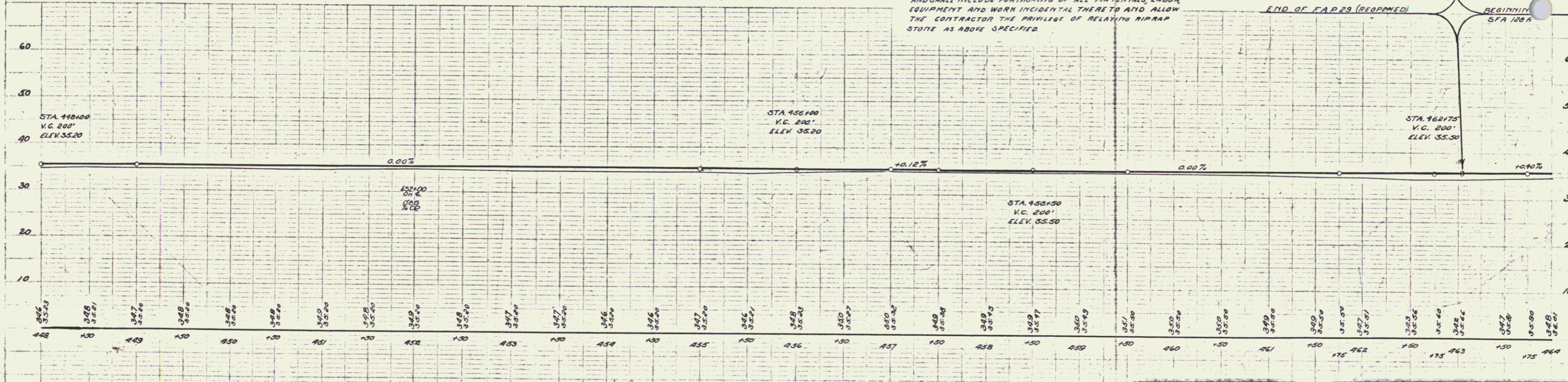
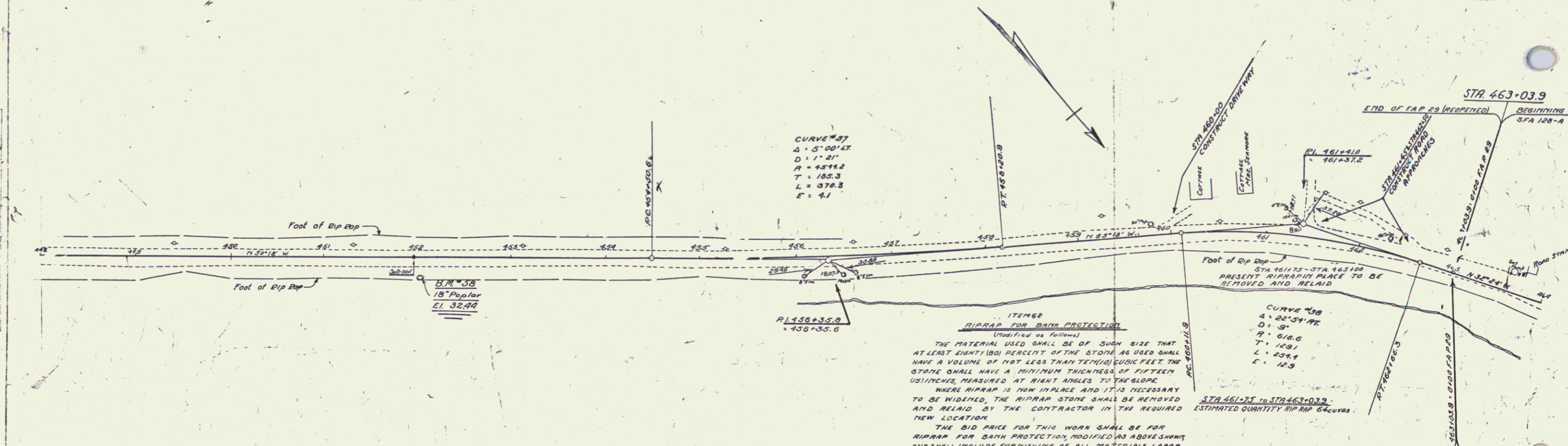

B.M. No 38 Spike in roof 18" Poplar At STA 452+05 ELEV. 32.44

SERIES STA 110 128A
 SERIES I NO 29/11
 SHEET 29 OF 65

INDEX OF SHEETS

SHEET NO. 1 TITLE PAGE

2 AND 2A TYPICAL CROSS-SECTION OF IMPROVEMENT (ONE COURSE CEMENT CONCRETE PAVEMENT)

3 DETAILS OF CONSTRUCTION

4-25 PLAN AND PROFILE SHEETS

26 STANDARD STRUCTURE SHEET-S-20-PIPE CULVERTS

27 STANDARD STRUCTURE SHEET-S-21-BOX CULVERTS

28 STANDARD STRUCTURE SHEET-S-22-GUAR. RAIL, ETC.

28A CONCRETE CRIBBING

28 STANDARD APPROACH SLAB WITH DROPPED INLET-S.B.-8

30 APPROACH SLAB FOR BRIDGE, STA. 437+10-S+130+20

31-65 CROSS SECTIONS

STATE OF VERMONT
STATE HIGHWAY DEPARTMENT

PLAN AND PROFILE OF PROPOSED
STATE HIGHWAY

FEDERAL AID PROJECT
TOWNS OF COLCHESTER-MILTON-SO. HERO
3-LAND ROAD
FROM "OLD CHIMNEY CORNER," WEST 6.751 MILES

FED. ROAD DIST. NO.	STATE	PROJ. NO.	FISCAL YEAR
9	VT.	F.A.P. 106A	1930
		S.F.A. 128A	

(To Be Returned to R.O.M. Division)
TOWN OF
SOUTH HERO
RIGHT-OF-WAY DIVISION

PROJECT NO.	GOV'T PARTICIPATION		NON-GOV'T PARTICIPATION		BRIDGE FEET
	ROAD FEET	ROAD MILES	ROAD FEET	ROAD MILES	
F.A.P. 106A	20,471.1	3.815+	~	~	~
F.A.P. 36 (Reopened)	7,570.0	1.433	~	~	~
F.A.P. 29 (Reopened)	6,040.4	1.144	358.0	0.068	42.0
S.F.A. 128A	~	~	1,491.5	0.282	~
TOTALS	33,771.5	6.392+	1,849.5	0.350	42.0
CONTRACT	EXCL. BR. OVER 20'SPAN		3,5607.0 Ft.	6.743 Mi.	
	INCL. BR. OVER 20'SPAN		3,5649.0 Ft.	6.751 Mi.	

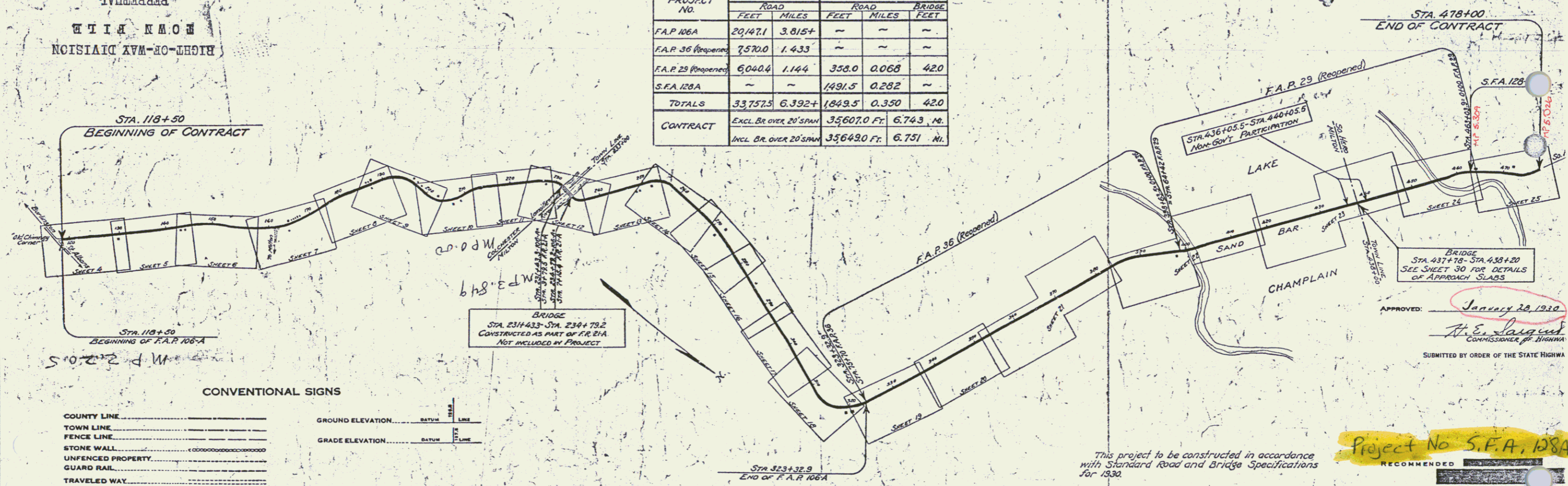
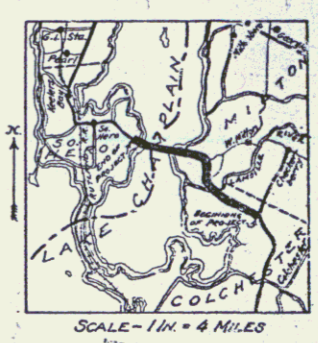

CONVENTIONAL SIGNS

COUNTY LINE	GROUND ELEVATION
TOWN LINE	GRADE ELEVATION
FENCE LINE	
STONE WALL	
UNFENCED PROPERTY	
GUARD RAIL	
TRAVELED WAY	
RAILROAD	
RETAINING WALL	
CENTER LINE	
SURVEY LINE	
CULVERT	
DROPPED INLET	
TROLLEY POLE	
POWER POLE	
TELEPHONE POLE	
TREES	

CURVE DATA

DEFLECTION ANGLE	Δ
DEGREE OF CURVE	D
RADIUS OF CURVE	R
TANGENT DISTANCE	T
LENGTH OF CURVE	L
EXTERNAL DISTANCE	E
POINT OF INTERSECTION	P. I.
POINT OF CURVE	P. C.
POINT OF TANGENT	P. T.

SCALES
Layout - 1 in. = 1000 ft.
Plan - 1 in. = 50 ft.
Profile - Hor. - 1 in. = 50 ft.
Vert. - 1 in. = 10 ft.
Sections - 1 in. = 5 ft.

This project to be constructed in accordance with Standard Road and Bridge Specifications for 1930.

These plans are subject to such revisions as may be required by the Bureau of Public Roads or the Chief Engineer.

Project No. S.F.A. 128A

RECOMMENDED

DISTRICT ENGINEER

BUREAU OF PUBL.

RECOMMENDED FOR APPROVAL

CHIEF ENGINEER

APPROVED

DIRECTOR - BUREAU OF PUBLIC ROADS

F.A.P. 106A-F.A.P. 36 (R)-F.A.P. 29 (R)-S.F.

WOOD GUARD RAIL REQUIRED

CULVERT STATION	LEFT	RIGHT
463+63	24'	
471+38	24'	
476+75	26'	24'

CABLE GUARD RAIL REQUIRED

STATION	LEFT	RIGHT
461+00-465+43	19'	
466+25-467+77	152'	
468+50-472+76	416'	

NEW REINF CONCRETE PIPE CULVERTS REQUIRED

STATION	DIAM	LENG	CONC-A	CONC-C	REINF STEEL
469+68	30"	40'	24 CY		54#
471+58	30"	36'	32 CY		58#
474+75	15"	36'		23 CY	33#

GROUTED COBBLE GUTTER REQUIRED

STATION	LENG	WIDTH	LEVS	AREA
464+50-464+91	41'	3'-0"	0'	236.7 sq. ft.
465+24-465+30	6'	3'-0"	0'	206.1 sq. ft.

CONCRETE CURB AND GUTTER REQUIRED

STATION	LENG	WIDTH	CURB HT	AREA
464+44-465+25	81'	2'-0"	0'	324.0 sq. ft.

FED. ROAD DIST. NO. STATE VT. S.F.A. 128-A

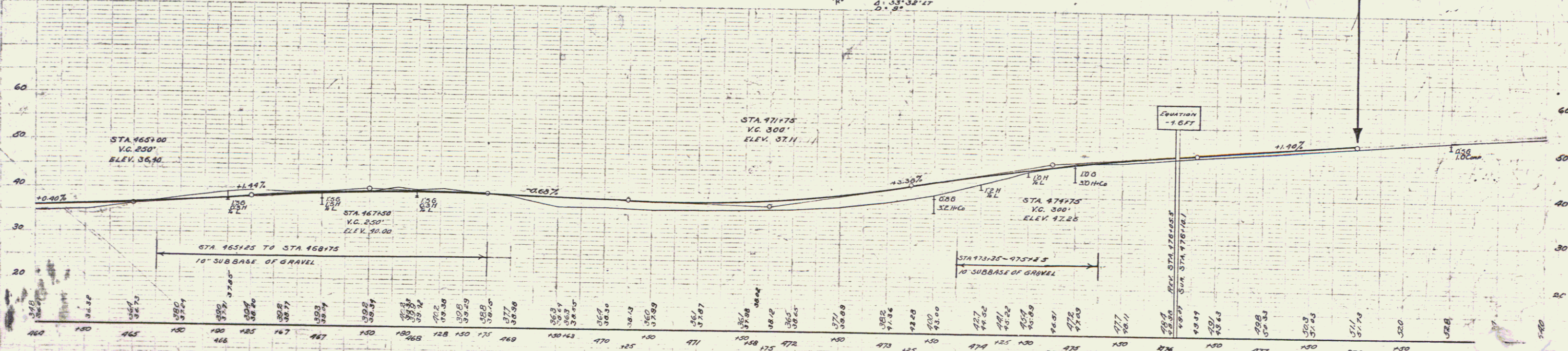
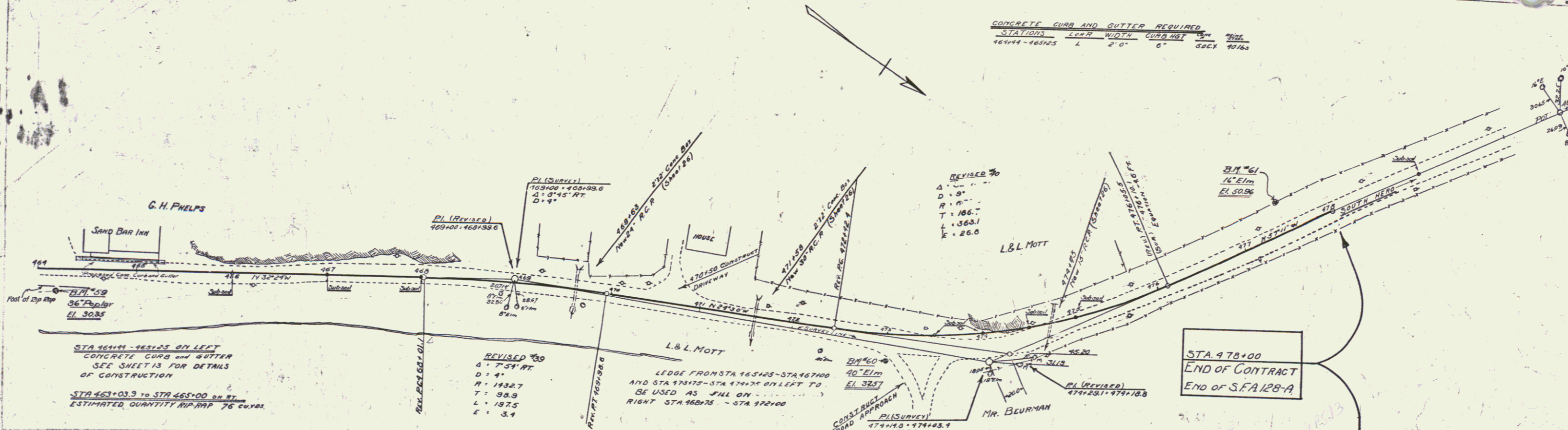

- B.M. No. 59 spike in root 36" poplar 11 STA 448+45 ELEV. 30.35
- B.M. No. 60 spike in root 40" Elm 22 1/2 STA 473+02 ELEV. 37.57
- rod 16" Elm 33 1/2 STA 477+47 ELEV. 50.96

7
SERIES SFA No 128-A
SHEET 43 OF 65