

WOOD GUARDRAIL REQUIRED
 STATION LEFT RIGHT
 325+40-325+72 24' 24'
 325+96-325+120 24' 24'

FED. ROAD STATE FED. AID FISCAL SHEET TOTAL
 DIST. NO. YEAR NO. SHEETS
 108 1930 19 65

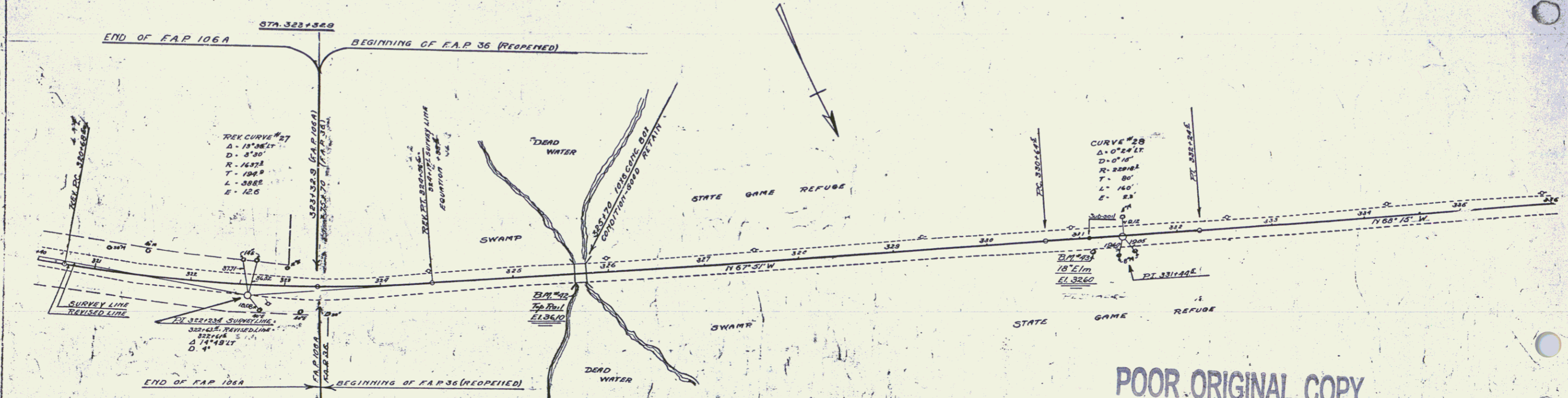

POOR ORIGINAL COPY

Revised Curve No. 27
 P.I. 322+234 S.C. Loc. P.I. 322+634 R.C. Loc. 322+716
 M.V. 322+234 - P.I. 322+393 - L. 322+574
 Δ was 12° 35' Now 13° 36' P.C. was 320+605 Now 320+641
 D = 3730' 4000' P.T. 324+165 324+526
 C = 16328 24000' E.C. 324+165 324+165
 T = 194.9 195.2 E.C. + 36.3
 L = 50.00 38.5
 E = 12.6

NOTE
 STA 323+32.9 TO STA 328+63.5
 ALL NECESSARY EXCAVATION THAT IS MADE UNDER
 THE PAVEMENT IS TO BE USED AS FILL MATERIAL
 UNDER THE SLAB, ALL ADDITIONAL MATERIAL THAT
 MAY BE REQUIRED AS A SURRING COURSE TO
 BRING THE SUB GRADE UNDER THE PAVEMENT
 TO FINISHED SUB GRADE SHALL BE OF GRAVEL
 AND PAID FOR AS SUB BASE OF GRAVEL.

NOTE
 ON F.A.P. 36 (F.A.P. 29 REOPENED)
 THE QUANTITIES OF BORROW AS GIVEN
 ON THE EARTHWORK SHEETS ARE ONLY
 APPROXIMATE. THE INTENT OF THE PLANS IS
 THAT THE CONTRACTOR IS TO CONSTRUCT
 SUCH SIDE FILLS AND SHOULDER AS ARE
 NECESSARY TO HOLD FORMS AND PAVEMENT.
 THE CONTRACTOR IS ALSO EXPECTED TO
 CONSTRUCT SIDE FILL AND SHOULDER BETWEEN
 STA 308+00 - STA 309+50. THE STONE FILL GUARDSTONES,
 AND SUCH OTHER FILLS NECESSARY TO COMPLETE
 THE ROADWAY AS SHOWN ON THE SECTIONS
 ARE TO BE CONSTRUCTED BY STATE FORCE
 ACCOUNT.

Station	Elevation	Station	Elevation	Station	Elevation	Station	Elevation
323+00	36.10	324+00	36.20	325+00	36.30	326+00	36.40
327+00	36.50	328+00	36.60	329+00	36.70	330+00	36.80
331+00	36.90	332+00	37.00	333+00	37.10	334+00	37.20
335+00	37.30	336+00	37.40				

B.M. No. 42 top of concrete bridge rail 11' N. Sta. 325+69 Elev. 36.10
 B.M. No. 43 spike in roof 18' Elm 13' N. Sta. 331+12 Elev. 32.60