

WOOD GUARDRAIL REQUIRED

STATION	LEFT	RIGHT
325+00 - 325+75	24'	24'
325+75 - 326+00	24'	20'

FED. ROAD DIST. NO.	FISCAL YEAR	SHEET NO.	TOTAL SHEETS
108A	1930	19	65

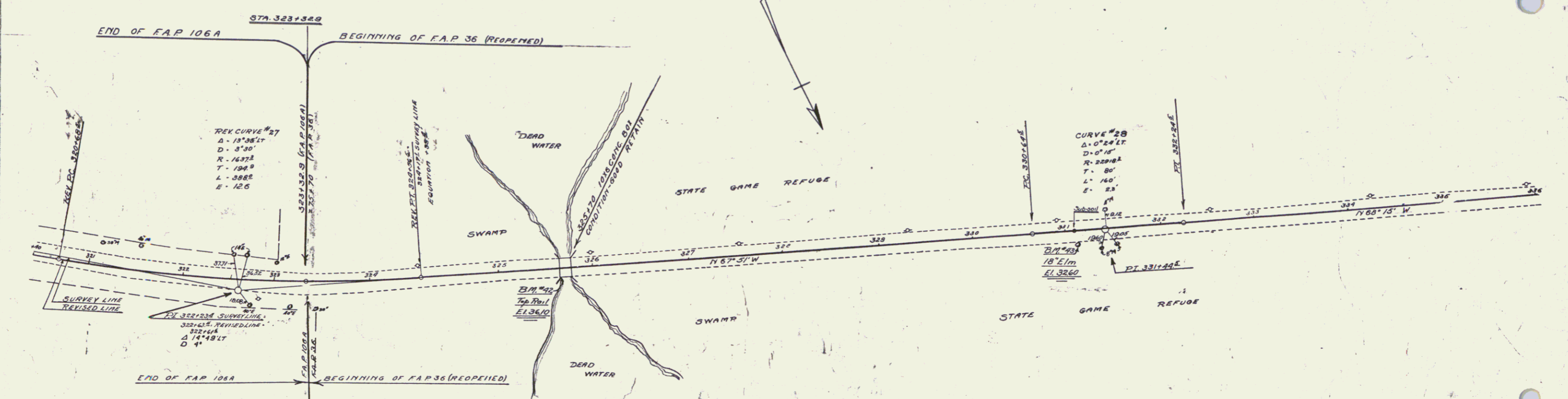

Revised Curve No 27
 P.I. 322+23.4
 Δ = 13° 35' 13.36"
 D = 37.30'
 R = 163.23'
 T = 194.9'
 L = 508.0'
 E = 12.6'

NOTE
 STA 323+32.9 TO STA 336+63.5
 ALL NECESSARY EXCAVATION THAT IS MADE UNDER THE PAVEMENT IS TO BE USED AS FILL MATERIAL UNDER THE SLAB. ALL ADDITIONAL MATERIAL THAT MAY BE REQUIRED AS A SHARPING COURSE TO BRING THE SUB GRADE UNDER THE PAVEMENT TO FINISHED SUB GRADE SHALL BE OF GRAVEL AND PAID FOR AS SUB BASE OF GRAVEL.

NOTE
 ON F.A.P. 36 + F.A.P. 29 (REOPENED)
 THE QUANTITIES OF BORROW AS GIVEN ON THE EARTHWORK SHEETS ARE ONLY APPROXIMATE. THE INTENT OF THE PLANS IS THAT THE CONTRACTOR IS TO CONSTRUCT SUCH SIDE FILLS AND SHOULDERS AS ARE NECESSARY TO HOLD FORMS AND PAVEMENT. THE CONTRACTOR IS ALSO EXPECTED TO CONSTRUCT SIDE FILL AND SHOULDERS BETWEEN STA 328+00 - STA 333+50. THE STONE FILL GUARDSTONES AND SUCH OTHER FILLS NECESSARY TO COMPLETE THE ROADWAY AS SHOWN ON THE SECTIONS ARE TO BE CONSTRUCTED BY STATE FORCE ACCOUNT.

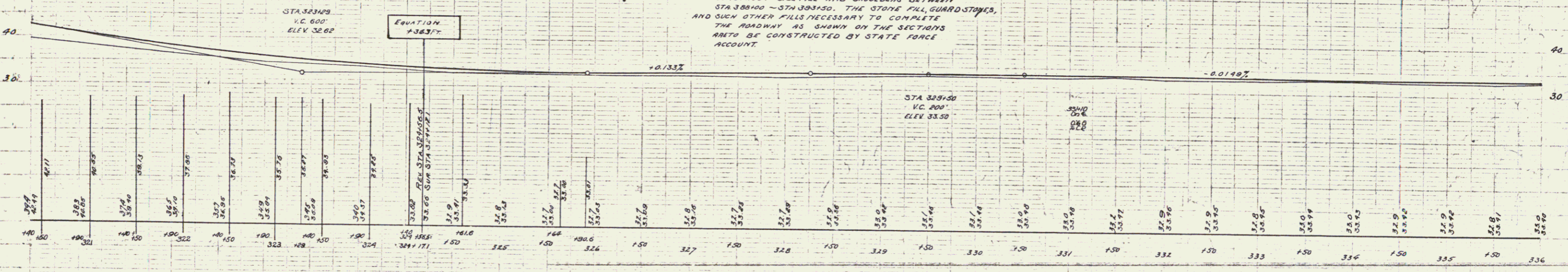

B.M. No. 42 Top of concrete bridge rail 11' ft. Sta 325+69 Elev. 36.10
 B.M. No. 43 spike in roof 18' Elm 13' ft. Sta 331+12 Elev. 32.60

SERIES F NOS 108A-36
 SHEET 19 OF 65