

WOOD GUARD RAIL REQUIRED
 CURVE STATION LEFT RIGHT
 121+50 24' 24'

NEW REINFORCED CONCRETE PIPE CULVERTS REQUIRED
 STATION DIA. LENS CONC. CEMENT MASONRY REINFORCING
 121+02 24' 40' 24" 18" 24' 34'

DRIVEWAY PIPE CULVERTS REQUIRED
 CONCRETE PIPE
 STATION DIA. LENS CEMENT MASONRY
 123+00 18" 20' 33" 24'

PER. ROAD DIST. NO.	STATE	PROJ. NO.	YEAR	SHEET NO.	TOTAL SHEETS
3	VT	106-A	1930	4	65

STATION	LANE	WIDTH	AREA	PRICE
122+80-123+10	L	3'-0"	10'-0"	10.50/100
122+80-123+10	R	3'-0"	10'-0"	10.50/100

POOR ORIGINAL COPY

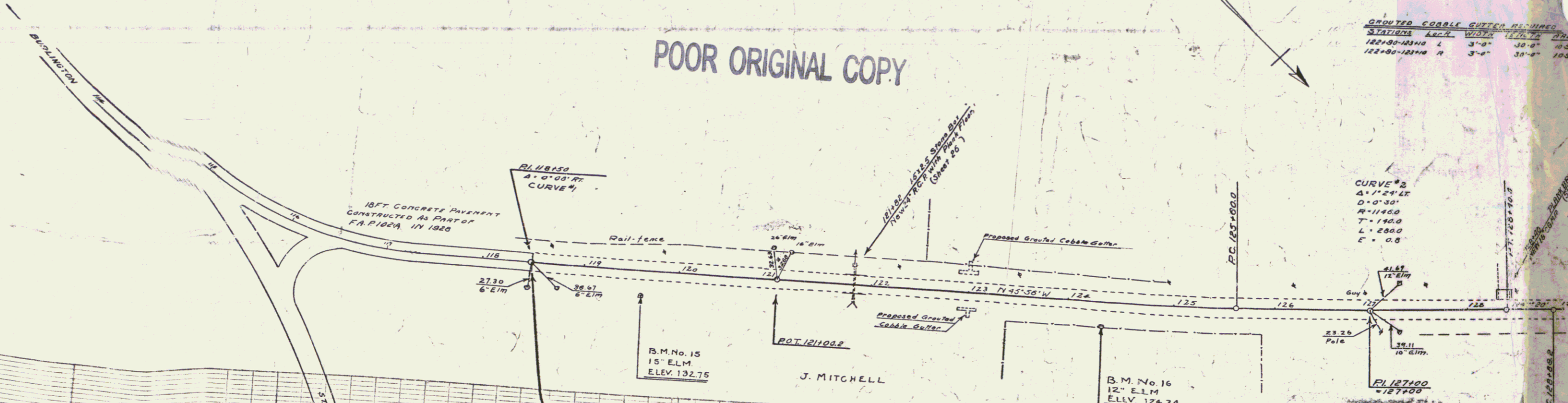

STATION 118+50
 BEGINNING OF CONTRACT
 BEGINNING OF F.A.R. 106A

NOTE - AT ALL CULVERTS THAT ARE REPLACED FROM BEGINNING OF PROJECT THROUGH STA. 176+40 EXISTING STONE BASE TO BE RELAID AND BACKFILL BETWEEN BASE AND CULVERT TO BE GRAVEL 3\"/>

STA 118+50 TO STA 176+40 ALL FILL UNDER PAVEMENT TO BE MADE FROM APPROVED BORROW AND NOT FROM EXCAVATION ENCOUNTERED ALONG THIS PROJECT.

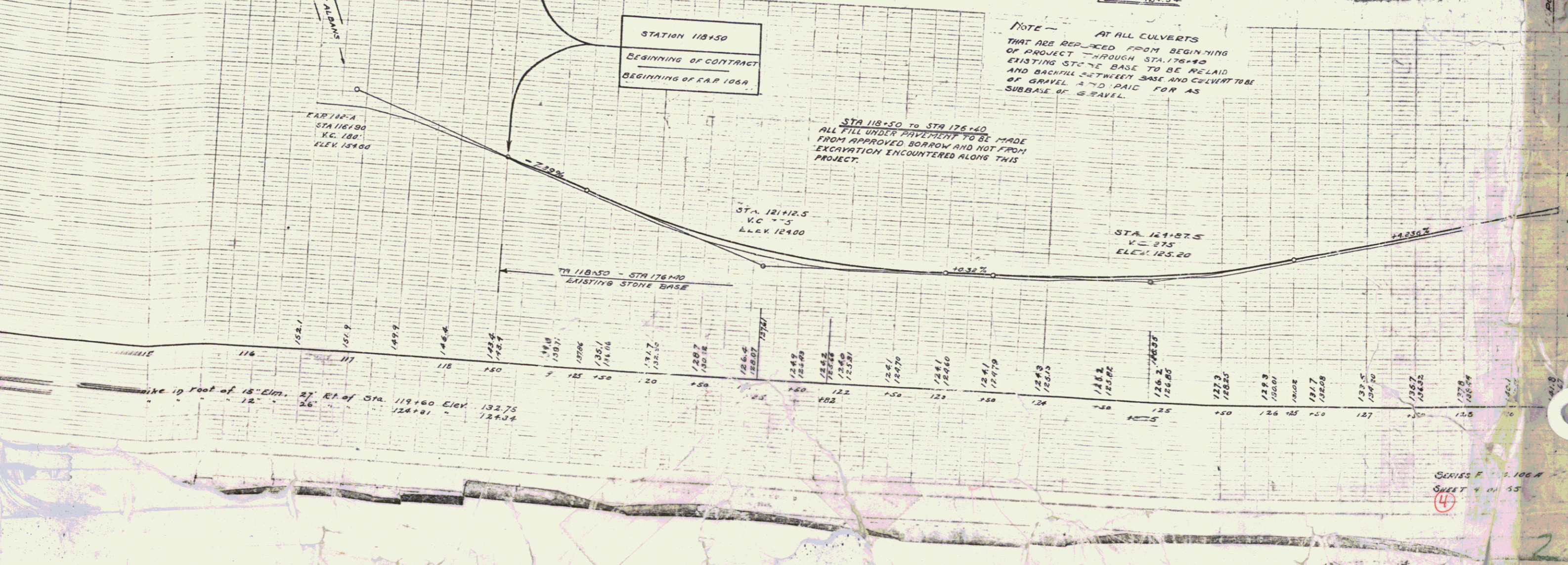

SERIES F 106-A
 SHEET 4 OF 55
 4