

**INDEX OF SHEETS**

SHEET NO. 1 TITLE PAGE

- 2 AND 3 ATYPICAL CROSS-SECTION OF IMPROVEMENT (ONE COURSE CEMENT CONCRETE PAVEMENT)
- 3 DETAILS OF CONSTRUCTION (CONCRETE PAVEMENT)
- 4-25 PLAN AND PROFILE SHEETS
- 26 STANDARD STRUCTURE SHEET-5-20-PIPE CULVERTS
- 27 STANDARD STRUCTURE SHEET-5-21-BOX CULVERTS
- 28 STANDARD STRUCTURE SHEET-5-22-GUARD RAIL, ETC.
- 28-A CONCRETE CRIBBING
- 29 STANDARD APPROACH SLAB WITH DROP INLET-S.B.-B
- 30 APPROACH SLAB FOR BRIDGE, STA. 437+78-STA. 438+20
- 31-65 CROSS SECTIONS

**STATE OF VERMONT  
STATE HIGHWAY DEPARTMENT**

**PLAN AND PROFILE OF PROPOSED  
STATE HIGHWAY**

FEDERAL AID PROJECT

**TOWNS OF COLCHESTER-MILTON-SO. HERO**  
**ISLAND ROAD**  
FROM "OLD CHIMNEY CORNER," WEST 6.751 MILES

| FED. ROAD DIST. NO. | STATE | PROJ. NO.                  | PLAN YEAR | SHEET NO. | TOTAL SHEETS |
|---------------------|-------|----------------------------|-----------|-----------|--------------|
| 9                   | VT.   | F.A.P. 106A<br>S.F.A. 128A | 1930      | 7         | 65           |

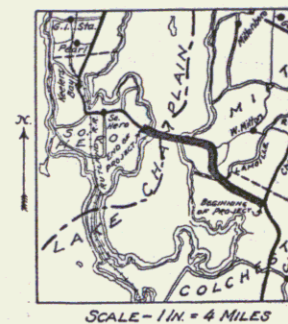

(To Be Returned to R.O.W. Division)  
US 2  
PERMANENT  
RIGHT-OF-WAY DIVISION

RE. US 2  
P.O. # 99R091

| PROJECT NO.          | GOV'T PARTICIPATION            |                     | NON-GOV'T PARTICIPATION |              | BRIDGE FEET |
|----------------------|--------------------------------|---------------------|-------------------------|--------------|-------------|
|                      | ROAD FEET                      | MILES               | ROAD FEET               | MILES        |             |
| F.A.P. 106A          | 20,147.1                       | 3.815+              | ~                       | ~            | ~           |
| F.A.P. 36 (Reopened) | 7,570.0                        | 1.433               | ~                       | ~            | ~           |
| F.A.P. 29 (Reopened) | 6,040.4                        | 1.144               | 358.0                   | 0.068        | 42.0        |
| S.F.A. 128A          | ~                              | ~                   | 1491.5                  | 0.282        | ~           |
| <b>TOTALS</b>        | <b>33,757.5</b>                | <b>6.392+</b>       | <b>1,849.5</b>          | <b>0.350</b> | <b>42.0</b> |
| <b>CONTRACT</b>      | <b>EXCL. BR. OVER 20' SPAN</b> | <b>3,5607.0 FT.</b> | <b>6.743 MI.</b>        |              |             |
|                      | <b>INCL. BR. OVER 20' SPAN</b> | <b>3,5649.0 FT.</b> | <b>6.751 MI.</b>        |              |             |

Due to US2 Relocation, length of US2 in Milton is now 3.686 miles.

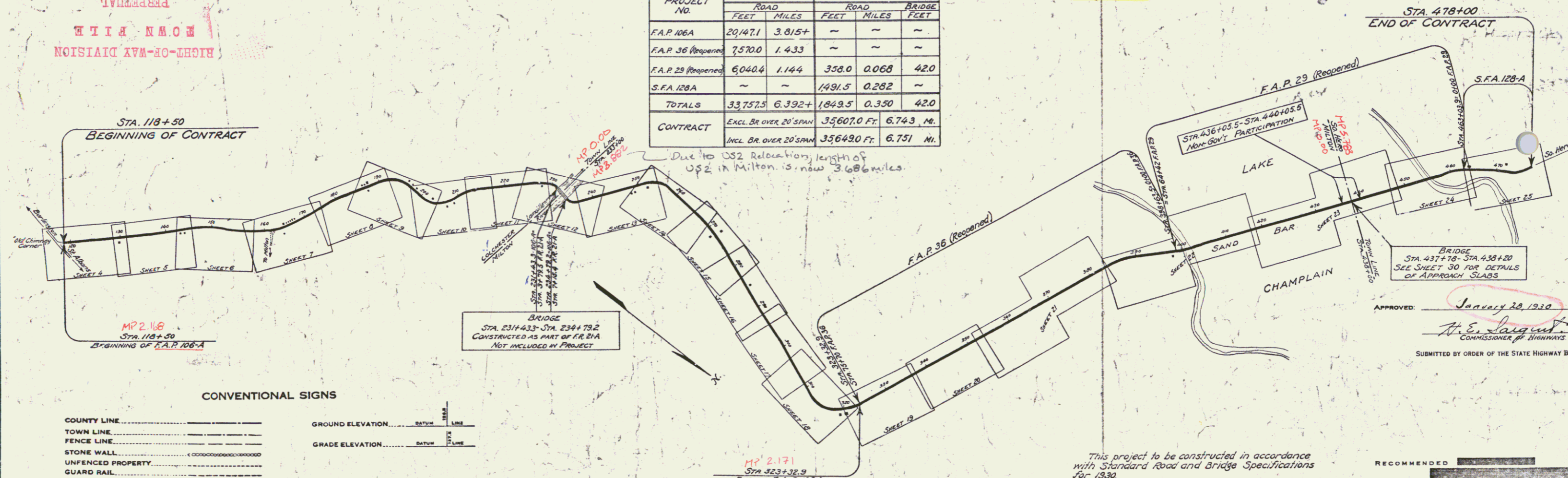

**CONVENTIONAL SIGNS**

|                   |                  |
|-------------------|------------------|
| COUNTY LINE       | GROUND ELEVATION |
| TOWN LINE         | GRADE ELEVATION  |
| FENCE LINE        |                  |
| STONE WALL        |                  |
| UNFENCED PROPERTY |                  |
| GUARD RAIL        |                  |
| TRAVELED WAY      |                  |
| RAILROAD          |                  |
| RETAINING WALL    |                  |
| CENTER LINE       |                  |
| SURVEY LINE       |                  |
| CULVERT           |                  |
| DROP INLET        |                  |
| TROLLEY POLE      |                  |
| POWER POLE        |                  |
| TELEPHONE POLE    |                  |
| TREES             |                  |
| HEDGE             |                  |

**CURVE DATA**

|                       |          |
|-----------------------|----------|
| DEFLECTION ANGLE      | Δ        |
| DEGREE OF CURVE       | D        |
| RADIUS OF CURVE       | R        |
| TANGENT DISTANCE      | T        |
| LENGTH OF CURVE       | L        |
| EXTERNAL DISTANCE     | E        |
| POINT OF INTERSECTION | P. I.    |
| POINT OF CURVE        | P. C.    |
| POINT OF TANGENT      | P. T.    |
| POINT ON TANGENT      | P. O. T. |

~ SCALES ~  
Layout - 1 in. = 1000 ft.  
Plan - 1 in. = 50 ft.  
Profile - Hor. - 1 in. = 50 ft.  
Vert. - 1 in. = 10 ft.  
Sections - 1 in. = 5 ft.

This project to be constructed in accordance with Standard Road and Bridge Specifications for 1930.

These plans are subject to such revisions as may be required by the Bureau of Public Roads or the Chief Engineer.

APPROVED: January 28, 1930  
H. E. Sargent  
COMMISSIONER OF HIGHWAYS

RECOMMENDED \_\_\_\_\_ DISTRICT ENGINEER BUREAU OF PUBLIC ROADS

RECOMMENDED FOR APPROVAL \_\_\_\_\_ CHIEF ENGINEER

APPROVED \_\_\_\_\_ DIRECTOR - BUREAU OF PUBLIC ROADS

Project No. F.A.P. 106A - F.A.P. 36 (R) - F.A.P. 29 (R) - S.F.A. 128A

PLANS COMPLETED JAN. 27, 1930

SERIES F. NO. 1 FILED SHEET 7 OF 65

DIST. # 5 PLANS