

Riprap for Bank Protection
Item 526
405+00 - 421+00 Lt ✓
413+50 - 416+50 Rt ✓

Three Cable Guard Rail with
Steel Posts - Item 343 Anchors
405+00 - 421+00 Lt ✓ 8 ✓
405+00 - 421+00 Rt ✓ 6 ✓

Construct Turnout;
413+50 - 416+50 Lt & Rt ✓

Remove & Re-setting of Present
Riprap Item 327
405+00 - 421+00 Lt ✓
413+50 - 416+50 Rt ✓

Rev Curve
Δ 0° 26' 23" Lt
D 0' 15"
R 22918.32
T 87.9
L 175.8
E 0.17
Do not bank

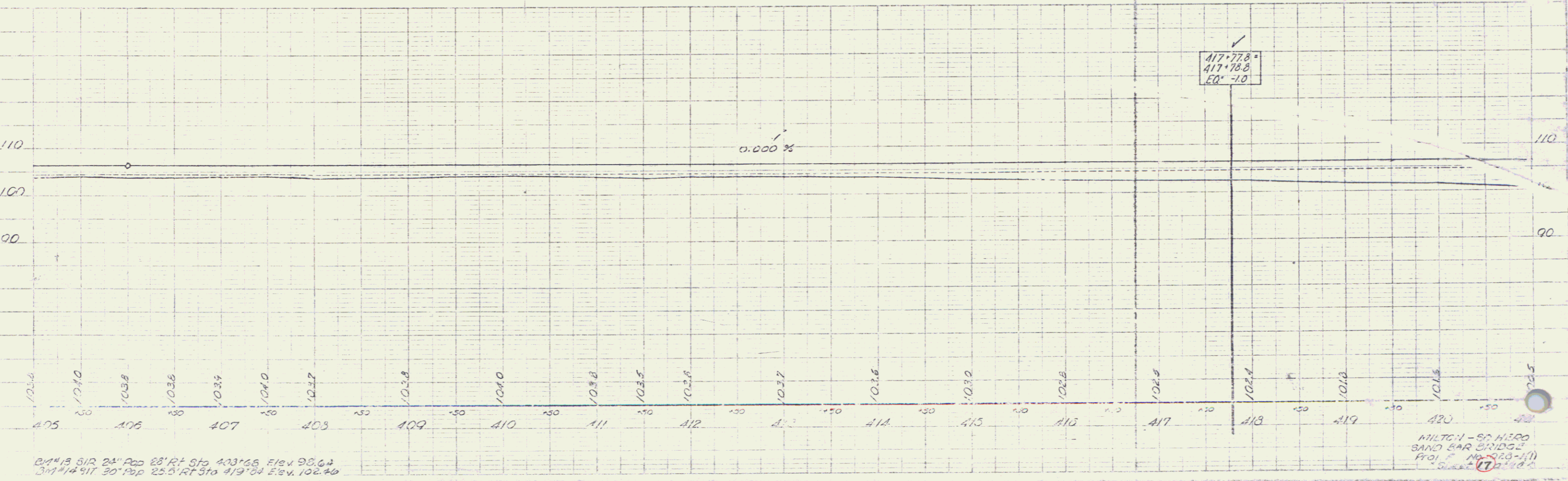
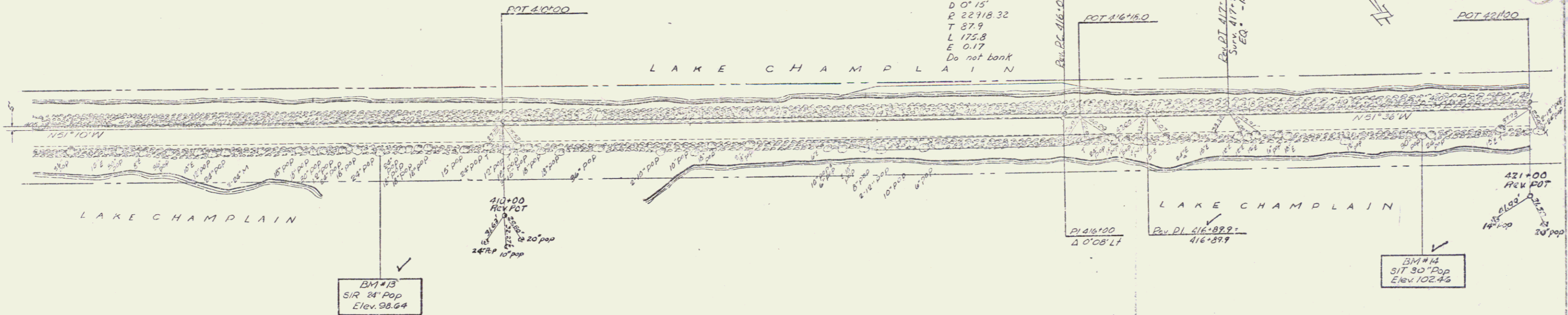

BM #13 SIR 24' Pop 28' Rt S/O 403+06 Elev 98.64
BM #14 917 30' Pop 25' Rt S/O 419+04 Elev 102.46

MILTON - SAND HERR
SAND BAR BRIDGE
PROJ. NO. 920-1(1)
Sheet 17 of 20

JUL 8 1974