

FED. ROAD DIST. NO.	STATE	PROJ. NO.	YEAR	SHEET NO.	TOTAL SHEETS
8	VT.	128-E		7	8

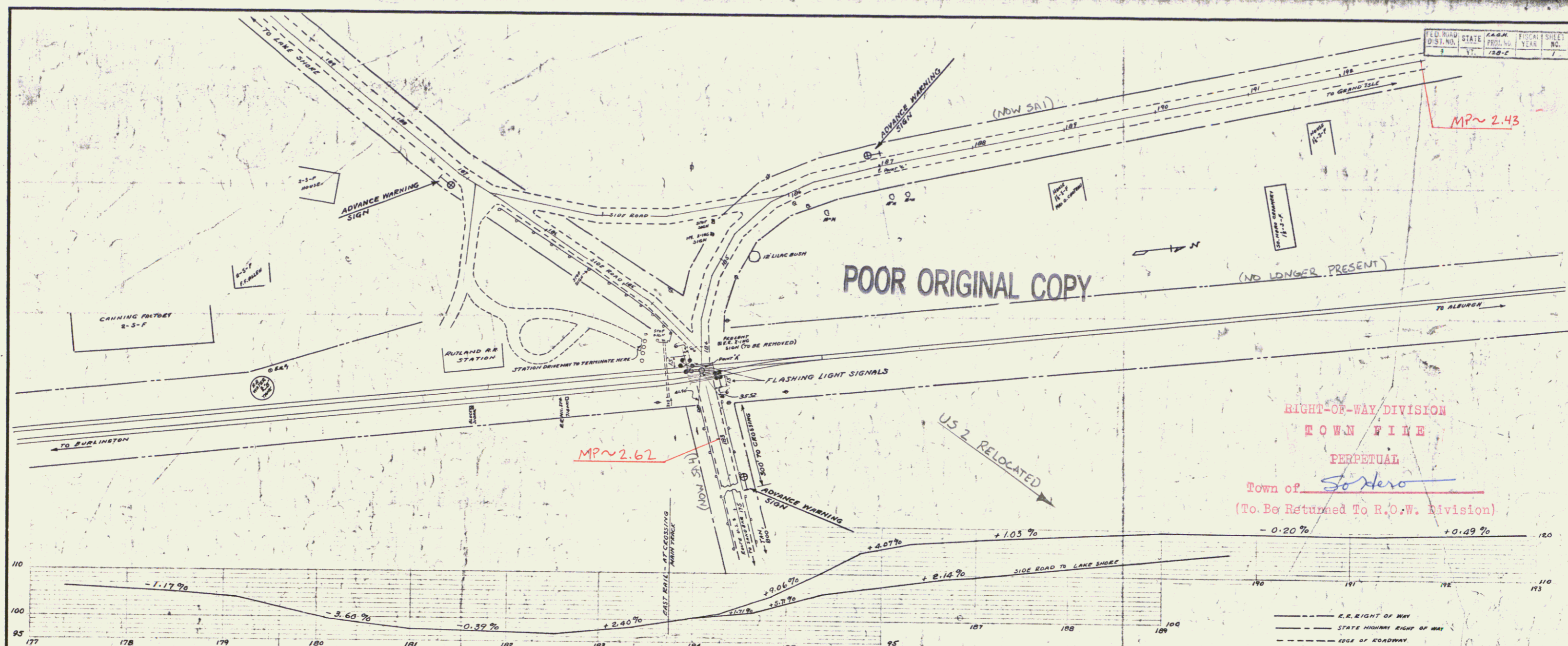

POOR ORIGINAL COPY

RIGHT-OF-WAY DIVISION
TOWN FINE
PERPETUAL
Town of South Hero
(To Be Returned To R.O.W. Division)

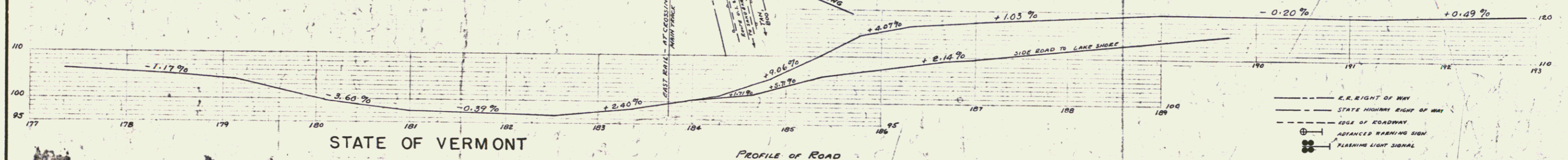

STATE OF VERMONT
STATE HIGHWAY DEPARTMENT
PLAN OF PROPOSED
RAILROAD GRADE CROSSING PROTECTION PROJECT
GRAND ISLE COUNTY

FEDERAL AID GRADE CROSSING PROJECT NO. F.A.G.H. 128-E US Route 2

LOCATED AT INTERSECTION OF RUTLAND RAILROAD AND ROUTE U.S. 2
AT MILEAGE STATION 183+75 IN THE TOWN OF SOUTH HERO.

RECOMMENDED [Signature]
DISTRICT ENGINEER BUREAU OF PUBLIC ROADS

RECOMMENDED FOR APPROVAL [Signature]
CHIEF ENGINEER BUREAU OF PUBLIC ROADS

APPROVED [Signature]
DIRECTOR BUREAU OF PUBLIC ROADS

APPROVED: A. J. Danvers 7-12-38
CHIEF ENGINEER
RUTLAND RAILROAD COMPANY
L. G. MORRIS, RECEIVER

APPROVED: H. S. Largent
COMMISSIONER OF HIGHWAYS

RAILROAD CROSSING SPURTIEN PLAN
SCALE 1" = 20'

Surveyed by W. A. D.
Designed by [Signature]
Drawn by [Signature]
Traced by [Signature]
Checked by [Signature]
Series F.A.G.H. No. 128-E
Sheet 7 of 8 Sheets