

SHEET NO.

1.	Title Page	
2-3.	Typical Sheets of Improvement, 3" Bit. Conc. Pavt., Mod.	
4-5.	Summary-Items	
6-7.	Item Detail and Drainage Sheet	
8-11.	Grades & Easements	
12-20.	P.O.W. Detail Sheets	
21-30.	Plan & Profile Sheets	
31.	Aspd Drilling Blasting of Solid Rock	1/17/69 R
32.	Banking Tables	7/17/67 R
33.	2-5 Typical Slope Grading	3/10/65
34.	3-6 Muck Excavation	3/10/65
35.	8-10 Embankment on a Slope	3/10/65
36.	2-11 Slope Stabilization	3/10/65
37.	C-1 Curbs & Bit. Conc. Sidewalk	10/23/68 R
38.	C-1a Precast Reinf. Cement Conc. Curb	3/10/65
39.	C-2a Granite Curb Drive Entrance	3/10/65
40.	D-2 Cement Rubble Masonry, Underdrain	4/18/69 R
41.	D-3 Jute Matting, Gutters	7/13/67 R
42.	D-4 Underdrain Flushing Basin	12/2/68 R
43.	D-6 Reinf. Conc. Drop Inlet in Branches	12/23/68
44.	D-8 Reinf. Conc. Drop Inlets	3/10/65
45.	D-9 Drop Inlet Tops	3/10/65
46.	D-10 Drop Inlet Tops	3/10/65
47.	D-11 Drop Inlet Tops	3/10/65
48.	D-16 Precast Drop Inlets	7/18/67 R
49.	E-31 Fed. Aid Const. Identification Sign	8/21/67 R
50.	E-32 Road Const. Approach Sign	1/1/67
51.	E-33 On-Project Construction Sign	5/13/67 R
52.	G-4 Marker Posts, Plank Guardrail	12/30/65 R
53.	G-6 Three Cable Gr/W/Lt. Steel Posts	3/21/68 R
54.	G-1 Project and Boundary Markers	3/10/65
55-60.	Blank	
61-64.	Mainline Cross Sections	
65.	60±50 Lt. Approach X-Secs.	
66.	52±48 Lt. Approach X-Secs.	
67-69.	52±48 Lt. Approach X-Secs.	

STATE OF VERMONT
DEPARTMENT OF HIGHWAYS
PROPOSED IMPROVEMENT

FEDERAL AID PROJECT
TOWN OF SOUTH HERO
COUNTY OF GRAND ISLE
U.S. ROUTE 2
BURLINGTON-ALBURG ROAD

Pin # 99R087

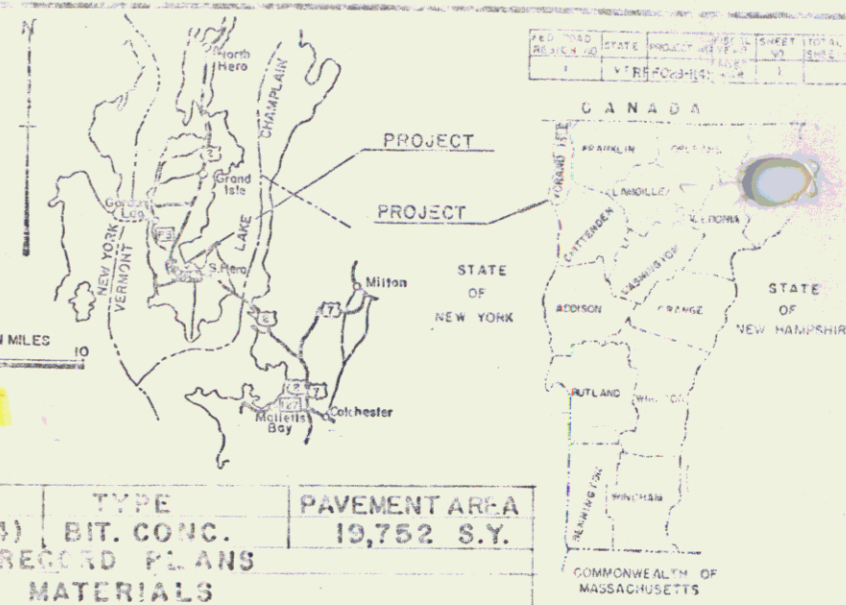

(To Be Returned to R.O.W. Division)
Town of South Hero
PERMIT
FROM FILE
RIGHT-OF-WAY DIVISION

BEGINNING AT A POINT 2.742 MILES WESTERLY OF THE MILTON-SO HERO TOWN LINE AT THE SO CALLED 'SAND BAR BRIDGE' AND EXTENDING WESTERLY AND NORTHERLY 1.403 MILES

LENGTH OF PROJECT 7,406.95 FEET=1.403 MILES

ADT 1968	2520-2720
ADT 1988	3910-4250
DHV 1988	590-540
D	60%
T	5%
V	50 MPH

PROJECT NAME & NUMBER	TYPE	PAVEMENT AREA
SOUTH HERO RFF-028-1(4)	BIT. CONC.	19,752 S.Y.
RECORD PLANS		
MATERIALS		
SUB-BASE OF SAND: MC DONALD PIT, MILTON, VT.		
SUB-BASE OF CRUSHED GRAVEL: LESSOR QUARRY,		
SUB-BASE OF CRUSHED ROCK: SOUTH HERO, VT.		
R.C.M. & CEMENT: S.T. GRISWOLD,		
CABLE FOR GUARD RAIL: WILLISTON, VT.		
C.A.A.C.B., C.G.M.R., A.C.C.G.M.P. & R.C.G.M.P.: NORTHEASTERN CULVERT CORP., WESTMINSTER, VT.		
REINFORCING STEEL: VT. STRUCTURAL STEEL CO., BURLINGTON, VT.		
VITRIFIED CLAY PIPE: R. BINSON CLAY PRODUCTS, ALBANY, VT.		
SLEEVES FOR WATER PIPES: CARPENTER SUPPLY CO. INC. COLCHESTER, VT.		
CAST IRON GRATES: L.L. LEBARON CO., BROCKTON, MASS.		
CUTBACK ASPHALT: ALL STATE ASPHALT, SUNDERLAND, MASS.		
CR. GRAVEL OR CR. STONE PLANT MIXED BASE COURSE AND BITUMINOUS CONCRETE PAVEMENT: L.M. PIKE, WILLISTON, VT.		
CONTRACTOR: BURNETT CONY. CO. INC.	CONTRACT DATED: JULY 24, 1968	
RESIDENT ENG: STEPHEN PIRO	CONTRACT STARTED: JULY 21, 1968	
INSPECTOR: R. MARTIN, R. HASBINS	CONTRACT COMPLETED: 12/22/68	
R. MAC NAIR	CONTRACT ACCEPTED: JULY 22, 1968	
RECORD PLANS: R.O. WASHBURN, JR.	2/19/70	

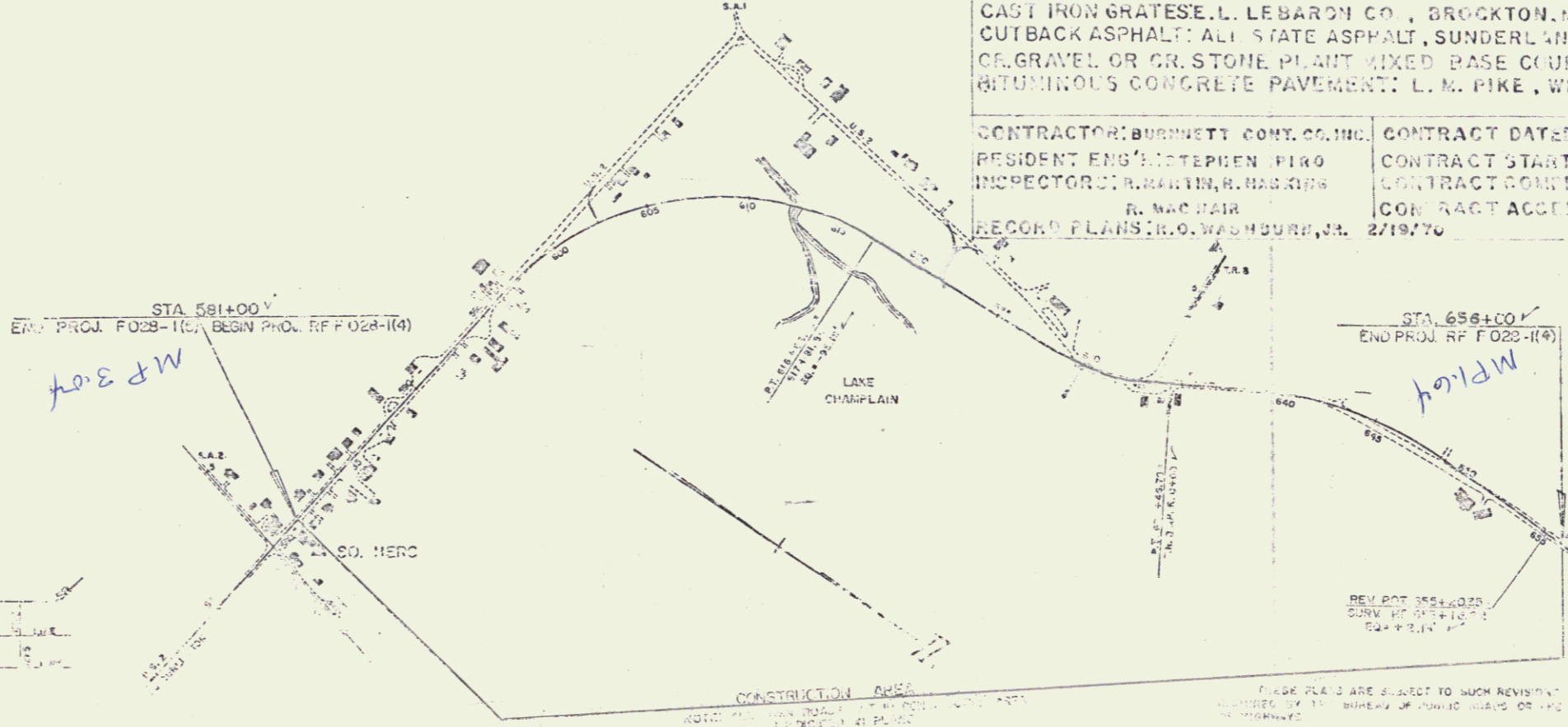

ADT 1968	2520-2720
ADT 1988	3910-4250
DHV 1988	590-540
D	60%
T	5%
V	50 MPH

CONTRACTOR: BURNETT CONY. CO. INC.
RESIDENT ENGINEER: STEPHEN PIRO
INSPECTOR: R. MARTIN, R. HASBINS
R. MAC NAIR
RECORD PLANS: R.O. WASHBURN, JR.

POOR ORIGINAL COPY

Project No RFF-028-1(4)
JUL - 8 1974

2.6/66