

• PLANTING • PLANT •
SCALE = 1 INCH EQUALS 20 FEET

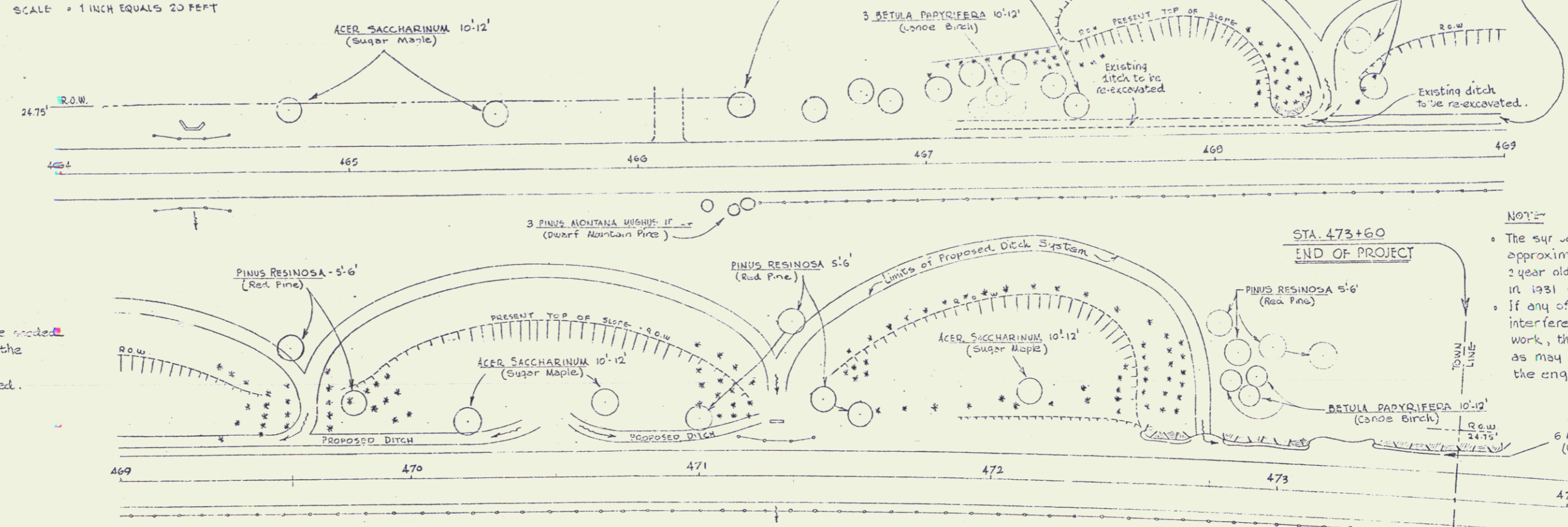

Shoulders to be seeded and seeded 35' inside on the proposed cross sections. Ditches to be seeded.

NOTES:
• The symbol indicates the approximate locations of 2 year old Red Pine planted in 1931.
• If any of these small trees interfere with the proposed work, they shall be transplanted as may be directed by the engineer.

472+50 - 473+60 L.T. 6 AMPLOPIS QUINQUEFIDA (Woodbine) spaced 10'

• TYPICAL •
• SECTIONS •

SCALE = 1 INCH EQUALS 5 FEET

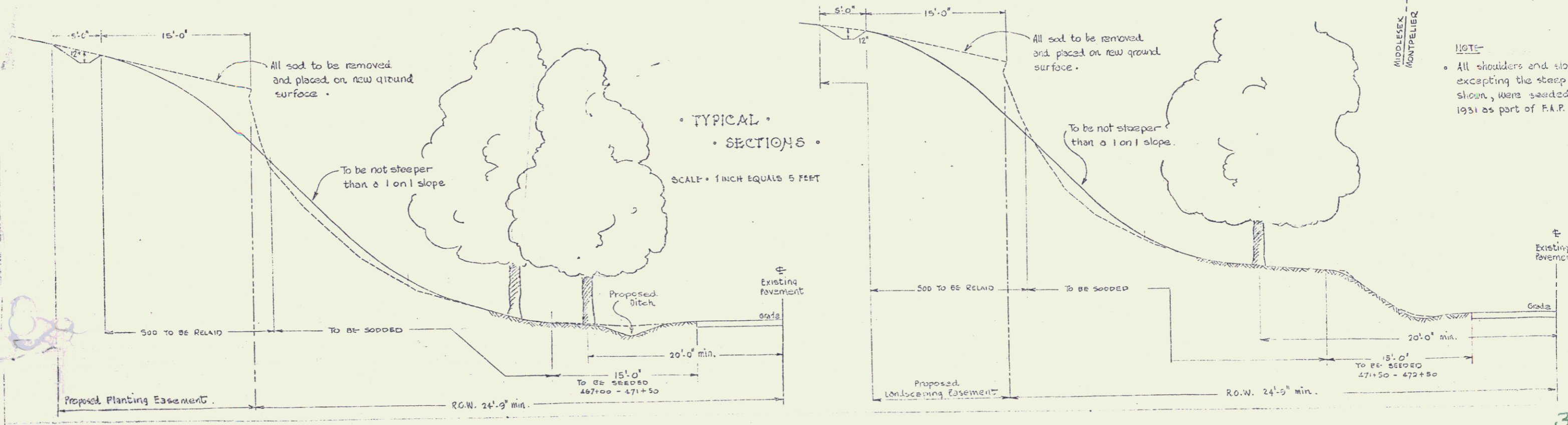

NOTES:
• All shoulders and slopes, excepting the steep cuts shown, were seeded in 1931 as part of F.A.P. 107 B.

SECTION 1
157-B (1)
LANDSCAPE
SHEET 3