

INDEX OF SHEETS

SHEET NO.	TITLE PAGE
" "	" 2 TYPICAL CROSS-SECTION OF IMPROVEMENT } ONE COURSE CEMENT CONCRETE PAVEMENT-TYPE B
" "	" 3 DETAILS OF CONSTRUCTION }
4-20	PLAN AND PROFILE SHEETS

STATE OF VERMONT  
STATE HIGHWAY DEPARTMENT

PLAN AND PROFILE OF PROPOSED  
STATE HIGHWAY

TOWNS OF BOLTON-WATERBURY  
BURLINGTON-MONTPELIER ROAD

Pin #99R082  
Project NRH 68C

FED. ROAD DIST. NO.	STATE	PROJ. NO.	FISCAL YEAR	SHEET NO.	TOTAL SHEETS
9	VT.	68-C	1929	1	1



SCALE - 1 INCH = 4 MILES

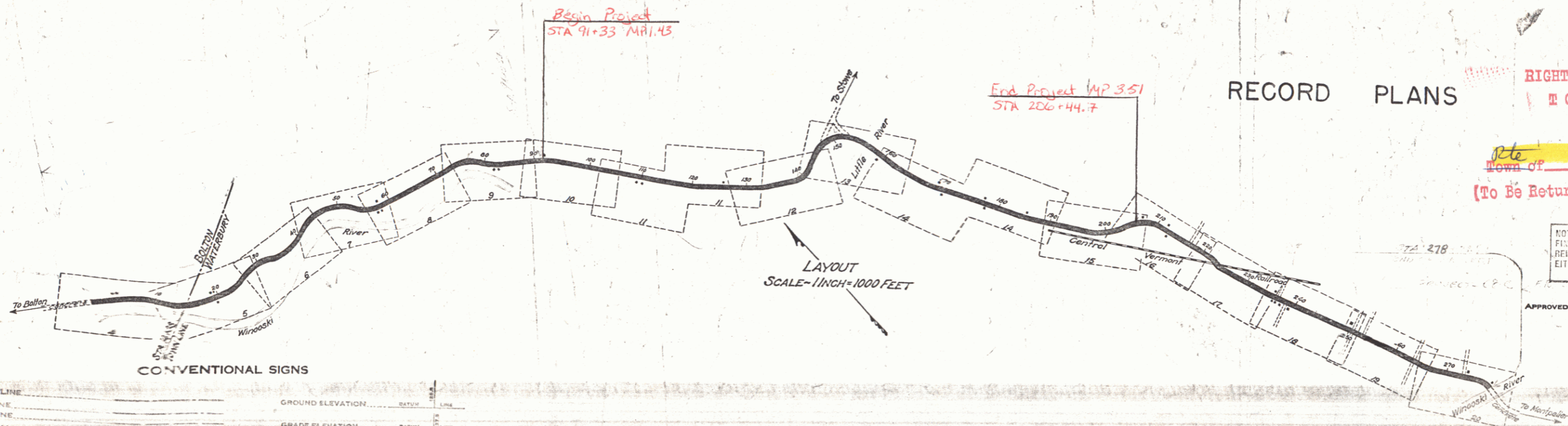

RECORD PLANS  
RIGHT-OF-WAY DIVISION  
TOWN FILE  
PERPETUAL  
Town of US 2  
(To Be Returned To R.O.W. Division)

NOTE: ANY FURTHER INFORMATION CONCERNING FINAL QUANTITIES, ADJUSTMENTS OR OTHER DETAILS RELATIVE TO THIS PROJECT MAY BE FOUND IN EITHER THE FIELD BOOKS OR THE ESTIMATE FILE.

CONVENTIONAL SIGNS

COUNTY LINE	GROUND ELEVATION	STATION LINE
TOWN LINE	GRADE ELEVATION	TOWN LINE
FENCE LINE		
STONE WALL		
UNFENCED PROPERTY		
GUARD RAIL		
TRAVELED WAY		
RAILROAD		

BOLTON-WATERBURY 68-C  
RECORD PLANS  
CONTR. FORCE ACCOUNT  
FISCAL YEAR

CURVE DATA

DEFLECTION ANGLE	Δ
DEGREE OF CURVE	D
RADIUS OF CURVE	R
TANGENT DISTANCE	T
LENGTH OF CURVE	L
EXTERNAL DISTANCE	E
POINT OF INTERSECTION	P. I.
POINT OF CURVE	P. C.
POINT OF TANGENT	P. T.
POINT ON TANGENT	P. O. T.

This Project to be constructed in accordance with Standard 1929 Specifications. These plans subject to such revisions as may be required by the Chief Engineer.

RECOMMENDED  
DISTRICT ENGINEER BUREAU OF PUBLIC ROADS  
RECOMMENDED FOR APPROVAL  
CHIEF ENGINEER BUREAU OF PUBLIC ROADS  
APPROVED  
DIRECTOR BUREAU OF PUBLIC ROADS

3/7/29  
DIST. #5 PLANS

SERIES No. 68-C FILED  
SHEET 1 OF 1