

FED. ROAD DIST. NO.	STATE	FED. AID PROJ. NO.	FISCAL YEAR	SHEET NO.	TOTAL SHEETS
9	VT	485	1967	24	68

WOOD GUARD RAIL REQUIRED LEFT

STA. 292+67 to 292+91 LENGTH 24 FT.
 STA. 295+00 to 296+12 " " "
 STA. 301+60 to 301+92 " " "
 STA. 303+36 to 303+60 " " "

CABLE GUARD RAIL REQUIRED RIGHT

STA. 292+60 to 295+00 LENGTH 640 FT.
 STA. 301+00 to 301+96 " " 88 "
 STA. 302+22 to 303+50 " " 128 "

NEW CULVERTS REQUIRED AND CULVERT REPAIRS

STA. 292+79 NEW STRAIGHT HEADWALL AT INLET. STRAIGHT WINGS AT OUTLET. CONC. CLASS B (1-2 1/2-5) 6.0 CU YDS. CONC. CLASS A (1-2-4) 1.5 CU YDS. REINF. STEEL 75 LBS.
 STA. 296+30 15" REINF. CONC. PIPE LENGTH 32 FT. CONC. CLASS B (1-2 1/2-5) 2.1 CU YDS. REINF. STEEL 33 LBS.
 STA. 301+20 15" REINF. CONC. PIPE LENGTH 36 FT. CONC. CLASS B (1-2 1/2-5) 2.1 CU YDS. REINF. STEEL 33 LBS.
 STA. 301+00 15" REINF. CONC. PIPE LENGTH 32 FT. CONC. CLASS B (1-2 1/2-5) 2.1 CU YDS. REINF. STEEL 33 LBS.
 STA. 303+43 18" REINF. CONC. PIPE LENGTH 32 FT. CONC. CLASS B (1-2 1/2-5) 2.7 CU YDS. REINF. STEEL 33 LBS.

GRAVEL SUB-BASE REQUIRED

STA. 301+50 to 303+50 LENGTH 200 FT. THICKNESS 6 IN.

PLAN

DATE	9/24
BY	A.A. DeG.
CHECKED	A.A. DeG.
SCALE	1" = 40'
PROJECT	WATERBURY
SHEET	24
TOTAL	68

PROFILE

DATE	9/24
BY	A.A. DeG.
CHECKED	A.A. DeG.
SCALE	1" = 40'
PROJECT	WATERBURY
SHEET	24
TOTAL	68

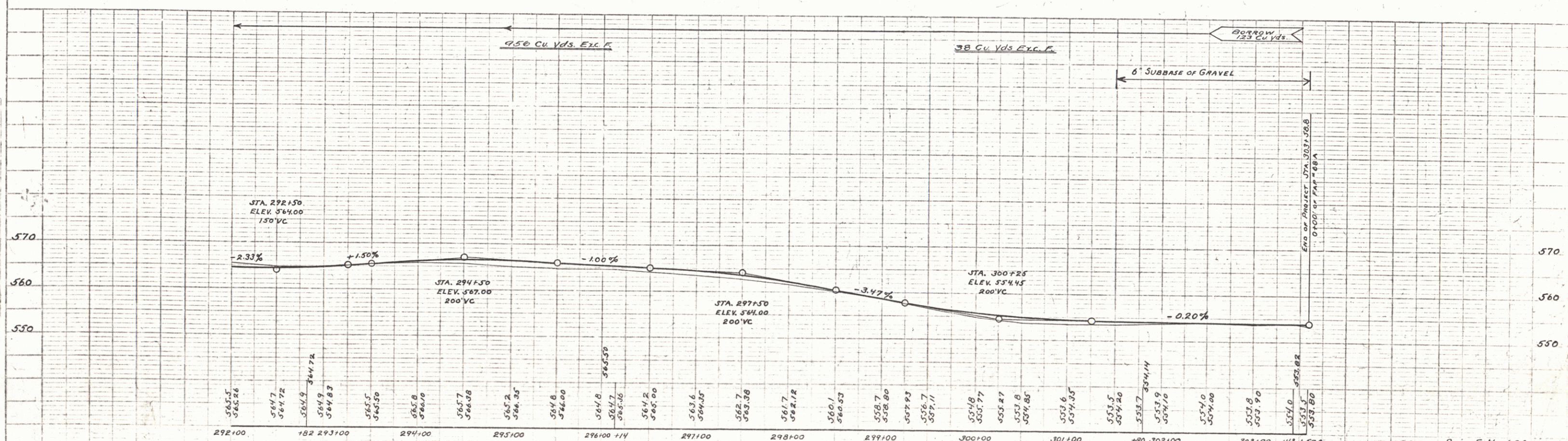
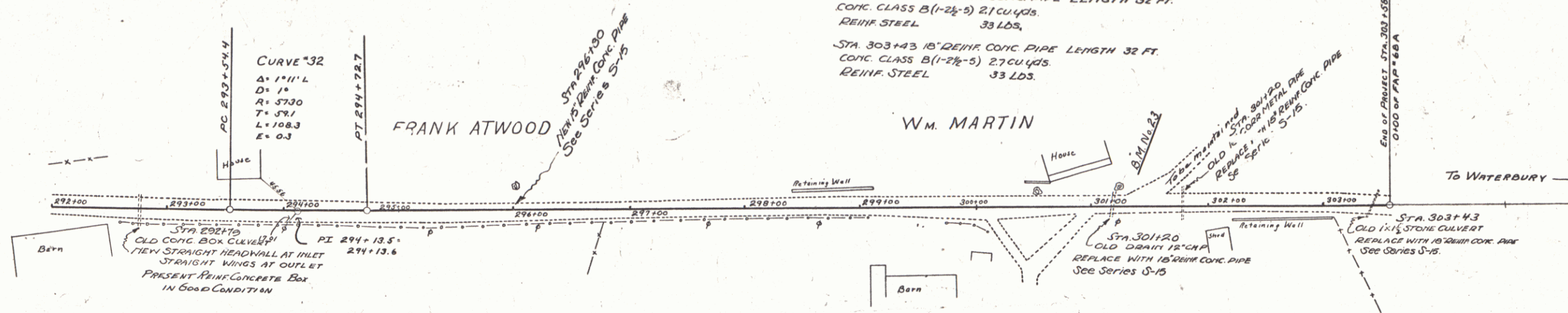

BM*23 SPIKE IN MAPLE RD LEFT STA 301+24 ELEV 554.79
 THIS IS ALSO BM*1 OF BOLTON-WATERBURY FAP 68A ELEV. 500.00

Series F No. 680
 SHEET 24 of 68