

|                     |       |                    |             |           |              |
|---------------------|-------|--------------------|-------------|-----------|--------------|
| FED. ROAD DIST. NO. | STATE | FED. AID PROJ. NO. | FISCAL YEAR | SHEET NO. | TOTAL SHEETS |
| 9                   | VT    | 685                | 1927        | 20        | 98           |

WOOD GUARD RAIL REQUIRED  
LEFT  
STA. 240+88 TO 241+12 LENGTH 24FT.

CABLE GUARD RAIL REQUIRED

NEW CULVERT REQUIRED  
STA 241+00 15 REINF CONC. PIPE LENGTH 32FT.  
CONC CLASS B (1 1/2" - 2) 21 CU YDS  
REINF. STEEL 33 Lbs.

SUB-BASE OF GRAVEL REQUIRED  
STA. 241+00 TO 247+00 LENGTH 600FT THICKNESS 6IN.

|      |      |        |         |
|------|------|--------|---------|
| PLAN | DATE | BY     | CHECKED |
|      | 9-24 | A.R.D. | A.R.D.  |
|      |      | W.B.M. | W.B.M.  |

|         |      |        |         |
|---------|------|--------|---------|
| PROFILE | DATE | BY     | CHECKED |
|         | 9-24 | A.R.D. | A.R.D.  |
|         |      | W.B.M. | W.B.M.  |

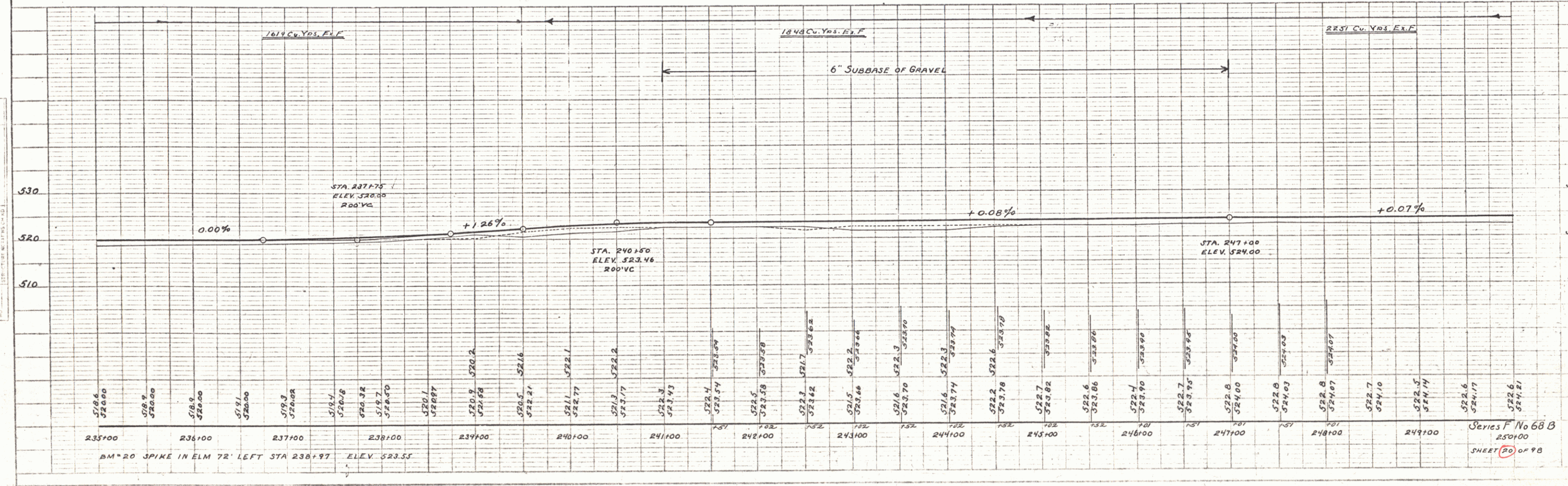
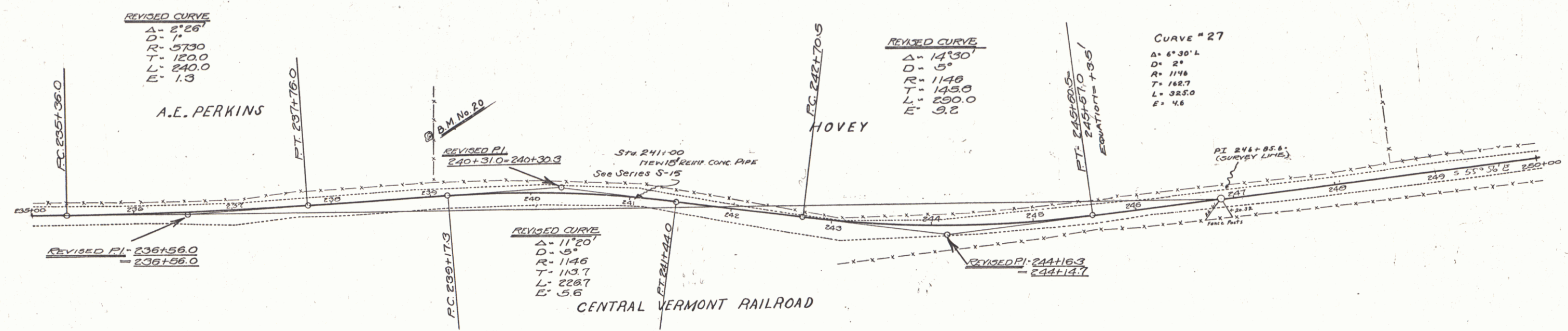

Series F No 68 B  
250+00  
SHEET 20 OF 98