

FED. ROAD DIST. NO.	STATE	FED. AID PROJ. NO.	FISC. YEAR
4	VT	000	19

WOOD GUARD RAIL REQUIRED  
RIGHT

STA. 21A+74 TO 21A+98 LENGTH 24 FT.

LEFT  
STA. 21A+74 TO 21A+98 LENGTH 24 FT.

NEW CULVERTS REQUIRED

STA 21A+86 5'-2" RAINF. CONC. RATE  
CONC. CLASS A (1-2-4) 5.20 Cu. Yds.  
REINF. STEEL 203 Lbs.

SUB-BASE OF GRAVEL REQUIRED.

STA. 206+00 TO 208+00 LENGTH 200 FT. THICK.

SHAPING COURSE REQUIRED

STA. 208+00 TO 215+00 LENGTH 700 FT.  
THICKNESS AS PER CROSS SECTIONS

PLAN	DATE	BY
9-26	1927	A. D. O'Sullivan
9-26	1927	W. B. G. Miller
9-27	1927	W. B. G.

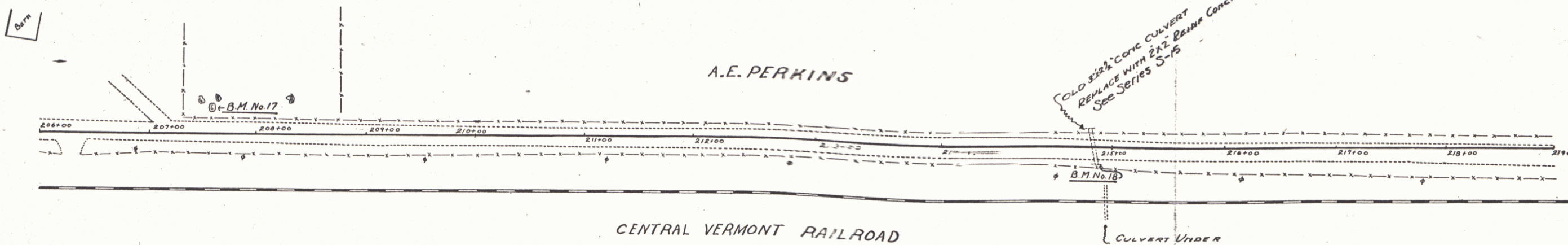

PROFILE	DATE	BY
9-26	1927	A. D. O'Sullivan
9-26	1927	W. B. G. Miller
9-27	1927	W. B. G.

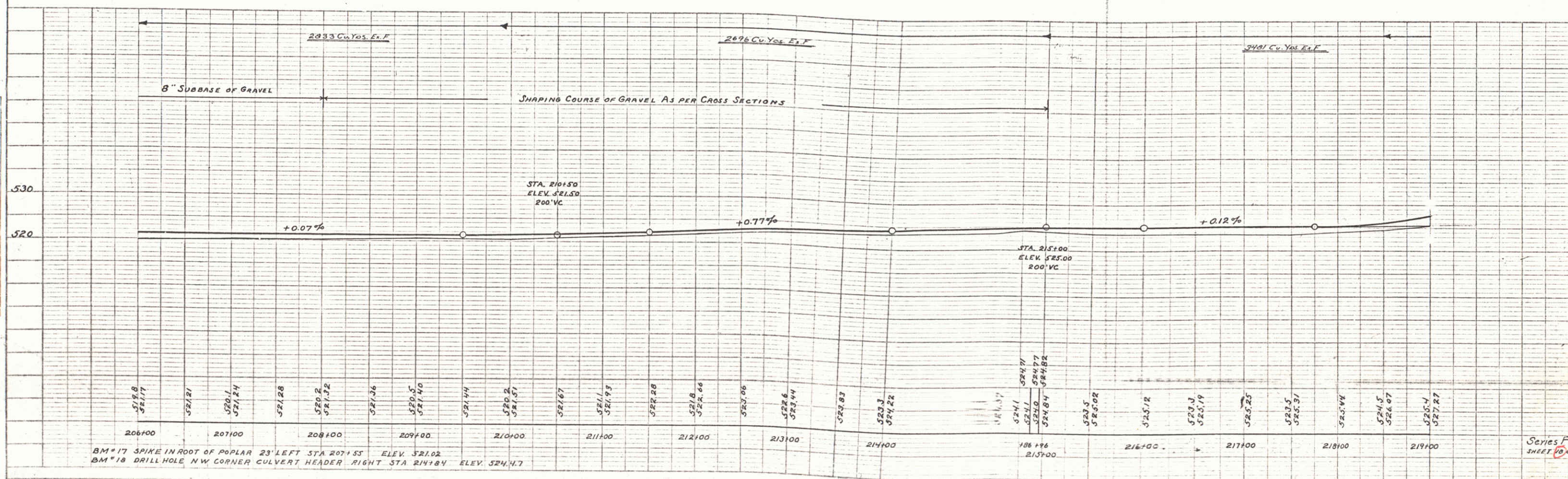

BM \* 17 SPIKE IN ROOT OF POPLAR 23' LEFT STA 207+53 ELEV. 521.02  
BM \* 18 DRILL HOLE N.W. CORNER CULVERT HEADER RIGHT STA 214+84 ELEV. 524.17

PLATE 1 - PLAN-PROFILE - 1/4\"/>

Series F  
SHEET 19