

FED. ROAD DIST. NO.	STATE	FED. AID PROJ. NO.	FISCAL YEAR	SHEET NO.	TOTAL SHEETS
4	VT	688	1927	9	98

Wood Guard Rail Required
 LEFT
 STA 22+38 TO 22+52 LENGTH 24 FT.
 STA 27+90 TO 28+00 LENGTH 10 FT.
 RIGHT
 STA 22+38 TO 22+42 LENGTH 24 FT.
 STA 27+90 TO 28+00 LENGTH 10 FT.
 TOTAL THIS SHEET 68 FT.

Cable Guard Rail Required
 RIGHT
 STA 14+00 TO 21+75 LENGTH 775 FT.
 LEFT
 STA 14+00 TO 15+20 LENGTH 120 FT.
 TOTAL THIS SHEET 895 FT.

New Culverts Required
 STA 22+50 15" REINF. CONCRETE PIPE LENGTH 32 FT.
 CONCRETE CLASS B (1-2 1/2-5) 2.1 C.Y.
 REINFORCING STEEL 33 LB.

STA 28+02 18" REINF. CONCRETE PIPE LENGTH 28 FT.
 CONCRETE CLASS B (1-2-4), REINFORCING STEEL 1.2 C.Y.
 60 LB.

Subbase of Gravel Required
 STA 19+00 TO 22+50 6" PEAS GR. SUBBASE LENGTH 350 FT.

New Culverts Required For Dams
 LEFT
 24+25 12" CORR. GALV. METAL PIPE LENGTH 28 FT.
 CONCRETE CLASS B (1-2 1/2-5) 1.5 C.Y.
 REINFORCING STEEL 33 LB.

Farm Road to be reconstructed on left and right at Sta 14+00 150 cu yds embankment allowed

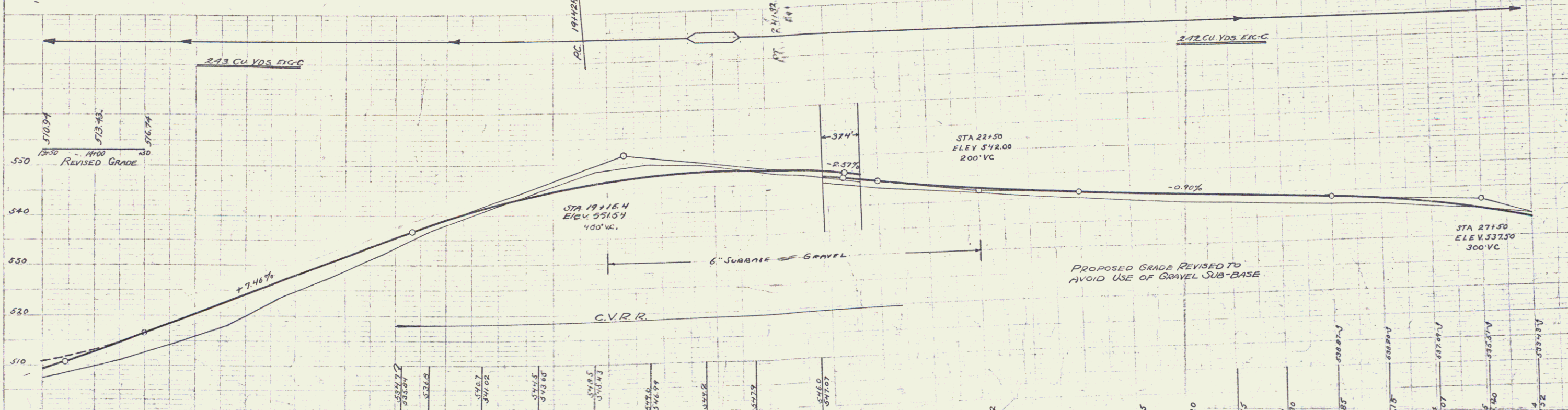
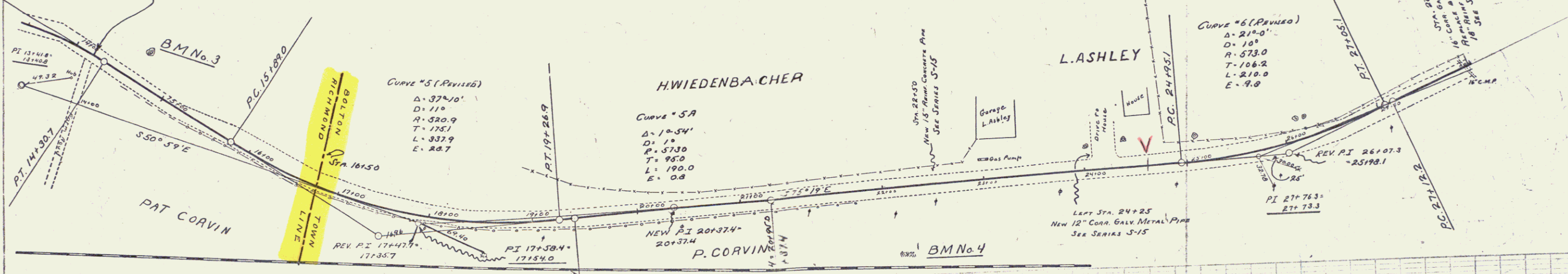

STATION	ELEVATION	STATION	ELEVATION	STATION	ELEVATION	STATION	ELEVATION
17+00	510.00	18+00	515.00	19+00	520.00	20+00	525.00
17+10	511.00	18+10	516.00	19+10	521.00	20+10	526.00
17+20	512.00	18+20	517.00	19+20	522.00	20+20	527.00
17+30	513.00	18+30	518.00	19+30	523.00	20+30	528.00
17+40	514.00	18+40	519.00	19+40	524.00	20+40	529.00
17+50	515.00	18+50	520.00	19+50	525.00	20+50	530.00
17+60	516.00	19+00	521.00	20+00	526.00	21+00	531.00
17+70	517.00	19+10	522.00	20+10	527.00	21+10	532.00
17+80	518.00	19+20	523.00	20+20	528.00	21+20	533.00
17+90	519.00	19+30	524.00	20+30	529.00	21+30	534.00
18+00	520.00	19+40	525.00	20+40	530.00	21+40	535.00
18+10	521.00	19+50	526.00	20+50	531.00	21+50	536.00
18+20	522.00	20+00	527.00	21+00	532.00	22+00	537.00
18+30	523.00	20+10	528.00	21+10	533.00	22+10	538.00
18+40	524.00	20+20	529.00	21+20	534.00	22+20	539.00
18+50	525.00	20+30	530.00	21+30	535.00	22+30	540.00
18+60	526.00	20+40	531.00	21+40	536.00	22+40	541.00
18+70	527.00	20+50	532.00	21+50	537.00	22+50	542.00
18+80	528.00	21+00	533.00	22+00	538.00		
18+90	529.00	21+10	534.00	22+10	539.00		
19+00	530.00	21+20	535.00	22+20	540.00		
19+10	531.00	21+30	536.00	22+30	541.00		
19+20	532.00	21+40	537.00	22+40	542.00		
19+30	533.00	21+50	538.00	22+50	543.00		
19+40	534.00	22+00	539.00				
19+50	535.00	22+10	540.00				
19+60	536.00	22+20	541.00				
19+70	537.00	22+30	542.00				
19+80	538.00	22+40	543.00				
19+90	539.00	22+50	544.00				
20+00	540.00						
20+10	541.00						
20+20	542.00						
20+30	543.00						
20+40	544.00						
20+50	545.00						
21+00	546.00						
21+10	547.00						
21+20	548.00						
21+30	549.00						
21+40	550.00						
21+50	551.00						
22+00	552.00						
22+10	553.00						
22+20	554.00						
22+30	555.00						
22+40	556.00						
22+50	557.00						

Series F No. 688
 Street 5 of 98