

INDEX OF SHEETS

- 1. TITLE PAGE
- 2. TYPICAL CROSS-SECTION OF IMPROVEMENT ONE COURSE CEMENT CONCRETE PAVEMENT-TYPE B
- 3. DETAILS OF CONSTRUCTION
- 4-20. LAYOUT PLANS
- 21
- 22
- 23
- 24
- 25

STATE OF VERMONT  
STATE HIGHWAY DEPARTMENT

PLAN AND PROFILE OF PROPOSED  
STATE HIGHWAY

TOWNS OF BOLTON-WATERBURY  
BURLINGTON-MONTPELIER ROAD

Proj 99R079  
Project NRH 68A  
Route V52

FED. ROAD DIST. NO.	STATE	PROJ. NO.	FISCAL YEAR	SHEET NO.	TOTAL SHEETS
9	VT.	68-C	1929	1	

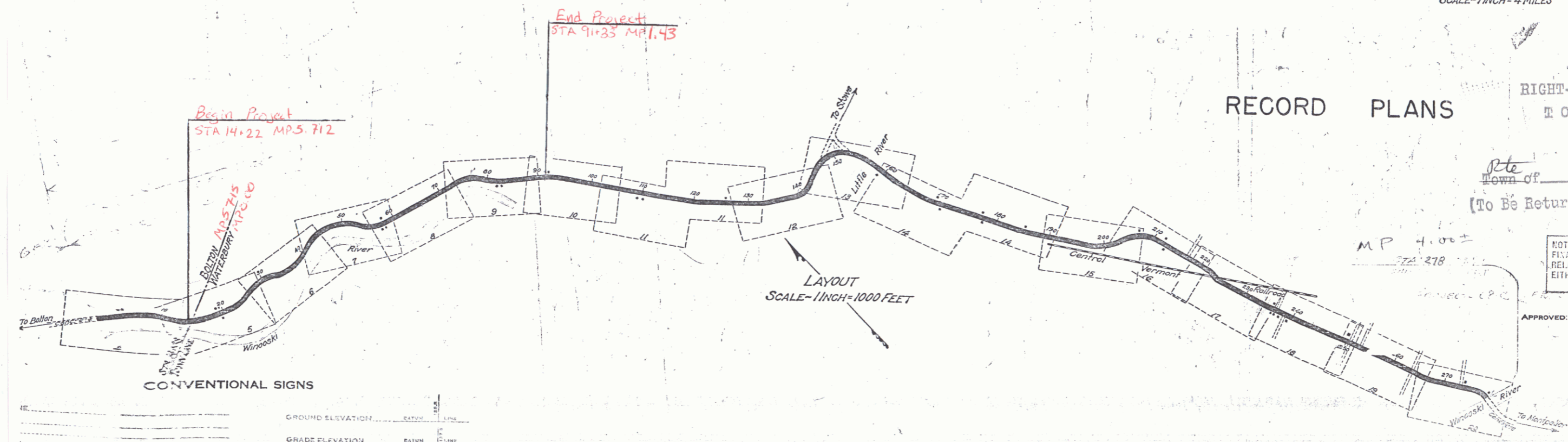
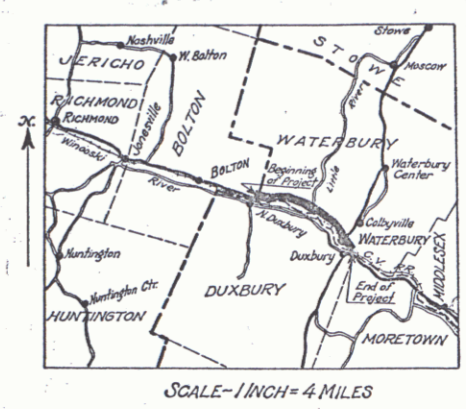

RECORD PLANS

RIGHT-OF-WAY DIVISION  
TOWN FILE

PERPETUAL  
Rte. US 2  
Town of US 2  
(To Be Returned To R.O.W. Division)

NOTE: ANY FURTHER INFORMATION CONCERNING FINAL QUANTITIES, AMOUNTS OR OTHER DETAILS RELATIVE TO THIS PROJECT MAY BE FOUND IN EITHER THE FIELD BOOKS OR THE ESTIMATE FILE.

CONVENTIONAL SIGNS

GROUND ELEVATION.....	FOOT	INCH
GRADE ELEVATION.....	FOOT	INCH

PROPERTY

BOLTON-WATERBURY 68-C  
RECORD PLANS  
CONTR. FORCE ACCOUNT  
FISCAL YEAR 1930

CURVE DATA	
DEFLECTION ANGLE.....	Δ
DEGREE OF CURVE.....	D
RADIUS OF CURVE.....	R
TANGENT DISTANCE.....	T
LENGTH OF CURVE.....	L
EXTERNAL DISTANCE.....	E
POINT OF INTERSECTION.....	P. I.
POINT OF CURVE.....	P. C.
POINT OF TANGENT.....	P. T.
POINT ON TANGENT.....	P.O.T.

This Project to be constructed in accordance with Standard 1929 Specifications. These plans subject to such revisions as may be required by the Chief Engineer.

RECOMMENDED [Signature] DISTRICT ENGINEER BUREAU OF PUBLIC ROADS

RECOMMENDED FOR APPROVAL [Signature] CHIEF ENGINEER BUREAU OF PUBLIC ROADS

APPROVED [Signature] DIRECTOR - BUREAU OF PUBLIC ROADS

3/7/29

DIST. # 5 PLANS

SERIES No. 68-C FILED SHEET 1 OF 1