

WOOD GUARD RAIL REQUIRED
ON LEFT
STA 196+29 TO STA 196+53 LENGTH 24 FT
ON RIGHT
STA 196+29 TO STA 196+53 LENGTH 24 FT

CABLE GUARD RAIL REQUIRED
ON RIGHT
STA 197+22 TO STA 199+39 LENGTH 216 FT
" 202+20 TO " 203+24 " 104 FT

NEW CULVERTS REQUIRED
Sta. 196+41 16" Cast Iron Pipe 36 ft.
Conc. Class B (1-2 1/2-s) 2.7 cu yds
Reinforcing Steel 33 lbs

NEW DRIVEWAY CULVERTS REQUIRED
Sta. 192+20 Left 12" CGMP 28 ft.
Conc. Class B (1-2 1/2-s) 1.1 cu yds

PROJ. NO.	DATE	SCALE	SHEET NO.	TOTAL SHEETS
103-A	1928	1" = 40'	16	73

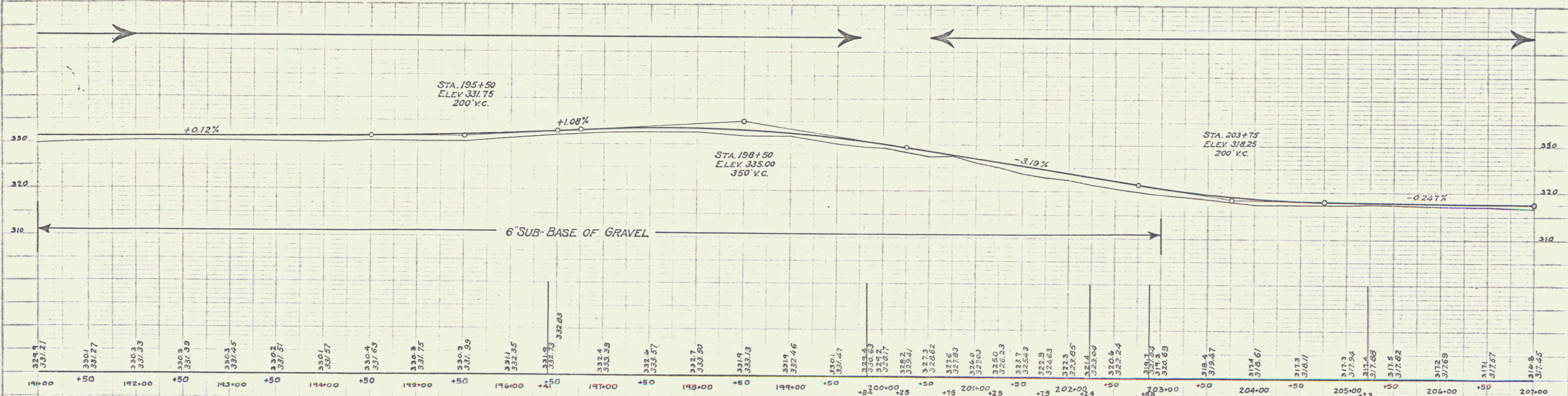
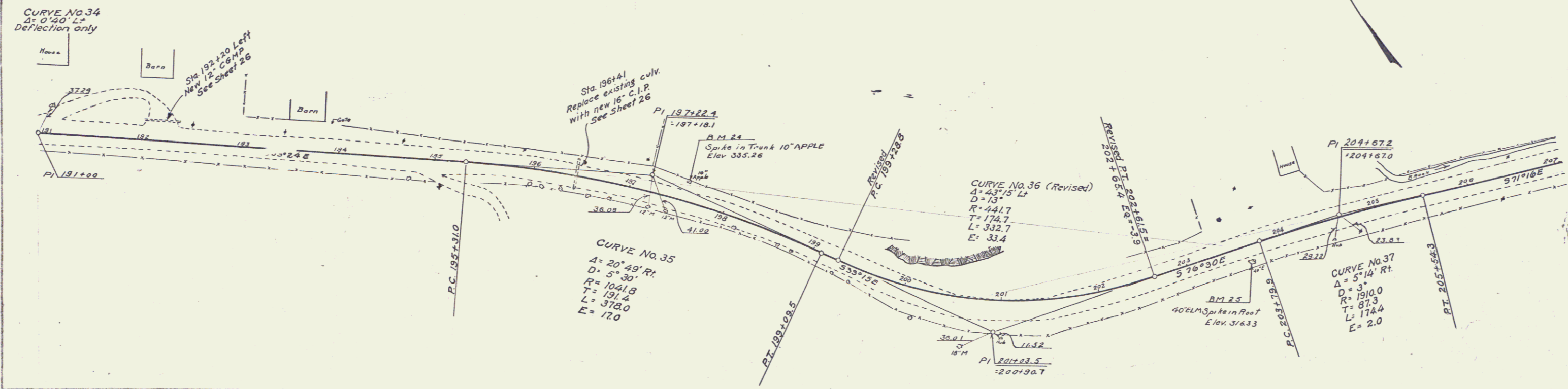

BM #24 SPIKE IN TRUNK OF 10' APPLE LT STA. 197+22 ELEV 335.26
BM #25 SPIKE IN ROOT OF 40' ELM RT STA. 203+24 ELEV 316.33

SERIES F NO. 103 A
SHEET NO. 16 OF 73

17