

WOOD GUARD RAIL REQUIRED
 ON LEFT
 STA. 163+28 TO STA. 163+52 LENGTH 24 FT.
 " 166+42 TO " 166+66 " 24 FT.
 ON RIGHT
 STA. 163+28 TO STA. 163+52 LENGTH 24 FT.
 " 166+42 TO " 166+66 " 24 FT.

CABLE GUARD RAIL REQUIRED
 ON LEFT
 STA. 169+08 TO STA. 170+44 LENGTH 136 FT.
 ON RIGHT
 STA. 168+38 TO STA. 169+74 LENGTH 136 FT.

NEW CULVERTS REQUIRED

Sta. 163+40 3x3 Reinf. Conc. Box 35 ft.
 Concrete Class A (1-2-4) 16.8 cu yds
 Reinforcing Steel 1044 lbs.

Sta. 169+37 3x4 Reinf. Conc. Box 43 ft.
 Concrete Class A (1-2-4) 23.2 cu yds
 Reinforcing Steel 1470 lbs.

Sta. 166+54 24" Cast Iron Pipe 32 ft.
 Concrete Class A (1-2-4) 2.6 cu yds
 Reinforcing Steel 54 lbs.

A.A. DOE
 C.H. LOOK
 3/1/25

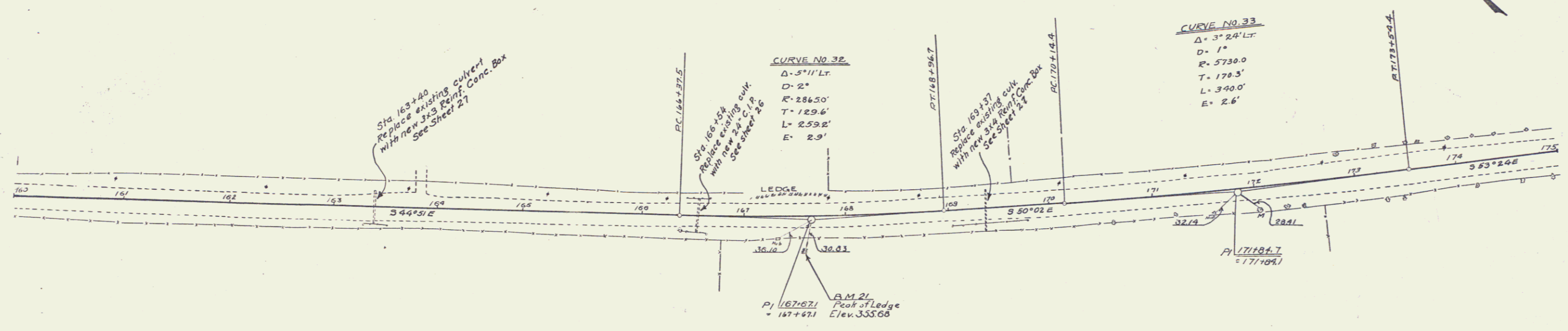

A.A. DOE
 J.A. WILLIAMS
 3/1/25

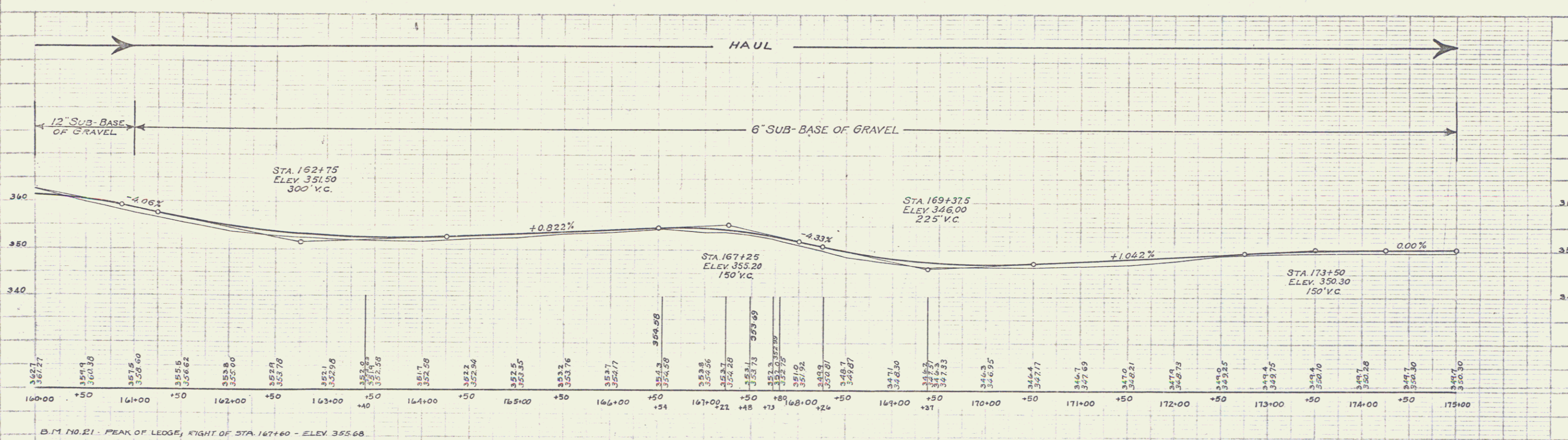

15