

**WOOD GUARD RAIL REQUIRED**

ON LEFT  
 STA. 30+67 TO STA 30+91 LENGTH 24 FT  
 33+26 TO 33+50 " 24 FT  
 40+22 TO 40+46 " 24 FT  
 ON RIGHT  
 STA 30+67 TO STA 30+91 LENGTH 24 FT  
 33+26 TO 33+50 " 24 FT  
 40+26 TO 40+50 " 24 FT

**NEW CULVERTS REQUIRED**

STA. 40+36 3x4 REINFORCED CONCRETE BOX 35 LIN FT  
 CONCRETE CLASS A (1-2-4) 193 CU YDS.  
 REINFORCING STEEL  
 STA 30+79 30" CAST IRON PIPE 32 LIN FT  
 CONCRETE CLASS A (1-2-4) 3.5 CU YDS.  
 REINFORCING STEEL 58 LBS  
 STA 33+30 16" CAST IRON PIPE 36 LIN FT  
 CONCRETE CLASS B (1-2 1/2-5) 2.7 CU YDS.  
 REINFORCING STEEL 33 LBS

**CABLE GUARD RAIL REQUIRED**

ON RIGHT  
 STA. 36+35 TO STA. 37+79 LENGTH 144 FT.

FED. ROAD DIST. NO.	STATE	PROJ. NO.	FILE NO.	SHEET NO.	TOTAL SHEETS
				103-A	73

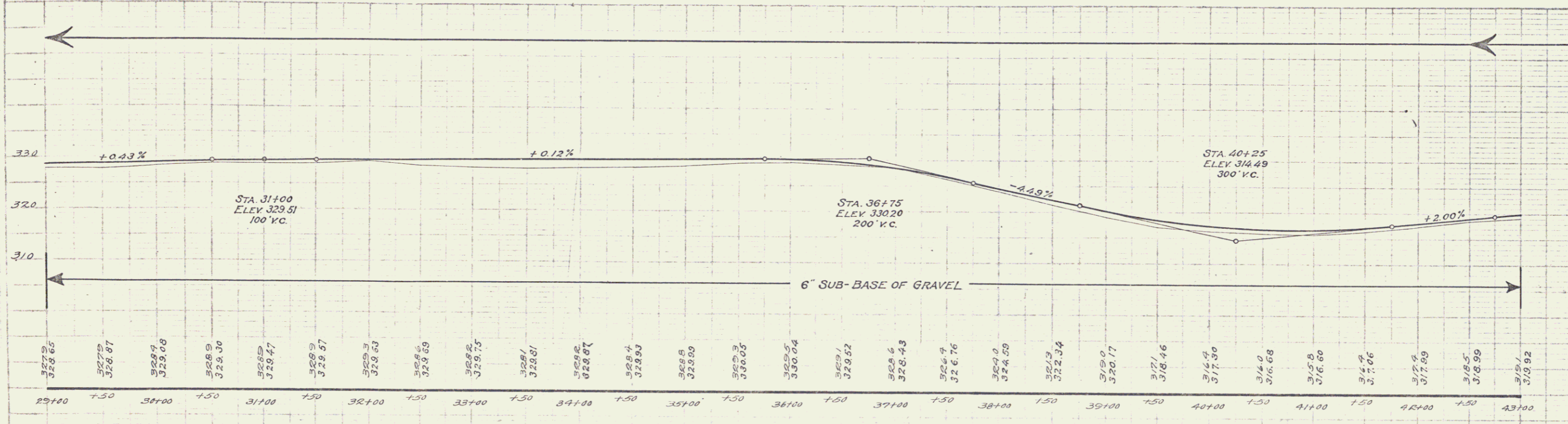
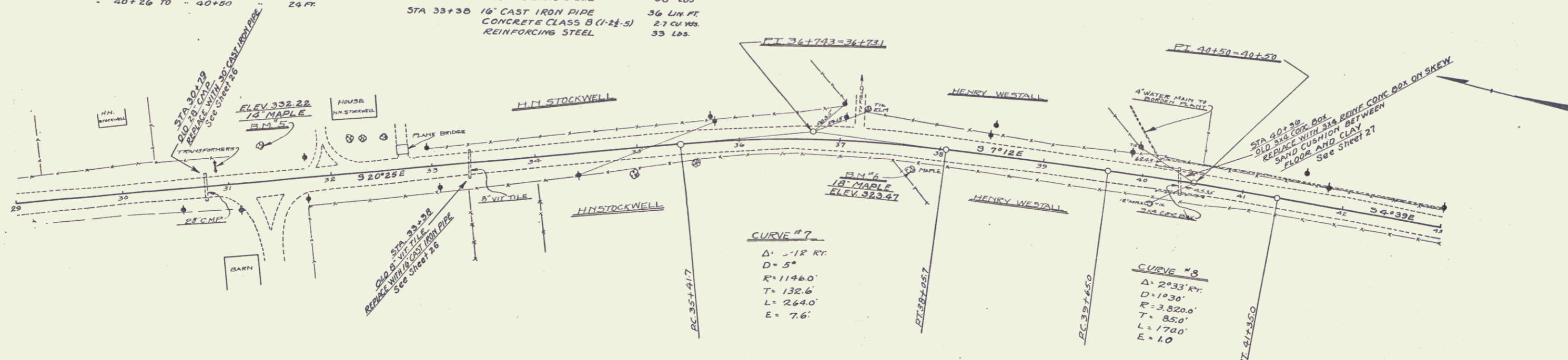

B.M. #5 - SPIKE IN TRUNK 14" MAPLE, LEFT STA 31+35, ELEV 332.22  
 B.M. #6 - SPIKE IN ROOT 18" MAPLE, RIGHT STA 37+72, ELEV 323.47