

NOTE  
Wood Guard Rail shall be erected as ordered by the Engineer to prevent any hazard that may have been caused by removing present overpass.

NOTE: All guard rail now in place on this project except that designated to be reset is to be removed and is to become the property of the State of Vermont.

SPECIAL PROVISION  
The contractor will be required to remove the old embankment down to the natural ground level from the present overpass back to Sta. 12+00±

SPECIAL PROVISION  
The contractor will not be permitted to remove the present concrete pavement until after traffic has been diverted to the projects in their new relocation through their entire lengths.

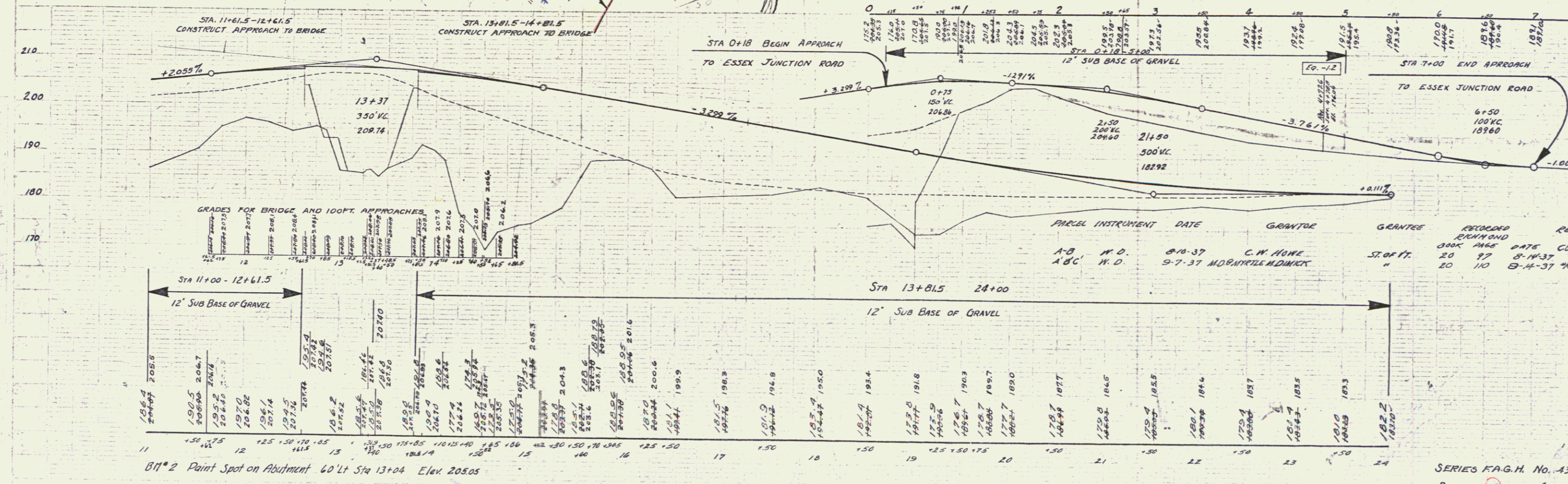

B11\*2 Paint Spot on Abutment 60' Lt Sta 13+04 Elev 205.05