

GUARD RAIL REQUIRED ON LEFT  
 Sta. 13+08 To 15+00 Length 192ft.  
 CONCRETE RIP-RAP ON RIGHT  
 Sta. 14+00 To 15+00 Length 100ft.  
 TOTAL THIS SHEET 192ft.

NO.	DATE	BY	REVISION
1	11/17	J.P. HARRIS	DESIGN
2	11/17	J.P. HARRIS	REVISED
3	11/17	J.P. HARRIS	REVISED

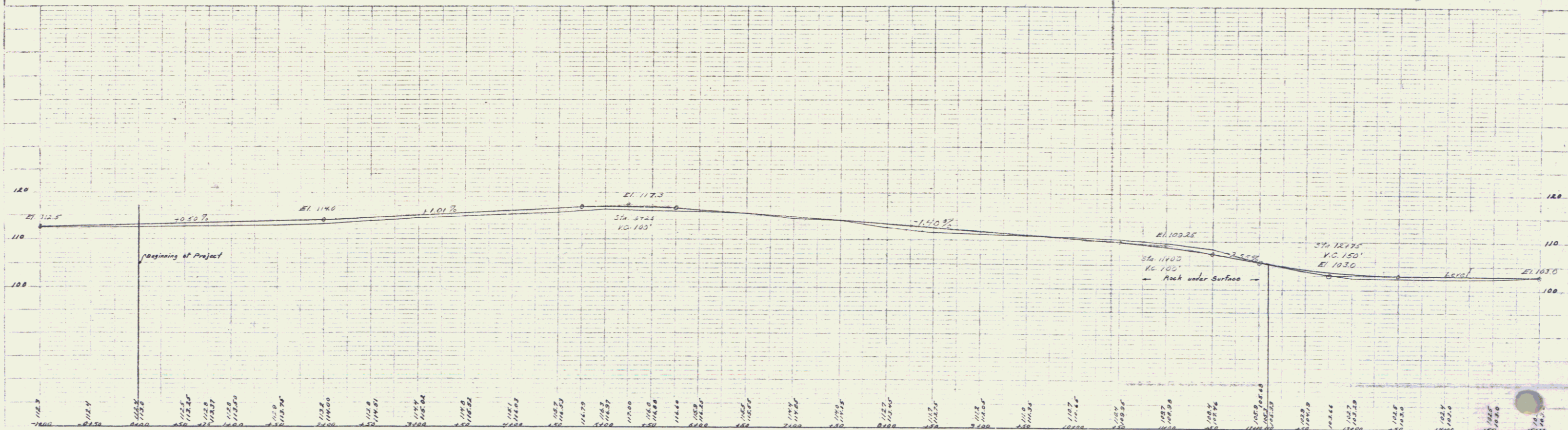
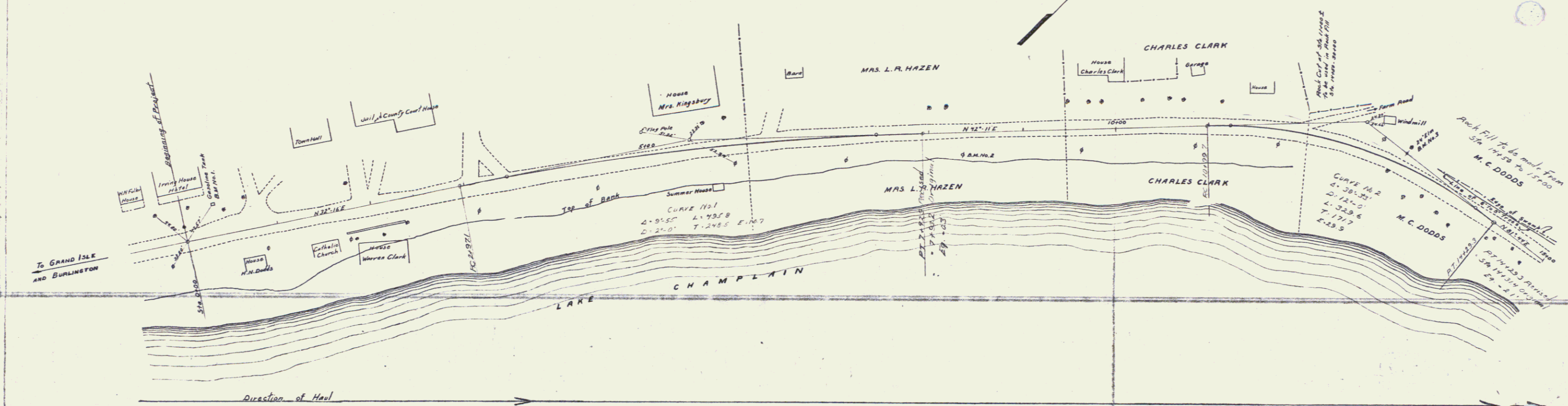

B.M. No. 1 N.E. Corner of Gasoline Tank Foundation Left Sta. 0+41 Elev. 115.29  
 B.M. No. 2 Spike in Telephone Pole Right Sta. 0+36 Elev. 111.95  
 B.M. No. 3 Spike in 24 Elm Left Sta. 13+46 Elev. 103.43

Sheet 3 of 10  
 Series R. No. 110

2