

INDEX OF SHEETS

SHEET NO	TITLE PAGE
2	TYPICAL CROSS-SECTION OF IMPROVEMENT
3	PLAN AND PROFILE STA. 0+00 TO STA 15+00
4	15+00 - 30+00
5	30+00 - 45+00
6	45+00 - 59+00
7	59+00 - 73+00
8	73+00 - 82+85.8
9 TO 18	CROSS SECTIONS

FED. ROAD DIST. NO.	STATE	FED. AID PROJ. NO.	FISCAL YEAR	SHEET NO.	TOTAL SHEETS
3	VT.			1	18

STATE OF VERMONT  
 STATE HIGHWAY DEPARTMENT  
 PLAN AND PROFILE OF PROPOSED  
 STATE HIGHWAY  
 FEDERAL AID PROJECT *Pin # 99K074*  
**TOWN OF NORTH HERO**  
 CITY BEACH ROAD *Rt. No. U.S. 2*  
 FROM "IRVING HOUSE" 8276.5 FEET NORTHERLY



(To Be Returned To R.O.M. Division)  
 Town of North Hero  
 PERPETUAL  
 TOWN FILE  
 RIGHT-OF-WAY DIVISION

PLAN 1 IN. = 50 FEET  
 PROFILE 1/8 IN. = 50 FEET VERT 1 IN. = 10 FEET  
 CROSS SECTIONS 1 IN. = 5 FEET

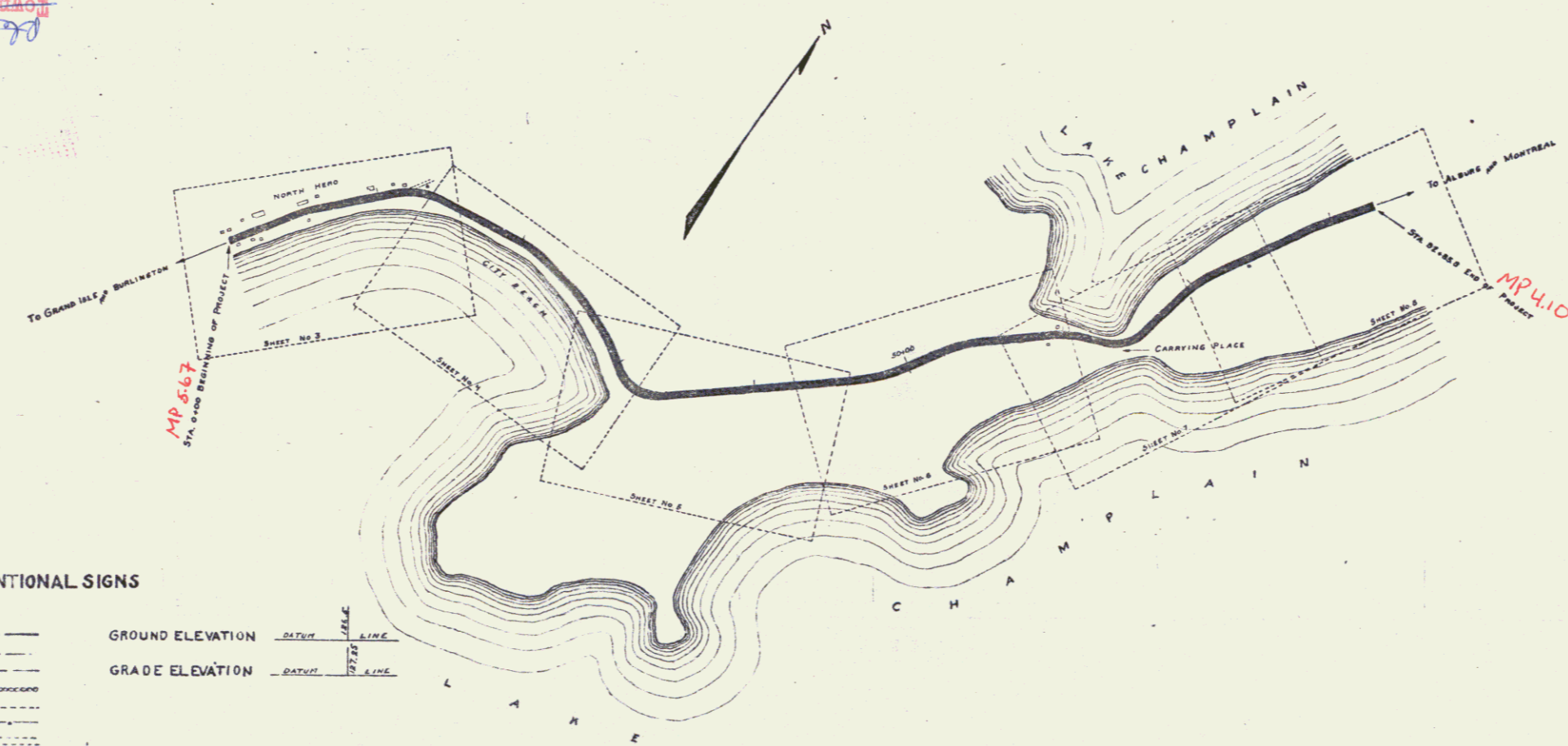

- CONVENTIONAL SIGNS
- COUNTY LINE
  - TOWN LINE
  - FENCE LINE
  - STONE WALL
  - UNFENCED PROPERTY
  - GUARD RAIL
  - TRAVELED WAY
  - RAILROAD
  - RETAINING WALL
  - CENTER & SURVEY LINE
  - CULVERT
  - DROP INLET
  - TROLLEY POLE
  - POWER POLE
  - TELEPHONE POLE
  - TREES
  - HEDGE

GROUND ELEVATION  $\frac{RATIO}{SCALE}$  LINE

GRADE ELEVATION  $\frac{RATIO}{SCALE}$  LINE

CURVE DATA

- DEFLECTION ANGLE  $\Delta$
- DEGREE OF CURVE D.
- RADIUS OF CURVE R.
- TANGENT DISTANCE T.
- LENGTH OF CURVE L.
- EXTERNAL DISTANCE E.
- POINT OF INTERSECTION P. I.
- POINT OF CURVE P. C.
- POINT OF TANGENT P. T.

LAYOUT 1 in. = 500 ft.

RECOMMENDED \_\_\_\_\_  
 STATE ENGINEER

APPROVED \_\_\_\_\_  
 GOVERNOR  
 SUBMITTED BY ORDER OF THE STATE HIGHWAY BOARD

COMMISSIONER OF HIGHWAYS

RECOMMENDED \_\_\_\_\_  
 DISTRICT ENGINEER  
 BUREAU OF PUBLIC ROADS

RECOMMENDED FOR APPROVAL \_\_\_\_\_  
 CHIEF ENGINEER - BUREAU OF PUBLIC ROADS

APPROVED \_\_\_\_\_  
 DIRECTOR - BUREAU OF PUBLIC ROADS

*3/26/1923*  
*Proj: F 118*

Series No. *10*  
 Sheet *10*

*DIST # 8 Plans 1*