

| Parcel | Instrument | Date    | Grantor                 | Grantee | Recorded | Remarks            |
|--------|------------|---------|-------------------------|---------|----------|--------------------|
| A      | Q.C.D.     | 4-22-30 | R.L. Gardner            | Shofvt  | 15 245   | 5-3-38             |
| A'B    | W.O.       | 4-21-30 | A.J. Farrell            | "       | 15 239   | 5-3-38 Cul. 926+50 |
| A'B'C  | Q.C.R.     | 5-26-30 | Jean P. & Mary T. Hones | "       | 15 252   | 6-3-38 " 935+65    |

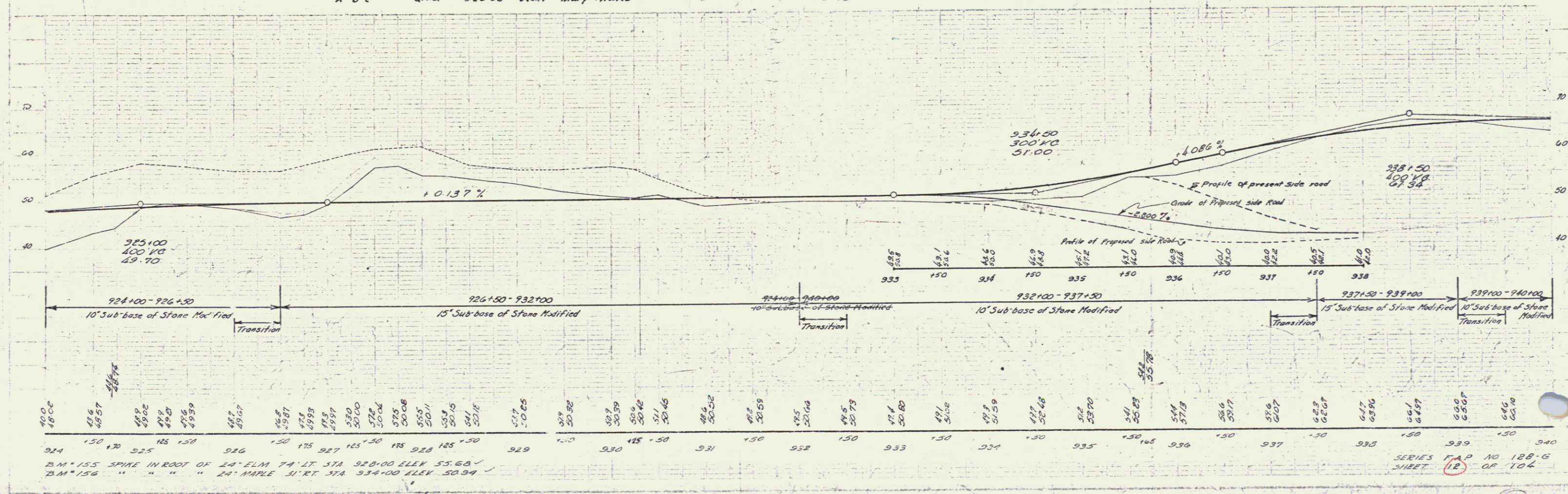

924+100 - 926+100 10' Sub-base of Stone Modified  
 926+100 - 932+100 15' Sub-base of Stone Modified  
 932+100 - 937+100 10' Sub-base of Stone Modified  
 937+100 - 939+100 15' Sub-base of Stone Modified  
 939+100 - 940+100 10' Sub-base of Stone Modified

SERIES F.A.P. NO 128-G  
 SHEET 12 OF 106