

Sta 817+00 to Sta 834+00 - Lt
Trees through this section to be cut removed & disposed of as ordered by the engineer. Payment to be included in the unit bid price for common excavation incl borrow (Item 10-11)

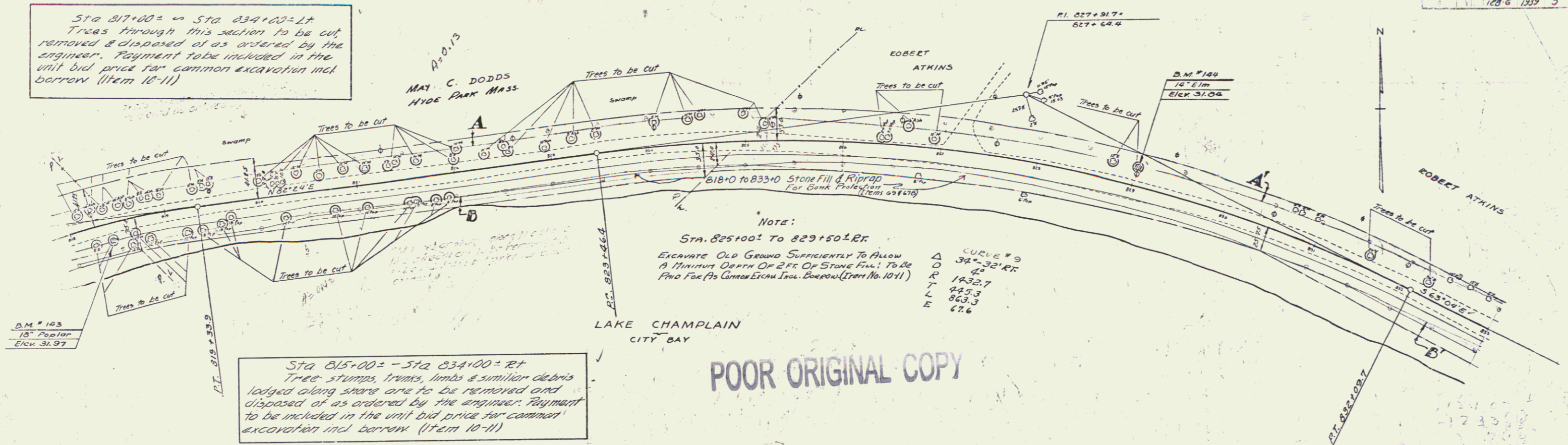

NOTE:
Sta. 825+00 to 829+50 L.Rt
Excavate Old Ground Sufficiently To Allow A Minimum Depth Of 2 Ft. Of Stone Fill; To Be Paid For (To Conform With Spec. Book No. 10-11)

CURVE # 9
D 34'-32" RT
R 42'
T 1432.7
L 825.3
E 626.3

Sta 815+00 to Sta 834+00 - Rt
Tree stumps, trunks, limbs & similar debris lodged along shore are to be removed and disposed of as ordered by the engineer. Payment to be included in the unit bid price for common excavation incl borrow (Item 10-11)

POOR ORIGINAL COPY

PARCEL	INSTRUMENT DATE	GRANTOR	GRANTEE	RECORDED NORTH HERO	REMARKS
A-B	G.C.D. 4-14-38	MAY C. DODDS	ST. OF VT.	BOOK PAGE 410 3-3-38	
A-C	ADM. D. 6-3-38	ROBERTSON'S ESTATE	"	15 254 6-7-38	CUL. 855+00, CHANNEL Rt 867+50

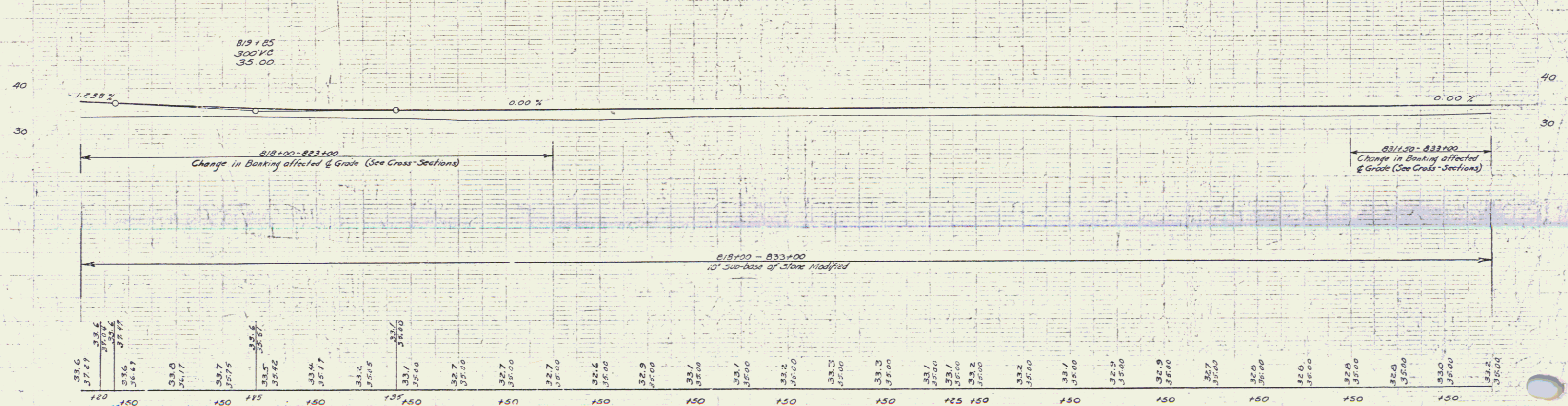

B.M. #123 Spike in root of 18" Poplar 15' Lt Sta 818+30 Elev 31.97
B.M. #144 Spike in root of 14" Elm 15' Lt Sta 829+01 Elev 31.64