

INDEX OF SHEETS

SHEET NO. 1	TITLE PAGE
2-2A	TYPICAL CROSS-SECTION OF IMPROVEMENT - CRUSHED STONE MIXED-IN-PLACE SURFACE COURSE
3	BANKING AND WIDENING TABLES
4-24	PLAN AND PROFILE STA. 813+00 - 1097+68
25	STANDARD STRUCTURE SHEET S 28 PIPE CULVERTS
26	
27	OMITTED
29	
30	S 30 GUARD RAIL
31	S 30 A BOUNDARY & F.A. MARKERS
32	S 31 DROP INLET GRATES
33	S 40 BARRICADE SIGNS & LIGHTS
34	S 41 TYPICAL GRADING CROSS SECTION
35	DETAILS OF CORR. GALV. MULTI-METAL PLATE PIPE STA. 867+50
36-104	EXTENSION TO SLAB BRIDGE STA. 1029+86
37-104	CROSS SECTION SHEETS

STANDARD STRUCTURE SHEETS APPROVED
 BY THE CHIEF ENGINEER
 S 28 JULY 11, 1933
 S 30 AUG. 15, 1933

STATE OF VERMONT
 STATE HIGHWAY DEPARTMENT

PLAN AND PROFILE OF PROPOSED
 STATE HIGHWAY
 FEDERAL AID PROJECT

POOR ORIGINAL COPY

TOWN OF NORTH HERO
 GRAND ISLE - ALBURG ROAD

Pin # 992073

These layouts have been corrected to correspond with the Road Plans.

BEGINNING AT A POINT 0.710 MILES NORTH OF THE STATE AID ROAD TO NORTH HERO STATION AND EXTENDING NORTHERLY 5.385 MILES TO THE NORTH HERO - ALBURG BRIDGE

LENGTH OF GOVERNMENT PARTICIPATION 27,768.8 FT. = 5.259 MILES
 LENGTH OF NON-GOVERNMENT PARTICIPATION 6680 " = 0.126 "
 TOTAL LENGTH OF PROJECT 28,436.8 " = 5.385 "

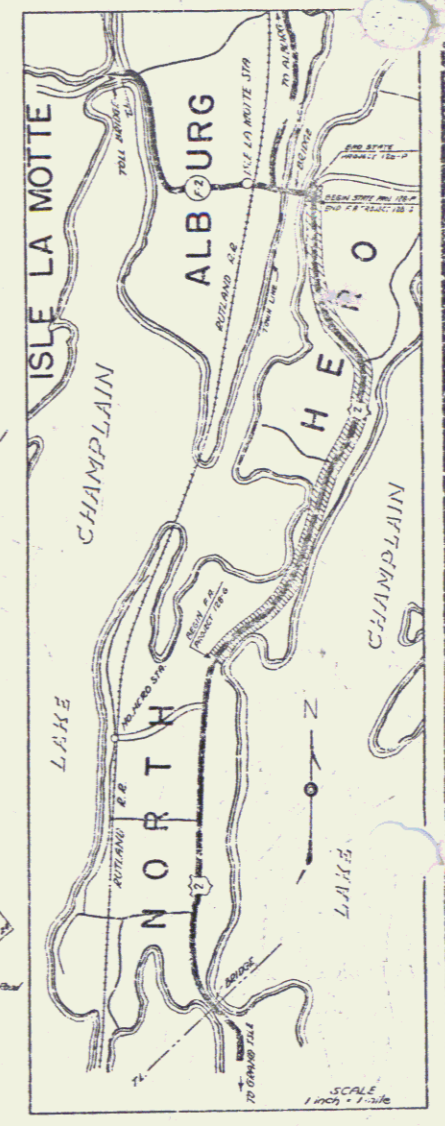
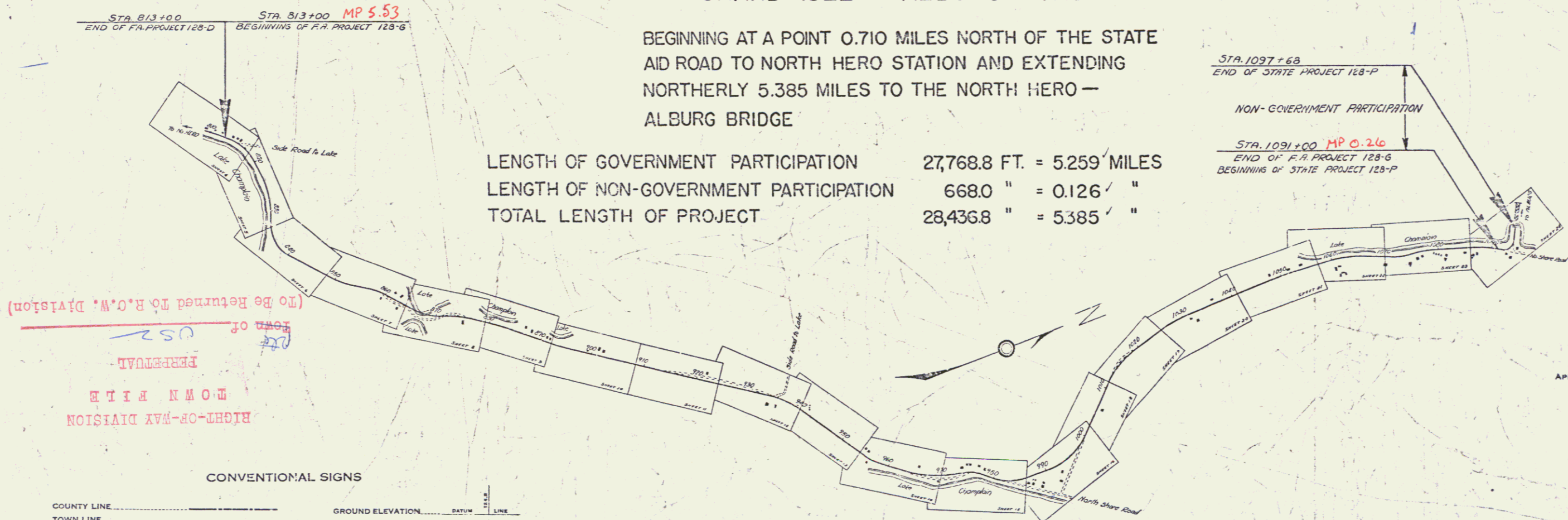

(To be returned to R.O.M. Division)
 TOWN OF NORTH HERO
 RIGHT-OF-WAY DIVISION

CONVENTIONAL SIGNS

COUNTY LINE	GROUND ELEVATION
TOWN LINE	FENCE LINE
STONE WALL	UNFENCED PROPERTY
GUARD RAIL	TRAVELLED WAY
RAILROAD	RETAINING WALL
CENTER LINE	SURVEY LINE
CULVERT	DROP INLET
TROLLEY POLE	POWER POLE
TELEPHONE POLE	TRACES
HEDGE	

CURVE DATA

DEFLECTION ANGLE	DEGREE OF CURVE
RADIUS OF CURVE	TANGENT DISTANCE
LENGTH OF CURVE	EXTERNAL DISTANCE
POINT OF INTERSECTION	POINT OF CURVE
POINT OF TANGENT	POINT ON TANGENT

SCALES

TITLE	1" = 1000'
TYPICAL	1" = 50'
PLAN	1" = 50'
PROFILE	1" = 20'
CROSS-SECTIONS	1" = 1'

These plans are subject to such revisions as may be required by the Bureau of Public Roads or the Commission of Highways. Construction is to be carried on in accordance with the plans and Standard Road and Bridge Specifications of 1933, including all subsequent approved revisions and such revised specifications and special provisions as are submitted with the plans.

APPROVED: April 15, 1938
 [Signature]
 CHIEF ENGINEER OF HIGHWAYS
 SUBMITTED BY ORDER OF THE STATE HIGHWAY BOARD

RECOMMENDED [Signature]
 RECOMMENDED FOR APPROVAL [Signature]
 APPROVED [Signature]

Project No. F.A.P. 128-G
 SERIES F.A.P. NO. 128-G FILED
 SHEET 1 OF 104

STEARNS R. JENKINS
 Rte # US 2