

SUB BASE OF SAND, ITEM 202  
 NB 2979+00 - 2983+00  
 SB 2983+00 - 2985+00  
 SB 2985+00 - 2989+00  
 SB 2989+00 - 2993+00  
 JUTE MATTING, ITEM 623  
 NB 2991+50 - 2993+50 Df.

SELECTIVE THINNING & TRIMMING  
 ITEM 601  
 SB 2979+00 Df - 2985+00 Df  
 SB 2979+00 Df - 2989+100 Df  
 NB 2979+00 Df - 2983+50 Df.

\* TREATED TIMBER CURB, ITEM 505  
 NB 2979+00' - 2983+00 Df  
 SB 2981 - 75 - 2983+00 Df  
 SB 2990+00 - 2991+50 Df.

PROPERTY LINE FENCE  
 ITEM 505-II, Mod.  
 SB 2979+00' - 2983+00 Df  
 NB 2979+00' - 2993+00 Df

\* THREE CABLE GUARD RAIL W/ LIGHT  
 STEEL POSTS, ITEM 533  
 NB 2973+00' - 2984+00 Df  
 NB 2980+00' - 2981+50 Df  
 NB 2980+50' - 2985+00 Df  
 SB 2973+00' - 2985+00 Df  
 SB 2989+75 - 2992+50 Df.  
 \* STAGE 2 CONSTRUCTION

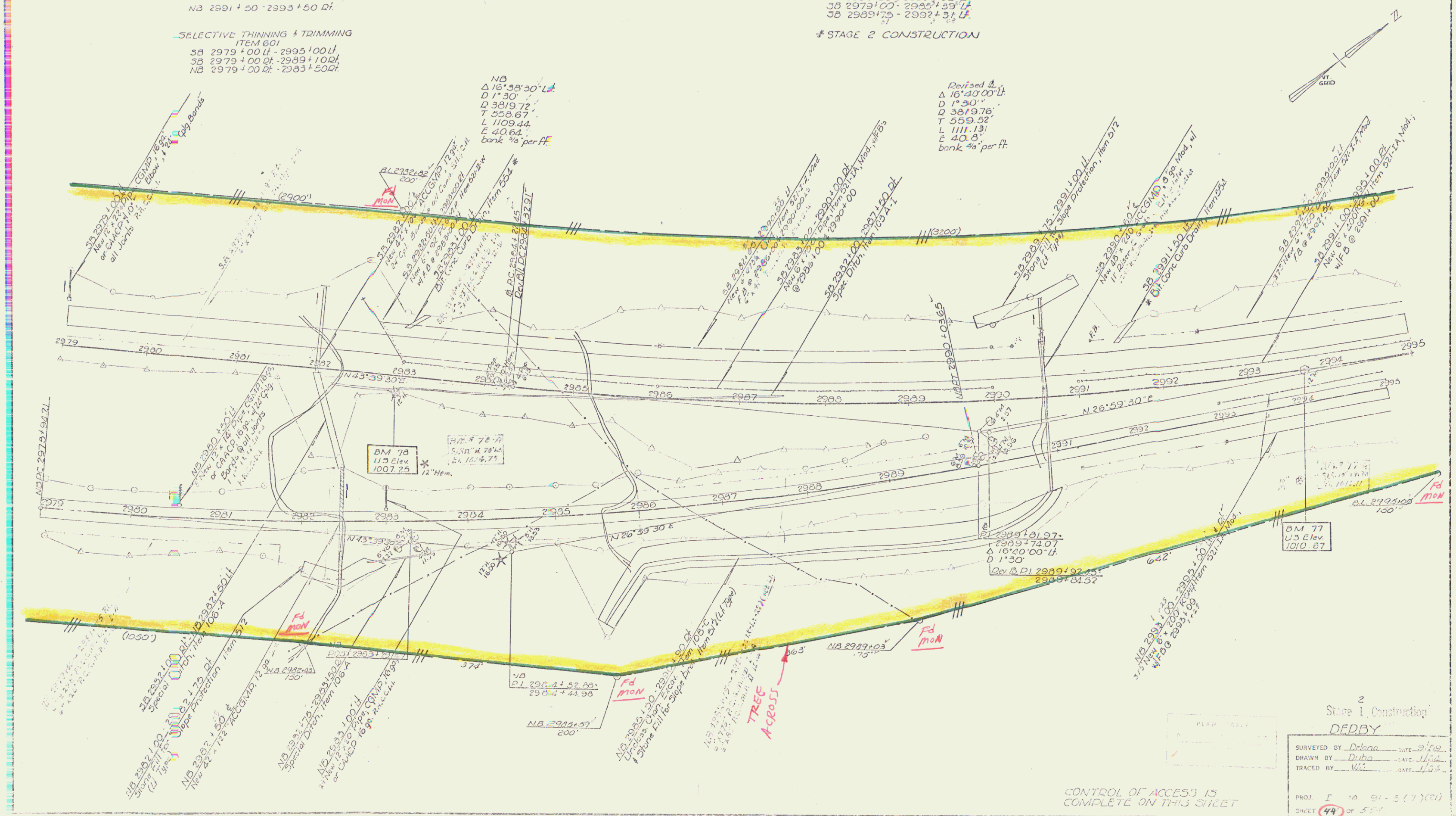

Revised Δ  
 Δ 10° 40' 00" E  
 D 1' 30"  
 D 3819.78'  
 T 558.52'  
 L 1111.13'  
 E 40.8'  
 bank 3/4" per ft.

2  
 Stage 1 Construction  
 DERBY

SURVEYED BY Duba DATE 9/84  
 DRAWN BY Duba DATE 11/84  
 TRACED BY WJ DATE 1/84

PROJ. I NO. 91-5(1)(91)  
 SHEET 44 OF 504  
 223

CONTROL OF ACCESS IS  
 COMPLETE ON THIS SHEET

JUL 11 1974  
 Raw  
 27  
 CONST