

JUTE MATTING
ITEM 623
SB 2940+50 - 2942+55.11

SELECTIVE THINNING
AND TRIMMING
ITEM 601
SB 2937+00.4 - 2938+50.4
SB 2937+00.4 - 2947+00.4
SB 2937+00.4 - 2947+00.4
NB 2937+00.4 - 2947+00.4

*THREE CABLE GUARD RAIL W/ # Treated
LIGHT STEEL POSTS, ITEM 553
NB 2931+00 - 2939+00
NB 2931+00 - 2946+00
NB 2931+00 - 2946+00
SB 2931+00 - 2946+00
SB 2942+25 - 2947+00.11

*STANDARD STEEL BEAM
CURVED 12" W/ STEEL POSTS
ITEM 554 (5' x 3" x 1/2")
NB 2938+21 - 2947+00.11

PROPERTY LINE FENCE
ITEM 583-II
SB 2931+00 - 2947+00.11
NB 2931+00 - 2947+00.11
SB 2931+00 - 2947+00.11
SB 2931+00 - 2947+00.11

*STAGE 2 CONSTRUCTION

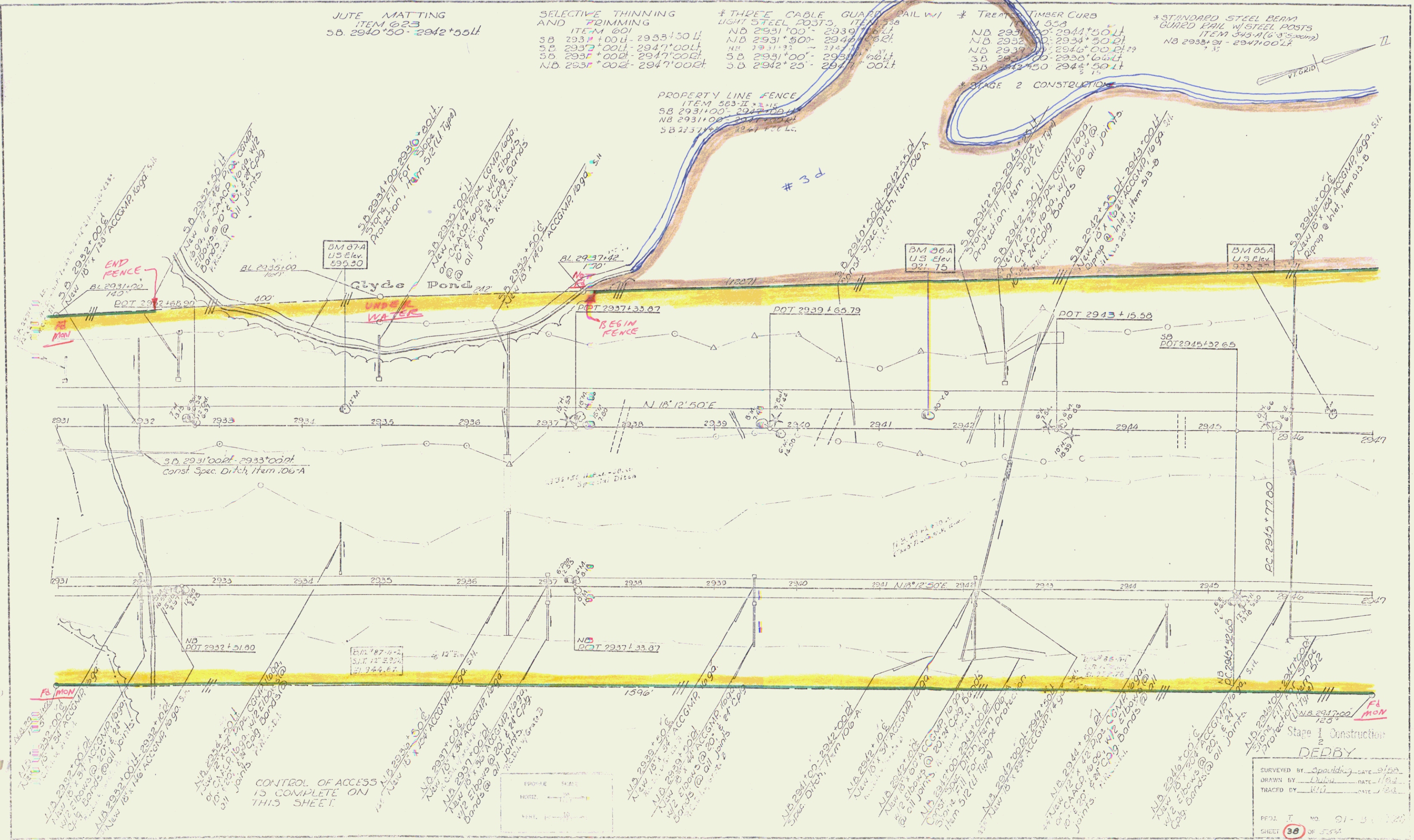

CONTROL OF ACCESS
IS COMPLETE ON
THIS SHEET

DEBRY
SURVEYED BY Spaulding DATE 5/29/74
DRAWN BY Duhon DATE 1/6/74
TRACED BY (initials) DATE 1/6/74
PROJECT NO. 91-3 (120)
SHEET 38 OF 53
40 253

CONST F.R.O.W

JUL 11 1974 24