

SITE PLAN
SCALE 1" = 20 FT.

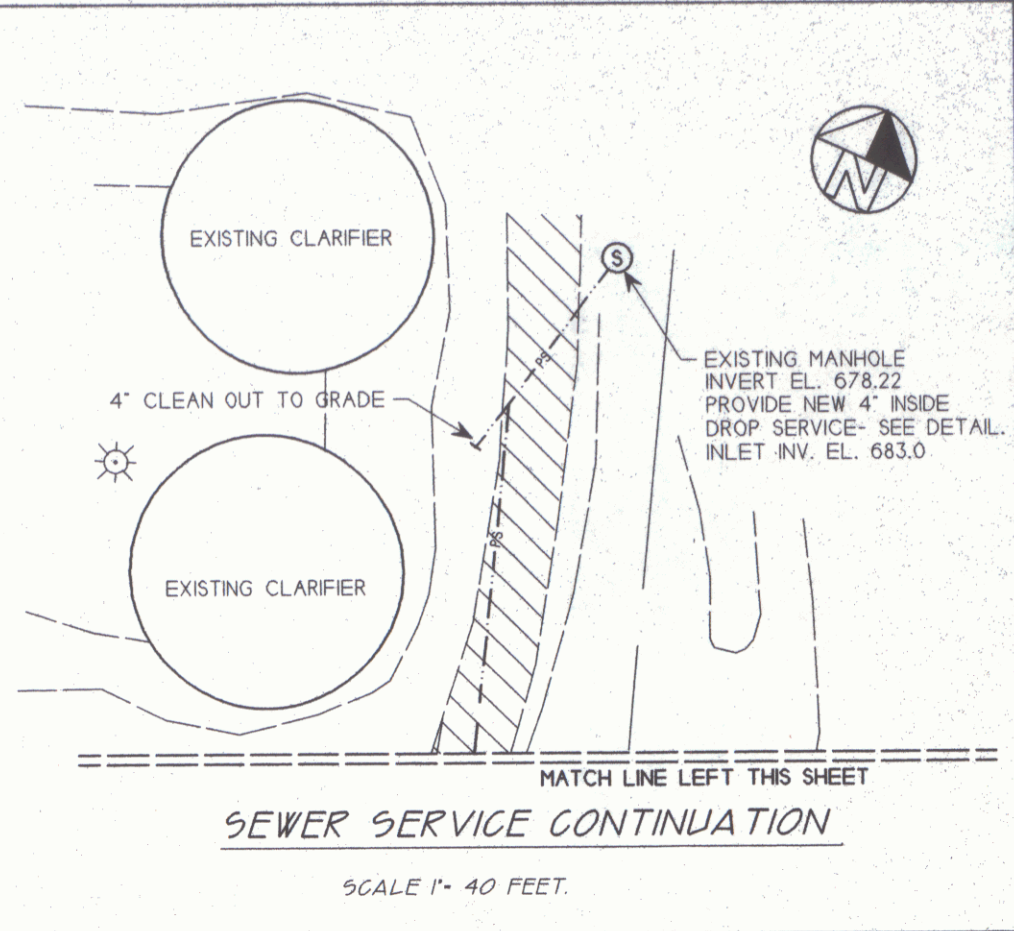

SEWER SERVICE CONTINUATION

SCALE 1" = 40 FEET.

GENERAL SITE NOTES:

1. ALL NEW SEWER AND WATER SERVICES AND MAINS SHALL BE PRESSURE AND LEAKAGE TESTED IN ACCORDANCE WITH THE LATEST EDITION OF THE VERMONT ENVIRONMENTAL PROTECTION RULES, EFFECTIVE AUG. 8, 1996. ALL WATER MAINS SHALL BE DISINFECTED IN ACCORDANCE WITH ANWA 603 AND RELATED STANDARDS. CONTACT THE ENGINEER 48 HOURS IN ADVANCE OF ALL SUCH TESTING. DO NOT TERMINATE ANY PRESSURE TESTING WITHOUT APPROVAL OF THE ENGINEER.
2. UTILIZE EXISTING GRANULAR MATERIAL ON-SITE TO COMPLETE GRADING AS NECESSARY. COMPACT ALL PLACED GRANULAR FILL TO 98% STANDARD PROCTOR DENSITY. COMPACT LIFT IN LAYERS AND DENSITY AS PER SPECIFICATIONS.
3. SEE PROJECT SPECIFICATIONS FOR FURTHER INFORMATION REGARDING SITEWORK.
4. ALL EXTERIOR EARTHWORK INCLUDING TOPSOIL, SEEDING, GRAVEL AND PAVED SURFACES SHALL BE BY THE OWNER.
5. EXTERIOR SEWER AND WATER UTILITIES FROM 5' OUTSIDE THE BUILDING SHALL BE BY THE OWNER. EXTERIOR POWER, TEL. CATV BY CONTRACTOR.
6. THE CONTRACTOR SHALL BE RESPONSIBLE FOR ALL INTERIOR EARTHWORK AND BURIED UTILITY WORK INCLUDING ALL TEMPORARY INTERIOR AND EXTERIOR SERVICES SHALL BE BY THE CONTRACTOR.
7. ALL LANDSCAPING PLACED WITHIN THE HIGHWAY RIGHT-OF-WAY SHALL HAVE A MATURE GROWTH HEIGHT OF 2 FT. OR LESS.
8. THE OWNER SHALL MODIFY THE TRAFFIC SIGNAL AT THE INTERSECTION FOR FIRE PREEMPTED PHASE AS APPROVED BY THE AGENCY OF TRANSPORTATION.
9. THE OWNER SHALL RELOCATE AND REPLACE THE RIGHT-OF-WAY FENCE LOCATED ON THE EASTERLY PROPERTY LINE AS APPROVED BY THE AOT.
10. THE CONTRACTOR SHALL INSTALL 4 AREA HIGHWAY DIRECTIONAL SIGNS AS DIRECTED PER ALLOWANCE. THE CONTRACTOR SHALL ALSO INSTALL A REMOTE CONTROLLED STREET LIGHT PREEMPTION SYSTEM AS DIRECTED PER ALLOWANCE.

SITE LEGEND

— S —	EXISTING SEWER	— X —	EXISTING R.O.W. FENCE
— PS —	PROPOSED SEWER SERVICE	•	ORIGINAL CONCRETE MONUMENT
▨	AREA TO RECEIVE PAVEMENT	⊙	PROPERTY LINE
⊙	FLAG POLE LOCATIONS	⊙	EXISTING HYDRANT
⊙	EXISTING UTILITY POLE	— W —	EXISTING 8" WATERMAIN
		⊙	EXISTING SEWER MANHOLE



David A. Lawes
Engineering, Inc.
P.O. BOX 448
DARBY, VERMONT



REVIEWS & REVISIONS

PROPOSED
NEW FIRE STATION
CLYDE STREET - NEWPORT, VERMONT

SITE GRADING AND
UTILITY PLAN

DATE 3/4/98
BY DAL

C-1

SHEET 12B