

NOTE: BROWN LINES NOT CHECKED
BLACK LINES CHECKED

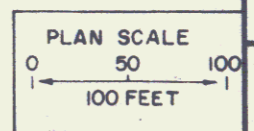
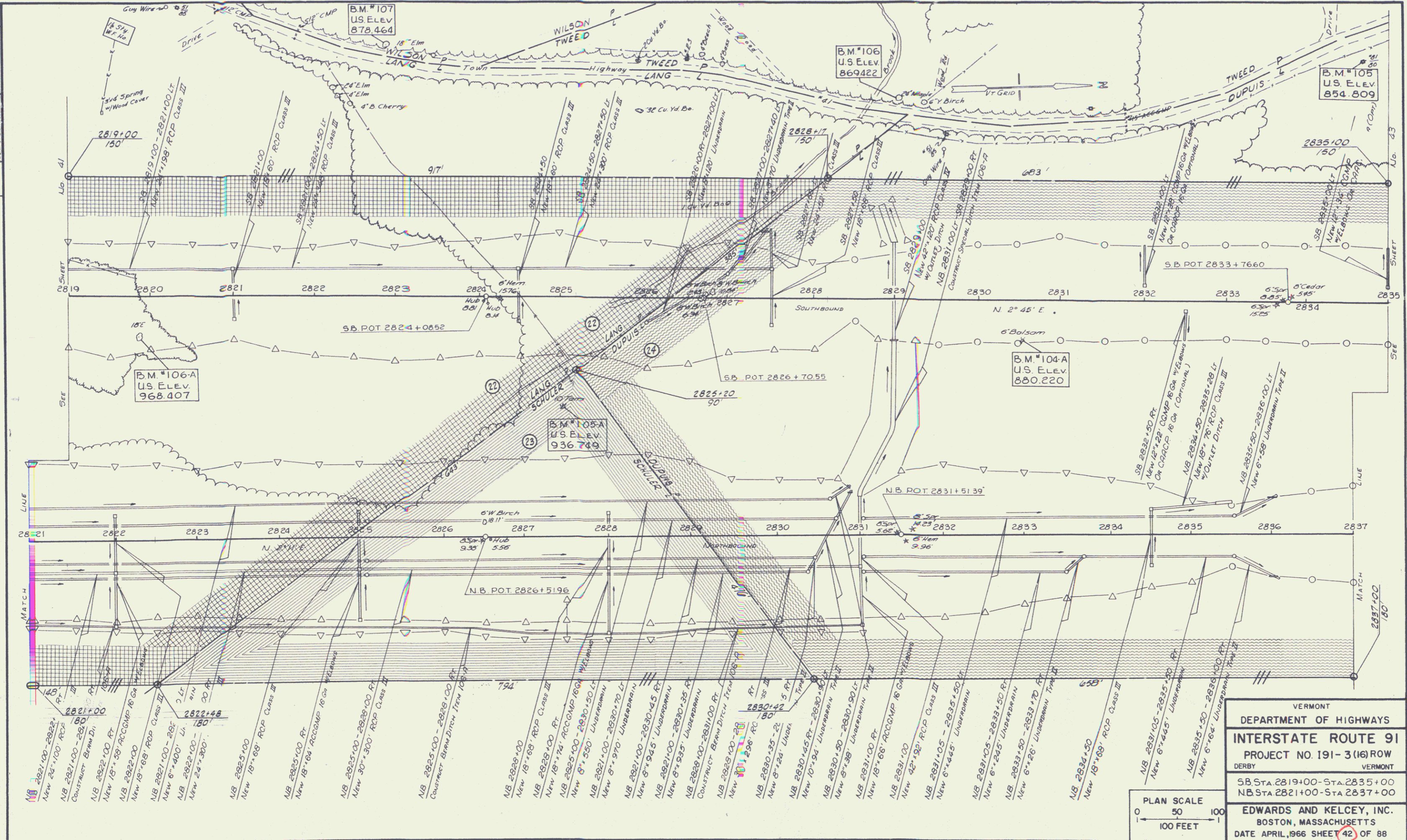

VERMONT
DEPARTMENT OF HIGHWAYS
INTERSTATE ROUTE 91
PROJECT NO. 191-3(16) ROW
DERBY VERMONT
SB STA. 2819+00 - STA. 2835+00
NB STA. 2821+00 - STA. 2837+00
EDWARDS AND KELCEY, INC.
BOSTON, MASSACHUSETTS
DATE APRIL, 1966 SHEET 42 OF 88