

PLAN
 18" = 100'
 NOTE BOOKED
 ALIGN. CHECKED
 NO. FOR CHECKED

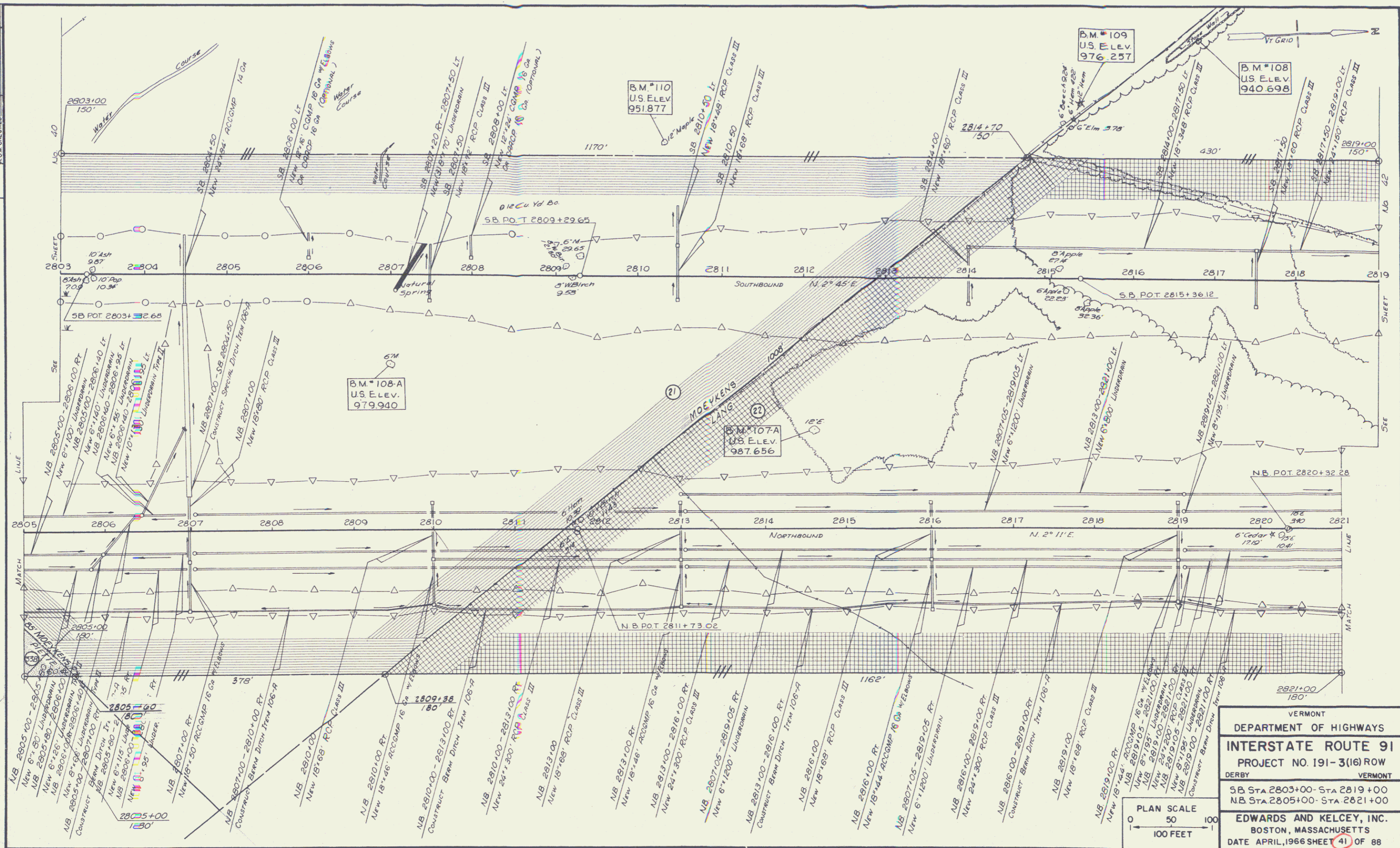

| | |
|---------------------------------|---------|
| VERMONT | |
| DEPARTMENT OF HIGHWAYS | |
| INTERSTATE ROUTE 91 | |
| PROJECT NO. 191-3(16) ROW | |
| DERBY | VERMONT |
| 5B STA 2803+00 - STA 2819+00 | |
| NB STA 2805+00 - STA 2821+00 | |
| EDWARDS AND KELCEY, INC. | |
| BOSTON, MASSACHUSETTS | |
| DATE APRIL, 1966 SHEET 41 OF 88 | |

