

ROW MATCH SEE SHEET No. 35

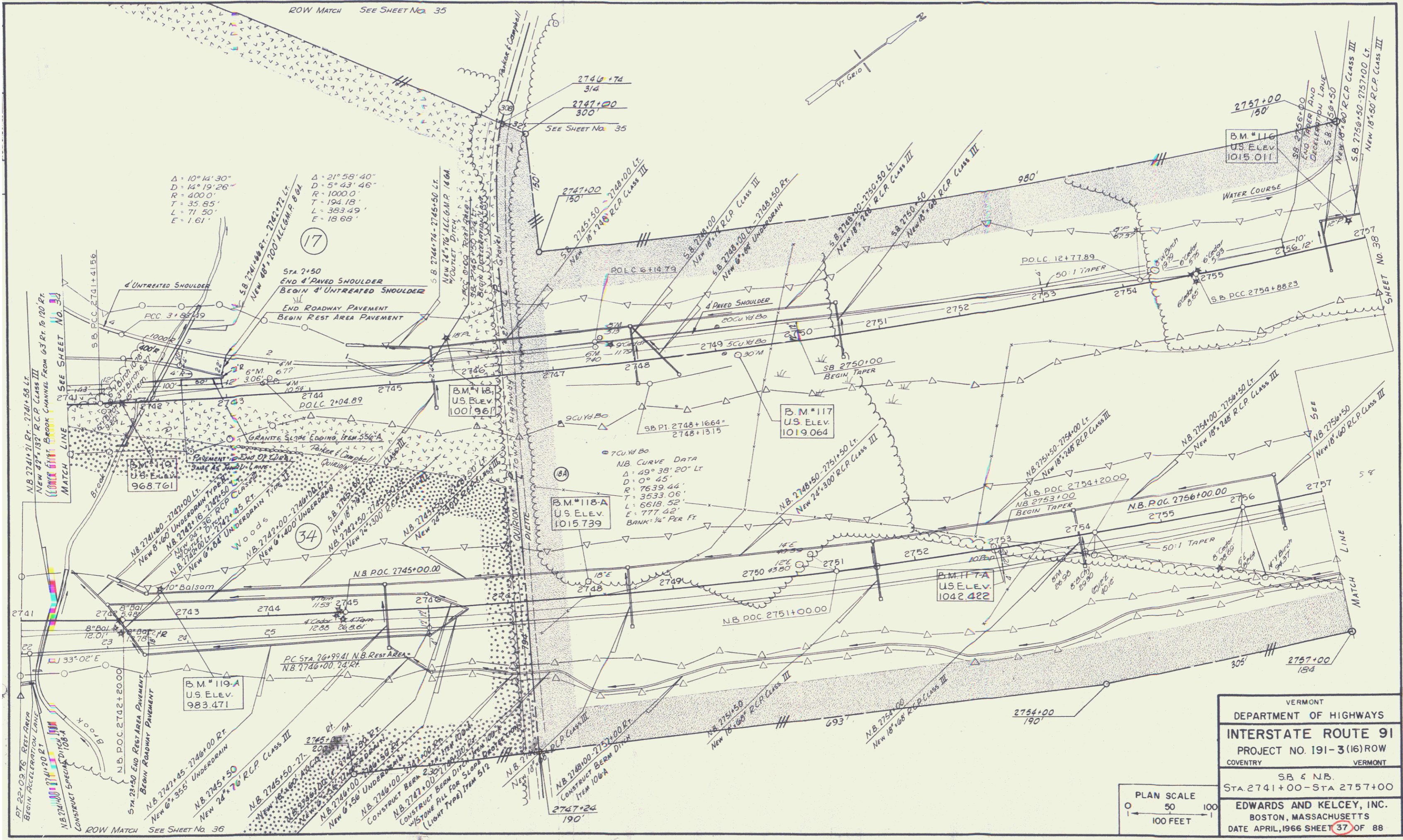

VERMONT  
 DEPARTMENT OF HIGHWAYS  
**INTERSTATE ROUTE 91**  
 PROJECT NO. 191-3(16) ROW  
 COUNTY VERMONT  
 SB & NB.  
 STA 2741+00 - STA 2757+00  
**EDWARDS AND KELCEY, INC.**  
 BOSTON, MASSACHUSETTS  
 DATE APRIL, 1966 SHEET 37 OF 88

