

NOTE: B.O. LOCATION NOT CHECKED
 NO. 10.0 M. CHECKED

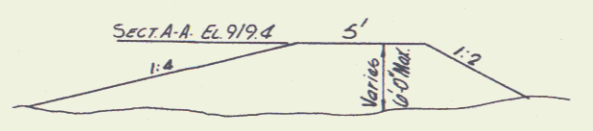
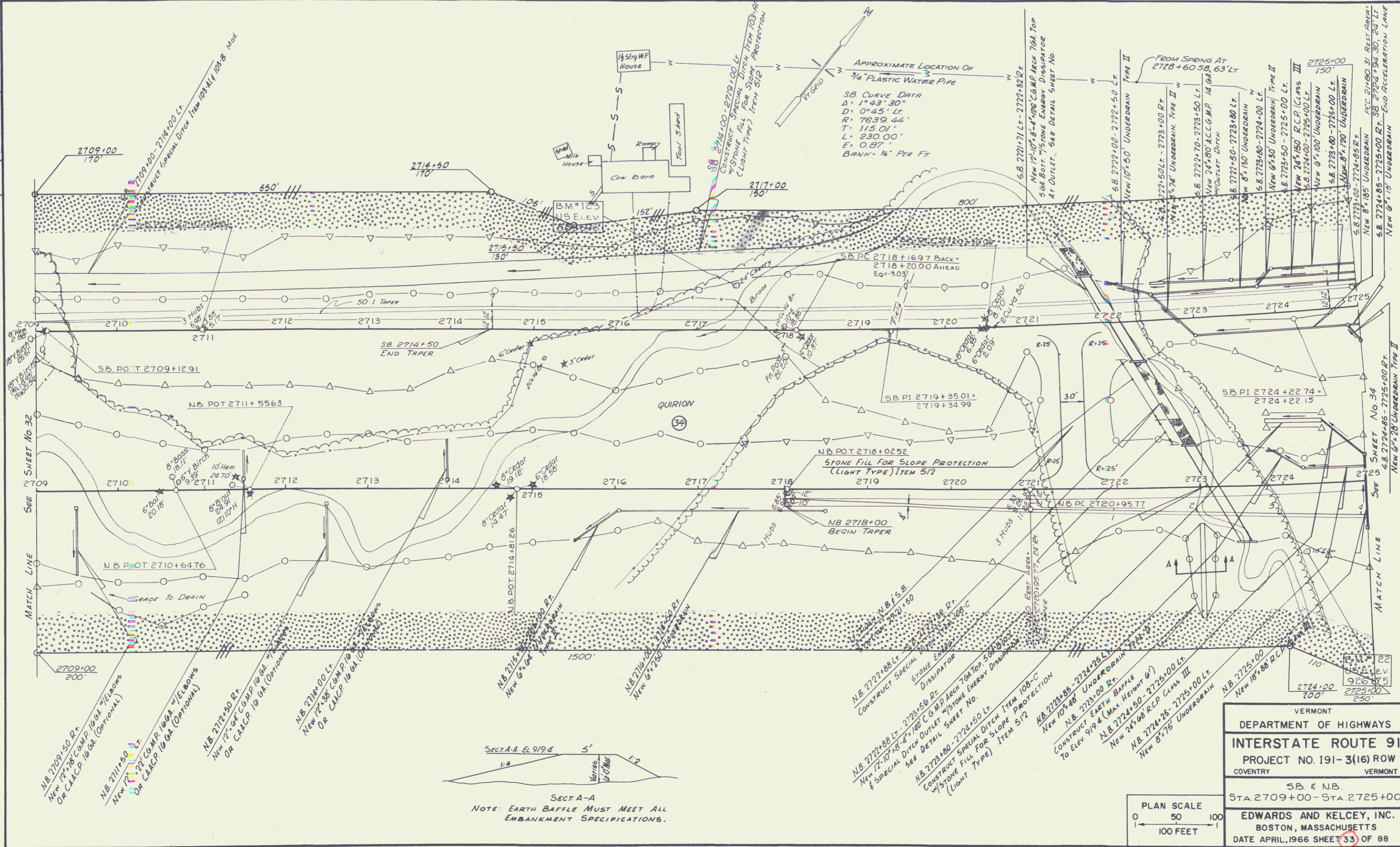

SECT A-A
 NOTE: EARTH BAFFLE MUST MEET ALL EMBANKMENT SPECIFICATIONS.

VERMONT
 DEPARTMENT OF HIGHWAYS
INTERSTATE ROUTE 91
 PROJECT NO. 191-3(16) ROW
 COVENTRY VERMONT

SB & NB.
 STA. 2709+00 - STA. 2725+00

EDWARDS AND KELCEY, INC.
 BOSTON, MASSACHUSETTS
 DATE APRIL, 1966 SHEET 33 OF 88

