

Drilling & Blasting of Solid Rock Subgrade, Item 115
 S.B. 2391+25 - 2406+25
 S.B. 2406+75 - 2407+00
 N.B. 2392+75 - 2400+25

Sub-base of Sand (Item 202)
 S.B. 2404+50 - 2405+50
 S.B. 2391+00 - 2391+25
 N.B. 2400+33 - 2406+00

* TREATED TIMBER CURB
 Item 558
 N.B. 2391+00 - 2392+08+ET

Demolition and Disposal of Buildings, Item 586
 N.B. 2391+25 RT (46.49m)

* Standard Steel Beam Guard Rail w/ Steel Posts, Item 545-A
 N.B. 2400+00 - 2401+54.14 RT
 S.B. 2400+96 - 2402+50.14 RT
 N.B. 2391+00 - 2392+36 RT

Property Line Fence w/ Steel Posts, Item 603-II, Mod.
 N.B. 2391+00 - 2406+00 RT
 S.B. 2391+00 - 2407+00 RT

* STAGE 2 CONSTRUCTION

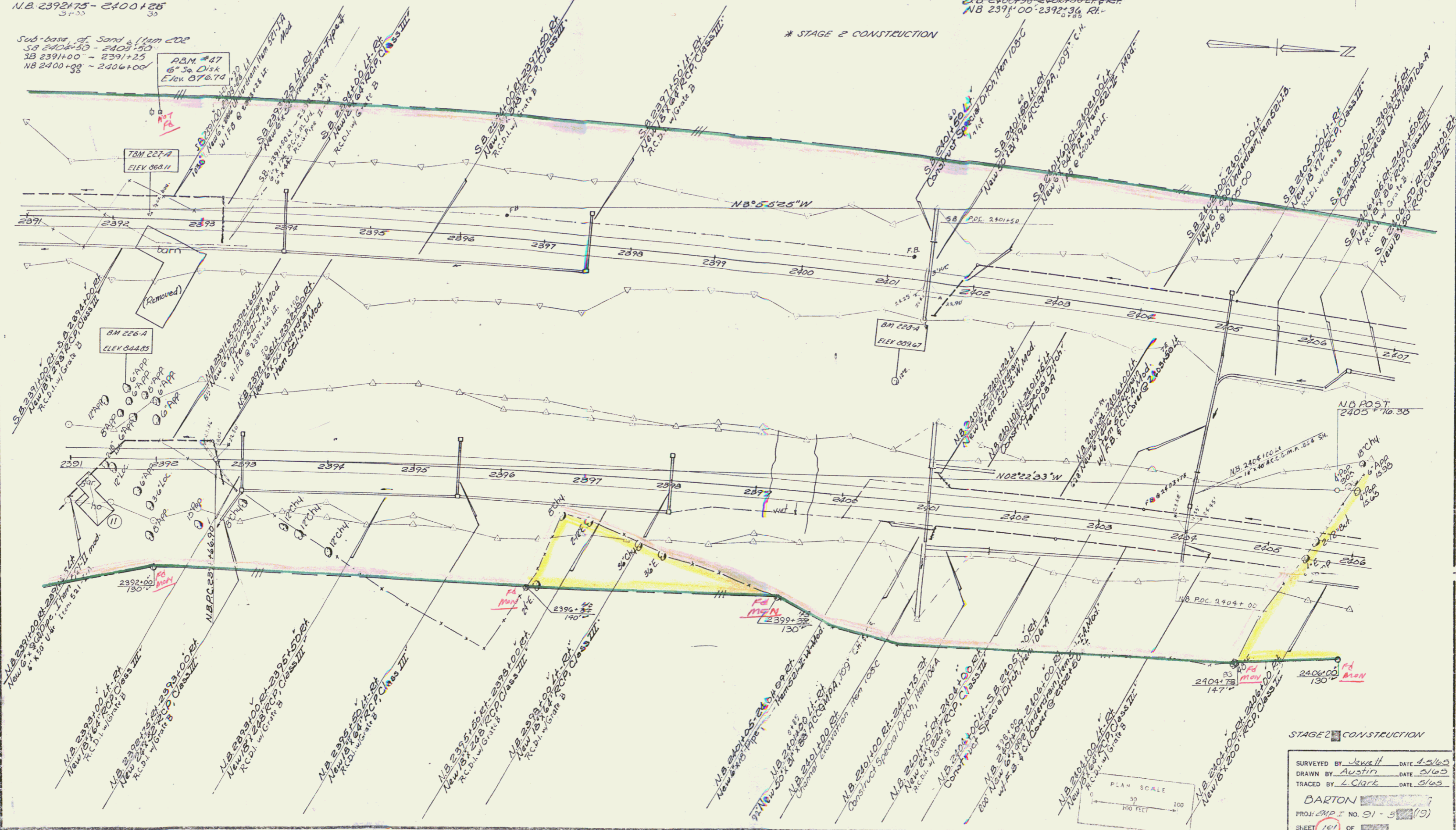

STAGE 2 CONSTRUCTION

SURVEYED BY	Jewell	DATE	4-21-69
DRAWN BY	Austin	DATE	5/1/69
TRACED BY	L. Clark	DATE	5/1/69
BARTON			
PROJ. EMP. NO. 91 - 5 (19)			
SHEET 101 OF 114			

JUL 11 1974