

* Three Cable Guard Rail
 Light Steel Posts, Item 533
 N.B. 2217+00-2222+00 RT

* STAGE 2 CONSTRUCTION

Property Line Fence
 w/ Steel Posts, Item 533-II
 N.B. 2217+00-2233+00 RT
 S.B. 2217+00-2233+00 LT
 To be erected prior to construction
 SB 2217+30 - 2228+40 LT
 TR# 34 43+00 LT ~ NB 2233+100 RT

S.B. Curve Data:
 Δ 135° 20' 35" LT
 D 1° 00'
 R 2817.72
 T 214.52
 L 1022.86
 E 34.62
 Bank 36' per A (0.047)

N.B. Curve Data:
 Δ 135° 13' 43" LT
 D 1° 00'
 R 2729.58
 T 664.28
 L 1322.86
 E 28.89
 Bank 1/4" per A (0.036)

SB-NB 2222+001 - 2229+002
 Stumps & Rubbish to be included in
 the Clearing and Grubbing Item 101
 (See Special Provisions)

Sub-base of Sand, Item 202
 SB 2218+25 - 2220+25
 SB 2224+25 - 2225+00
 NB 2232+50 - 2233+50

July Matting Item 643
 SB 2217+40 ~ 2218+25 LC
 Sod Ditch Item 612
 SB 2220+25 - SB 2221+00 LT

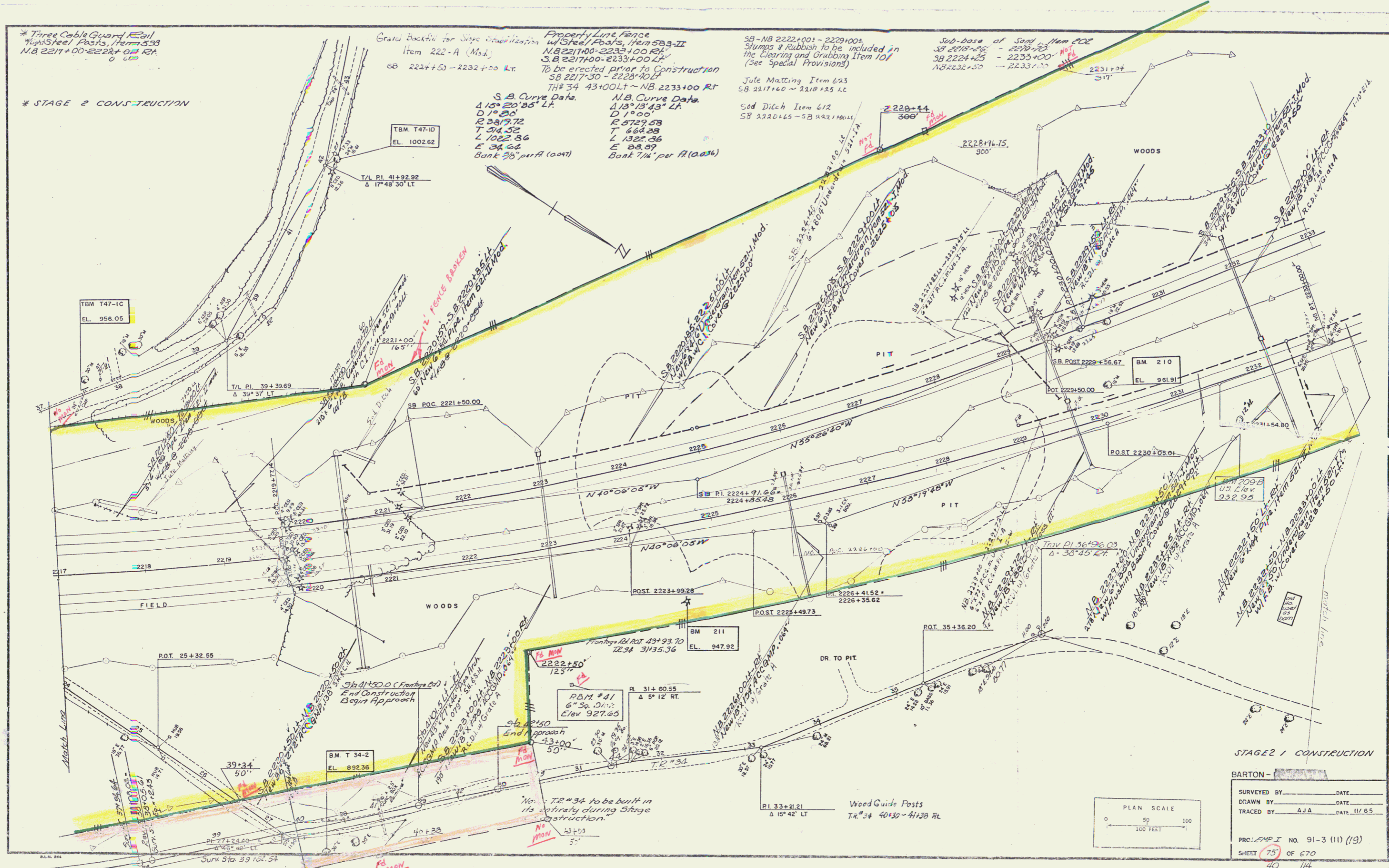

STAGE 1 CONSTRUCTION

BARTON -
 SURVEYED BY _____ DATE _____
 DRAWN BY _____ DATE _____
 TRACED BY AJA DATE 11/65

PRC. EMP I NO. 91-3 (11) (19)
 SHEET 75 OF 670
 40 114

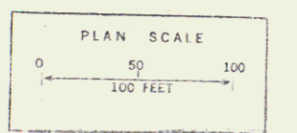

JUL 11 1974